

Montageanleitung für Synthesereaktoren Assembly instructions for Synthesis Reactors

DE Montage des Entleerungsset LT 5.40

EN Assembling the draining set LT 5.40

DE Montage der Schläuche am Entleerungsset LT 5.40

EN Assembling the hoses to the draining set LT 5.40

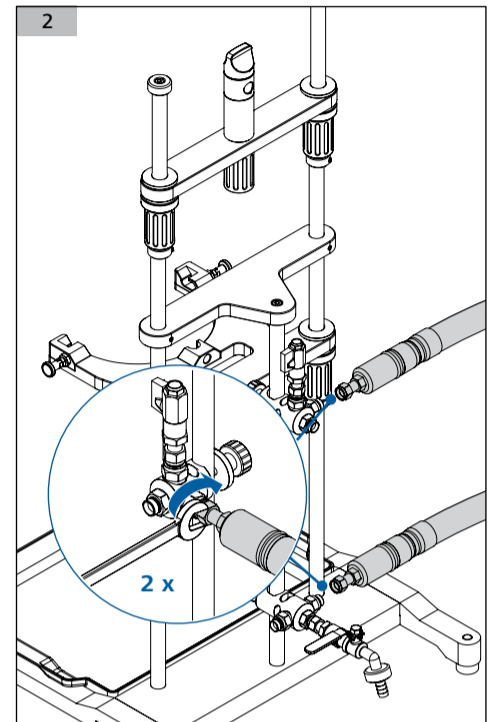
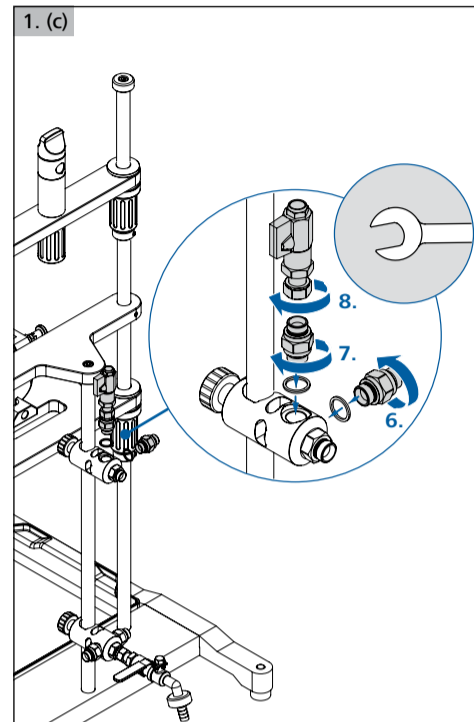
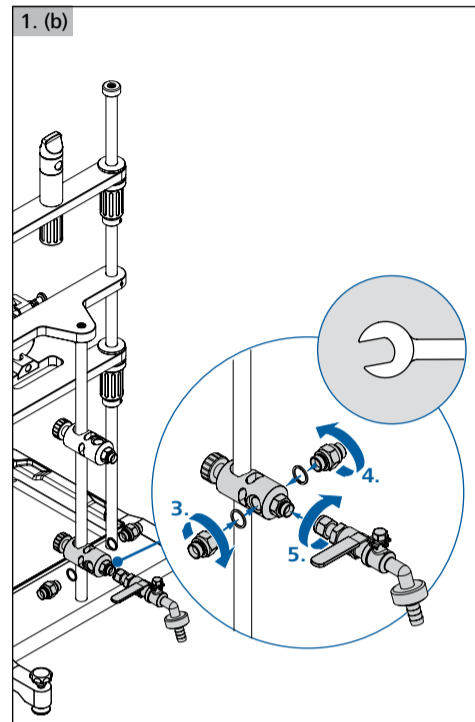
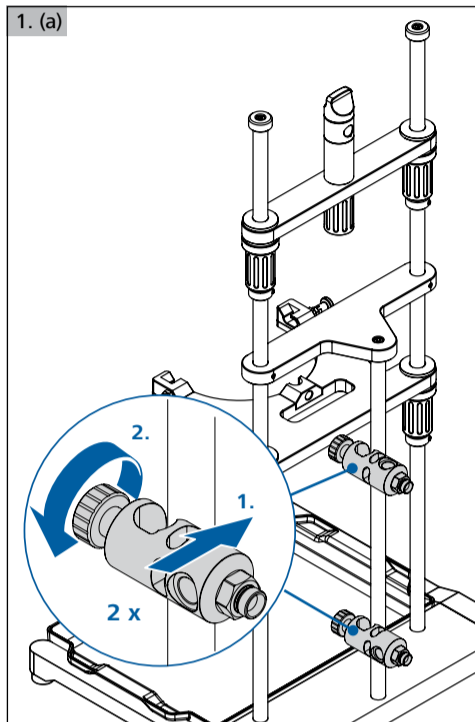

DE Montage der Behälterklemme und des Reaktorgefäß

EN Assembling the vessel clamp and the reactor vessel

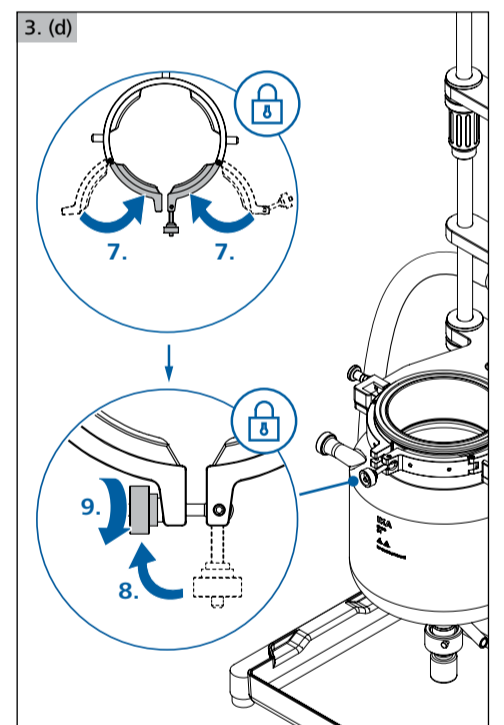
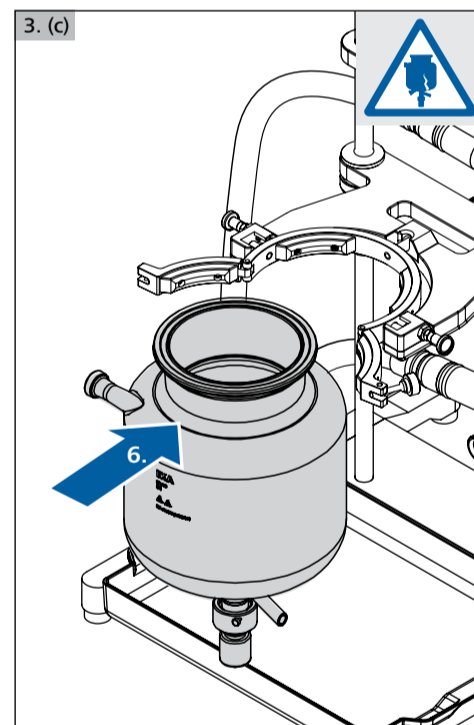
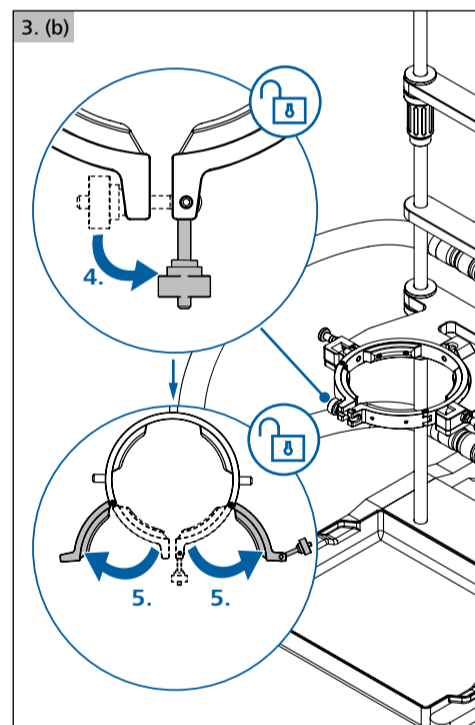
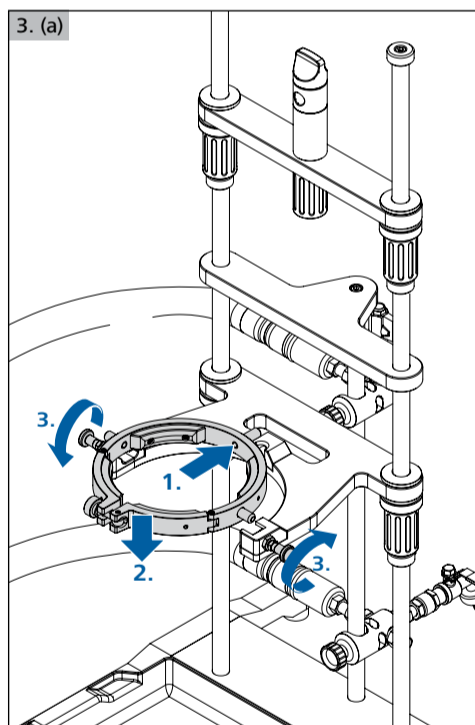

DE Montage der Schlauchadapter am Reaktorgefäß

EN Assembling the hose adapters to reactor vessel

DE Anschluss der Schläuche an das Reaktorgefäß

EN Connecting the hoses to the reactor vessel

DE Füllen des Reaktorgefäß

EN Filling the reactor vessel

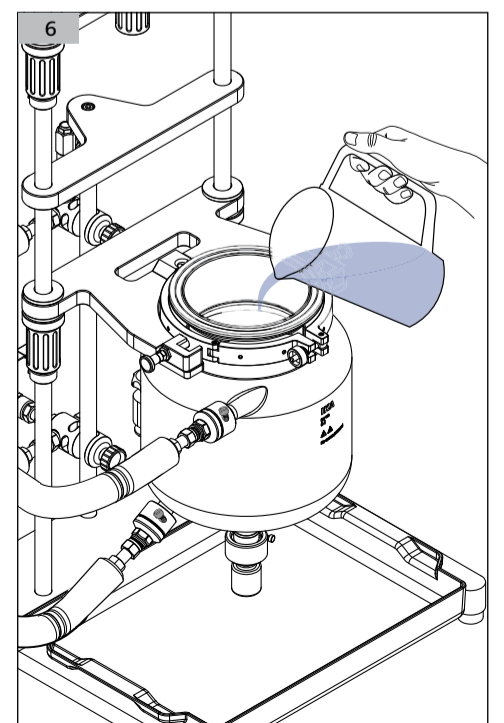
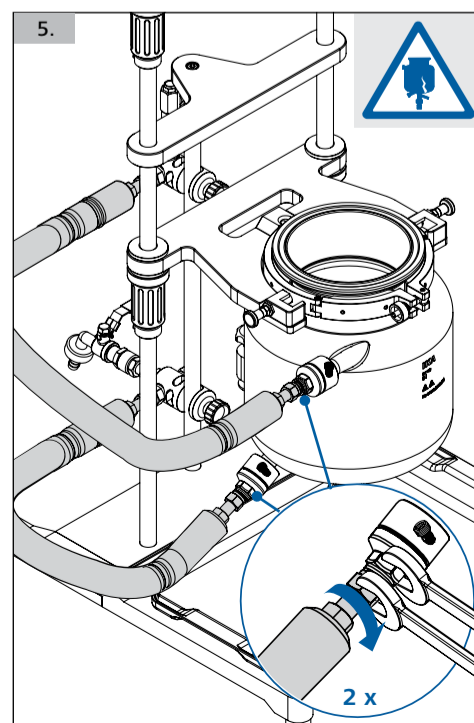
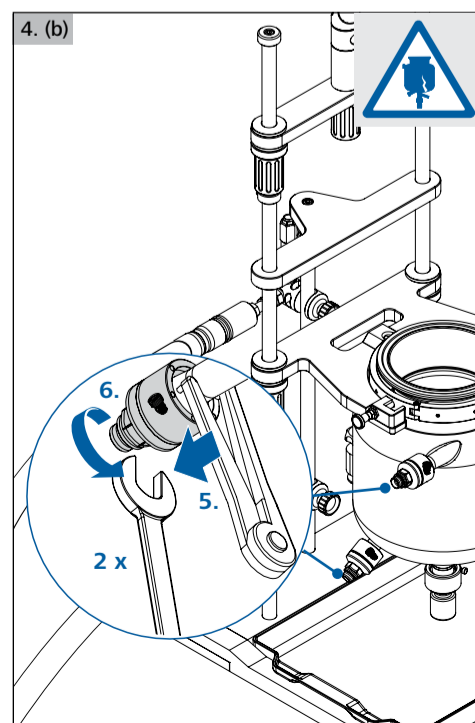
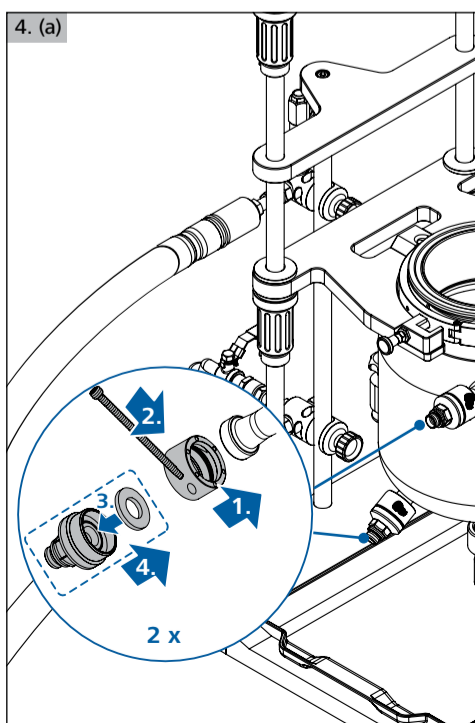

DE Montage des Rührwerkzeugs/der Rührerführung am Reaktordeckel
 EN Assembling the stirring tool/stirrer guide to the reactor lid

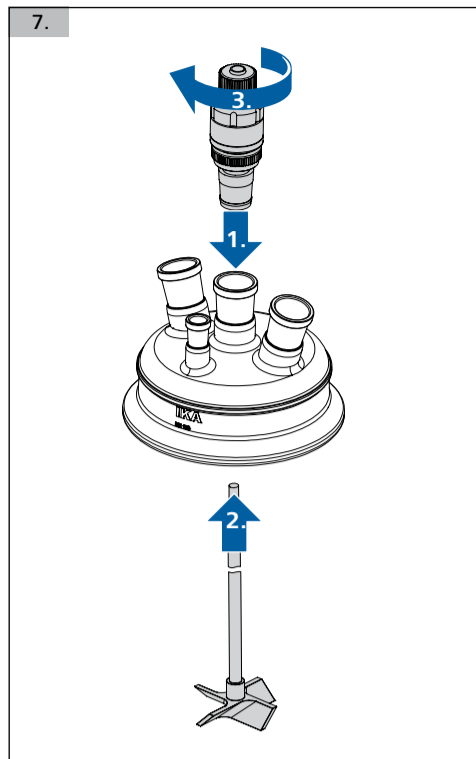

DE Montage des Reaktordeckel, O-Ring und Spannring
 EN Assembling the reactor lid, O-Ring and clamp ring

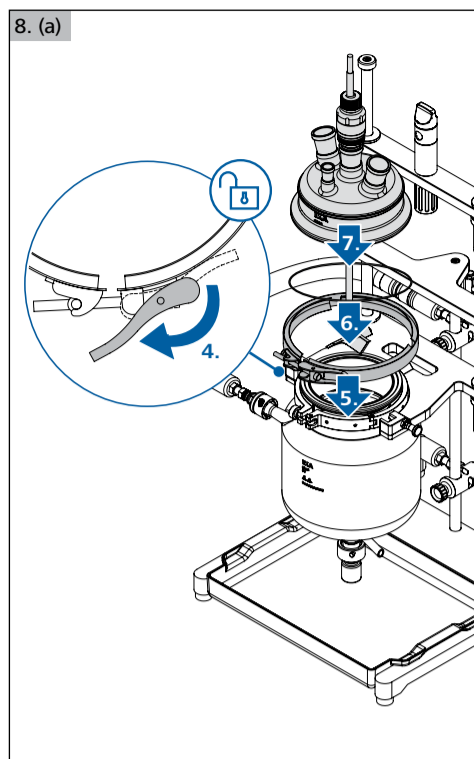

DE Montage des Rührwerks
 EN Assembling the overhead stirrer

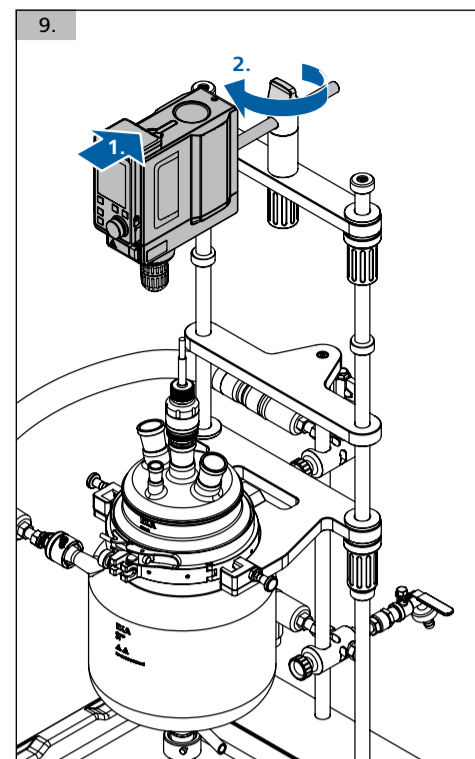
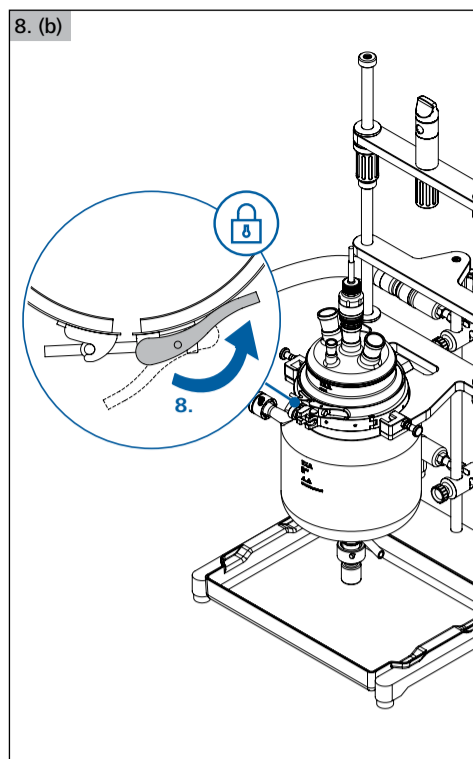

DE Positionierung des Rührwerks am Behälter / Befestigen des Rührwerkzeugs im Spannhalter
 EN Positioning of the overhead stirrer at the vessel / Securing the stirring tool using the chuck

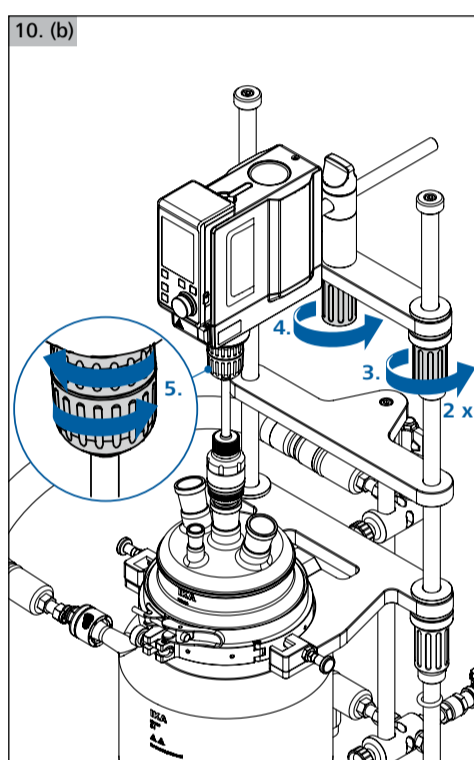
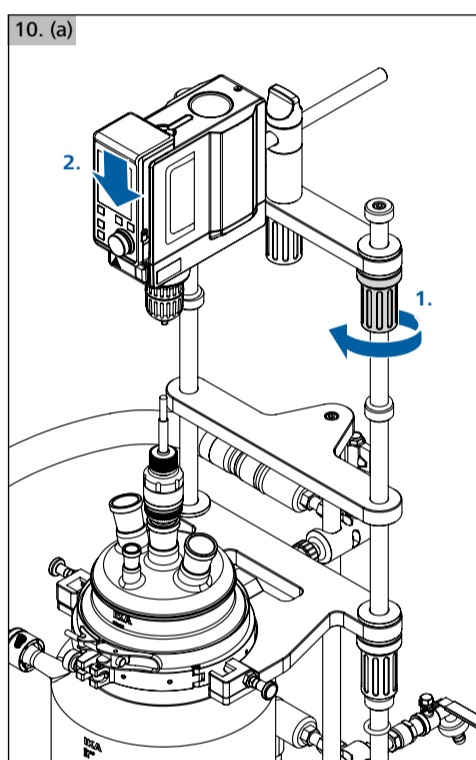

DE Anschluss an einen externen Thermostaten
 EN Connection to an external circulator

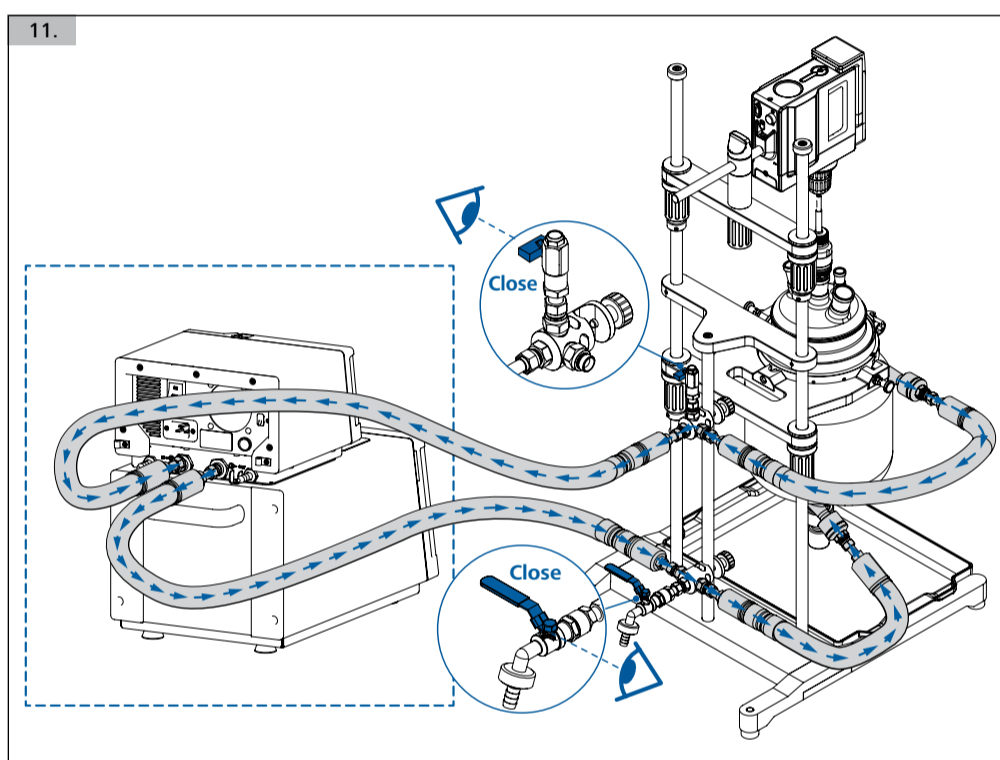

DE Entleeren der Temperierflüssigkeit
 EN Draining of the temperature fluid

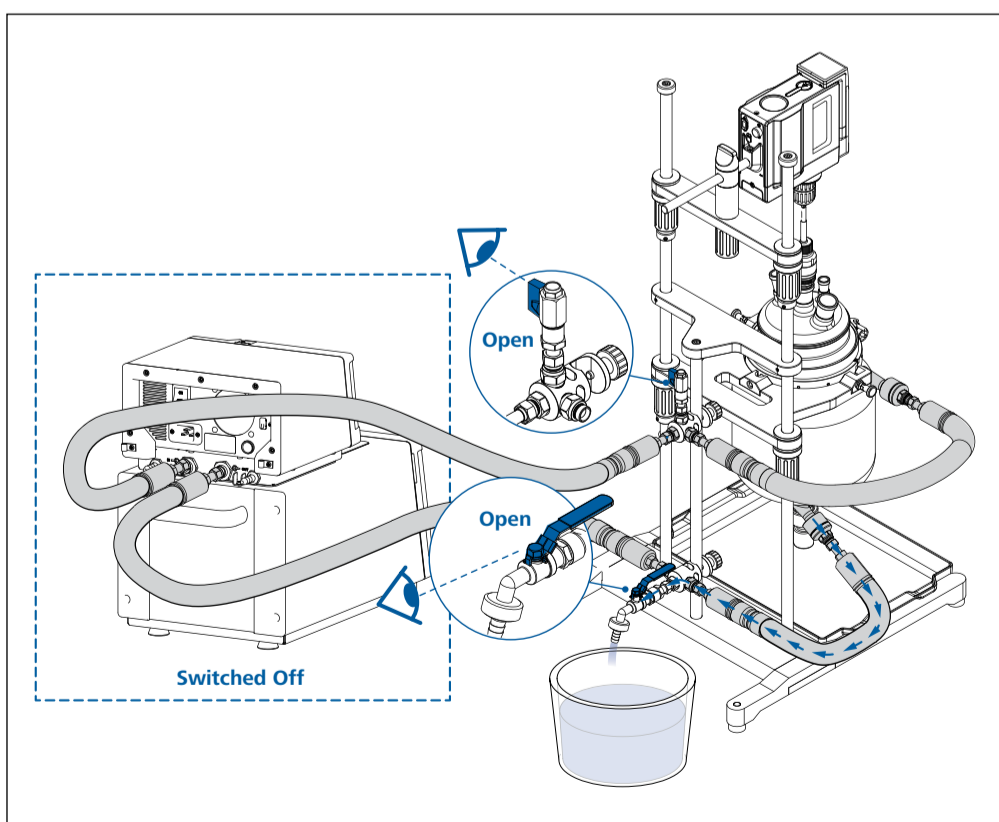

DE Beachten Sie die gekennzeichneten Stellen!
 EN Pay attention to the marked sites!

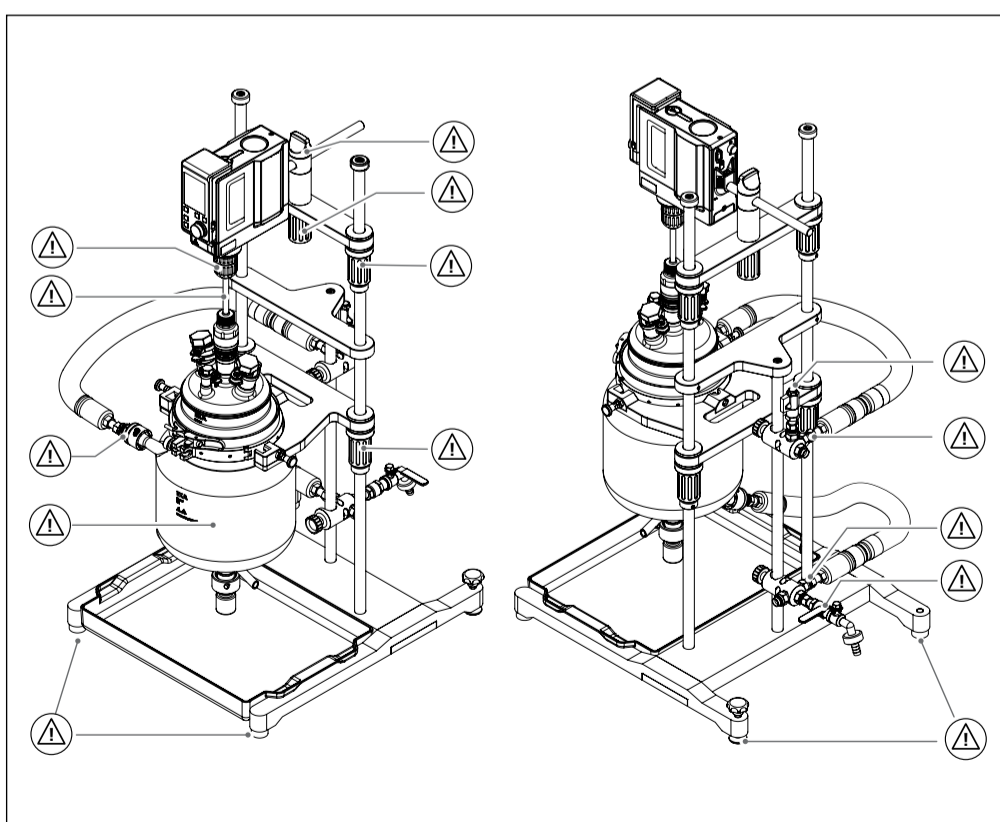

IKA-Werke GmbH & Co.KG
 Janke & Kunkel-Str. 10
 D-79219 Staufen
 Germany
 Tel. +49 7633 831-0
 Fax +49 7633 831-98
 sales@ika.de

www.ika.com