

# EN - Installation, use, and maintenance manual

**nobis**  
YOUR STOVE, OUR PASSION

N70 V/C  
N70 V/C TOP COAX





## WARNING!



**PERICOLO  
DI  
USTIONE**

SURFACES CAN BECOME **EXTREMELY HOT** - ALWAYS OBSERVE DUE PRECAUTIONS AND WEAR SUITABLE PROTECTIONS.

Dear Customer, Thank you for choosing a product from our range.

You are invited to read this manual carefully before using it, so as to take full advantage of all its features, in complete safety.

This manual contains information necessary for proper installation, start-up, use, cleaning and maintenance of the product.

After thorough consultation, store this manual in an appropriate place for future use.

The Manufacturer will not be held liable for improper installation, use, or maintenance of the product that may damage people or objects.

All rights reserved. No part of this instruction manual may be reproduced or transmitted by any electronic or mechanical means - including photocopying, recording or any other storage system - for any purpose other than the purchaser's personal use only without express written permission by the Manufacturer.

**INDICE DEL MANUALE**

|  |           |   |           |
|--|-----------|---|-----------|
| <b>1 INTRODUCTION</b>                            | <b>4</b>  |   |           |
| 1.1 SYMBOLS                                      | 4         |   |           |
| 1.2 INTENDED USE                                 | 4         |   |           |
| 1.3 IMPROPER USE                                 | 4         |   |           |
| 1.4 IMPORTANCE OF THE MANUAL                     | 4         |   |           |
| 1.5 GENERAL SAFETY WARNINGS                      | 4         |   |           |
| 1.6 LEGAL WARRANTY                               | 5         |   |           |
| 1.7 WARRANTY EXCLUSIONS                          | 5         |   |           |
| 1.8 SPARE PARTS                                  | 6         |   |           |
| 1.9 IDENTIFICATION PLATE                         | 6         |   |           |
| 1.10 PRODUCT DISPOSAL                            | 6         |   |           |
| 1.11 HERMETIC PRODUCT                            | 6         |   |           |
| <b>2 FUEL FEATURES</b>                           | <b>6</b>  |   |           |
| <b>3 INSTALLATION</b>                            | <b>7</b>  |   |           |
| 3.1 INSTALLATION ROOM                            | 7         |   |           |
| 3.2 VENTILATION - AMBIENT AIR INTAKE             | 7         |   |           |
| 3.3 SMOKE CHANNEL AND FITTINGS                   | 8         |   |           |
| 3.4 FIREPLACE/FLUE                               | 9         |   |           |
| 3.5 CHIMNEY TOP                                  | 9         |   |           |
| 3.6 HERMETIC PRODUCT INSTALLATION                | 9         |   |           |
| 3.7 EXAMPLES OF PROPER INSTALLATION              | 10        |   |           |
| 3.8 DOCUMENTS TO BE ISSUED                       | 11        |   |           |
| 3.9 UNPACKING THE PRODUCT                        | 11        |   |           |
| 3.10 INSTALLATION OF THE SIDE/UPPER FUME-EXHAUST | 12        |   |           |
| 3.11 INSTALLATION OF THE CANALIZATION KIT        | 13        |   |           |
| 3.12 ELECTRICAL CONNECTION                       | 14        |   |           |
| <b>4 MAINTENANCE</b>                             | <b>15</b> |   |           |
| 4.1 MAINTENANCE OF THE CHIMNEY SYSTEM            | 15        |   |           |
| 4.2 PRODUCT MAINTENANCE                          | 15        |   |           |
| <b>5 PRODUCT TECHNICAL DATA</b>                  | <b>15</b> |   |           |
| 5.1 PRODUCT DETAILS                              | 15        |   |           |
| 5.2 TECHNICAL FEATURES                           | 15        |   |           |
| 5.3 PRODUCT DIMENSIONS                           | 16        |   |           |
| 5.4 SAFETY DISTANCES                             | 17        |   |           |
| <b>6 USER INTERFACE</b>                          | <b>17</b> |   |           |
| 6.1 RECEIVER                                     | 17        |   |           |
| 6.2 REMOTE CONTROL: COMMAND KEYS                 | 18        |   |           |
| 6.3 DISPLAY                                      | 18        |   |           |
| <b>7 MENU BROWSING</b>                           | <b>18</b> |   |           |
| <b>8 MENU BROWSING</b>                           | <b>19</b> |   |           |
| 8.1 PELLET FEEDING                               | 19        |   |           |
| 8.2 MENU 01 - DATE/HOUR SETTINGS                 | 19        |   |           |
| 8.3 MENU 10 - ROOM PROBE                         | 19        |   |           |
| 8.4 MENU 04 - AUTO FUNCTION                      | 20        |   |           |
| 8.5 ROOM TEMPERATURE SETTINGS                    | 20        |   |           |
| 8.6 POWER SETTINGS                               | 20        |   |           |
| 8.7 PRODUCT SWITCH ON/OFF                        | 20        |   |           |
| <b>9 FUNCTIONING</b>                             | <b>21</b> |   |           |
| 9.1 ECO MODE                                     | 21        |   |           |
| 9.2 COMFORT CLIMA                                | 21        |   |           |
| <b>10 "USER SETTINGS" MENU FUNCTIONS</b>         | <b>22</b> |   |           |
| 10.1 MENU 02 - CHRONOTHERMOSTAT                  | 22        |   |           |
| 10.2 MENU 07 - AUGER LOADING                     | 22        |   |           |
| 10.3 MENU 06 - PELLET/AIR INTAKE RATIO           | 23        |   |           |
|  |           | 10.4 MENU 12 - STOVE STATUS                       | 23        |
|  |           | 10.5 MENU' 08 - LANGUAGE SETTINGS                 | 24        |
|  |           | 10.6 FIRMWARE VERSION                             | 24        |
|  |           | 10.7 MENU 05 - ANTICONDENSATION                   | 24        |
|  |           | 10.8 MENU 00 - VENTILATION SETTINGS               | 24        |
|  |           | 10.9 MENU 14 - WIFI (WIFI OPTIONAL KIT)           | 25        |
|  |           | <b>11 DUCTING (Optional)</b>                      | <b>25</b> |
|  |           | 11.1 SINGLE DUCTING SETTINGS                      | 25        |
|  |           | 11.2 PROGRAMMABLE DUCTING                         | 26        |
|  |           | 11.3 DISPLAY DUCTING STATUS                       | 26        |
|  |           | 11.4 DOUBLE DUCTING SETTINGS                      | 26        |
|  |           | 11.5 PROGRAMMABLE DUCTING                         | 27        |
|  |           | 11.6 DISPLAY DUCTING STATUS                       | 27        |
|  |           | <b>12 PHASE OVERVIEW</b>                          | <b>28</b> |
|  |           | <b>13 FUNCTION OVERVIEW</b>                       | <b>28</b> |
|  |           | <b>14 ALERTS OVERVIEW</b>                         | <b>29</b> |
|  |           | <b>15 ANOMALY OVERVIEW</b>                        | <b>29</b> |
|  |           | <b>16 DESCRIPTION OF ALARMS</b>                   | <b>29</b> |
|  |           | 01 - BLACK OUT                                    | 30        |
|  |           | 02 - NO IGNITION                                  | 30        |
|  |           | 03 - PELLETS EXHAUSTED                            | 30        |
|  |           | 04 - SMOKE TEMPERATURE                            | 30        |
|  |           | 05 - SMOKE EXTRACTOR NOT RESPECTING RPMs          | 30        |
|  |           | 06 - FAULTY SMOKE EXTRACTOR                       | 30        |
|  |           | 07 - PELLET-LOADING GEARMOTOR NOT RESPECTING RPMs | 30        |
|  |           | 08 - FAULTY PELLET-LOADING GEARMOTOR              | 30        |
|  |           | 09 - PELLET-LOADING AUGER BLOCKED                 | 30        |
|  |           | 10 - PELLET-LOADING AUGER POWER SUPPLY DEFECT     | 30        |
|  |           | 11 - PASCAL MIN. NEGATIVE PRESSURE                | 31        |
|  |           | 12 - FAULTY BRAZIER CLEANER                       | 31        |
|  |           | 13 - NEGATIVE PRESSURE IN CHIMNEY FLUE            | 31        |
|  |           | 14 - THERMOSTAT MANUAL-RESET SWITCH               | 31        |
|  |           | 15 - ASH DRAWER OPEN                              | 31        |
|  |           | 18 - FLAME PROBE                                  | 31        |
|  |           | 22 - FLAME TEMPERATURE                            | 31        |
|  |           | 23 - AUGER TRIAC                                  | 31        |
|  |           | 24 - AUGER PHASE                                  | 32        |
|  |           | 28 - FAULTY SMOKE ENCODER                         | 32        |
|  |           | 29 - CLEANING CYCLE LIMIT                         | 32        |
|  |           | <b>17 PRODUCT CLEANING</b>                        | <b>32</b> |
|  |           | 17.1 FIRE COMPARTMENT CLEANING                    | 32        |
|  |           | 17.2 CLEANING OF THE DOOR GLASS                   | 33        |
|  |           | 17.3 CLEANING OF THE ASH PAN                      | 33        |
|  |           | 17.4 CLEANING OF THE PELLET TANK                  | 34        |
|  |           | 17.5 MAINTENANCE TIMETABLE                        | 34        |
|  |           | <b>18 WIRING DIAGRAM</b>                          | <b>36</b> |

## 1 INTRODUCTION

This product is designed and built with high-quality materials and in compliance with the reference standards for construction products (EN13240 wood stoves, EN14785 pellet appliances, EN13229 fireplaces/wood inserts, EN12815 wood cookers). The products also comply with the essential requirements of Directive 2014/35/EU (Low Voltage) and Directive 2014/30/EU (Electromagnetic Compatibility).



The printing, translation, and reproduction, even partial, of this manual are subject to the manufacturer's authorization, and the content of the operating logic and explanatory figures is to be considered exempt from disclosure.

Always consult authorized technicians in case of doubts and/or perplexities about the functioning of the product.

**The manufacturer reserves the right to modify specifications and technical and/or functional characteristics of the product at any time without prior notice.**

### 1.1 SYMBOLS

This manual contains symbols highlighting the importance of particular descriptions or concepts:

|   |   |
|---|---|
|  | <b>INFORMATION:</b> Complying with the instructions contained in this manual guarantees the correct functioning of the product. |
|  | <b>CAUTION:</b> Symbol used to identify information of particular relevance.  |
|  | <b>DANGER:</b> This symbols require utmost attention, to guarantee user safety and product integrity.                           |

### 1.2 INTENDED USE

The product covered by this manual is a fireplace for domestic use, fuelled exclusively by automatic wooden pellet feeding or manual firewood feeding.

The product is designed and built to work safely under the following conditions:

- installation performed by specialized personnel according to the specific reference standards;
- use within the limits stated on the product sheet and in this manual;
- compliance with the technical procedures described in the manual;
- carrying out ordinary maintenance in the times and in the ways indicated in this manual;
- timely execution of extraordinary maintenance in case of need (malfunction);
- activity and maintenance of safety devices (do not remove or exclude these devices).

### 1.3 IMPROPER USE

The product must not be intended for uses other than that for which it was expressly made. Otherwise, the manufacturer cannot be held liable for any damages to people, animals or things.

Improper use is to be understood:

- using the product as an incinerator;
- using the product with fuel other than 6-mm-diameter wood pellets or wood logs;
- using the product with liquid fuels;
- using the product with the fire door open and/or broken glass and/or ash pan removed and/or pellet tank open.

Any other use of the appliance other than that envisaged must be previously authorized in writing by the Manufacturer.

Furthermore, the Manufacturer declines any liability related to improper installation, adjustments, and maintenance of the product.

### 1.4 IMPORTANCE OF THE MANUAL

This manual aims at providing the basic rules for proper installation, use and maintenance of the product.

**STORAGE:** Keep this manual in a place where you can quickly access it at any time;

**DETERIORATION OR LOSS** Visit Nobis' official website to download a digital version;

**TRANSFER OF THE PRODUCT:** In case of private sale of the product, it is mandatory for the owner to deliver the generator together with this manual, as it is an integral part of the product.

### 1.5 GENERAL SAFETY WARNINGS

Failure to comply with the instructions in this manual can cause damage to people, animals or things.

- Installation, system check, product functional test and first calibration must be carried out by qualified and authorized personnel only.
- The product must be connected to a single flue duct which guarantees the draft declared by the Manufacturer and which complies with the installation standards envisaged in the place of assembly of the same.
- The room where the product is installed must be suitably oxygenated (air intake).
- To avoid burns, always wear suitable safety equipment before touching the hot surfaces of the product.
- When in operation, the external surfaces of the product reach high temperatures.
- It is prohibited to make changes to the product

unless expressly authorized in writing by the Manufacturer.



• **In the event of a fire in the flue, contact the Fire Brigade immediately.**

- The product cannot be used by a minor, a person incapable of giving consent, or by a person with reduced sensory, physical or mental capabilities. Furthermore, it must not be used by persons who, despite the aforementioned capacity, have not had adequate training on use and maintenance, or who - in any case - have not read this manual in its entirety.
- Children must be kept away from the generator, especially during operation and maintenance, and they must be prevented from accessing the product to play, even if the appliance is switched off and cold.
- Cleaning and ordinary maintenance which can be carried out by the user must not be performed by a minor, persons not capable of giving consent or persons with reduced sensory, physical or mental capabilities. Furthermore, it must not be used by persons who, despite the aforementioned capacity, have not had adequate training on use and maintenance, or who - in any case - have not read this manual in its entirety.



- Do not place clothes or linen on the product, neither dry nor wet. Do not place the drying rack in front of the generator at a distance lower than that indicated in the table shown in section 5.4 - **Fire hazard**.



- Any combustible or heat-sensitive material (e.g., sofas, tables, chairs, curtains, etc.) must be kept at a safe distance from the product. For further information on safety distances, see the table shown in section 5.4 - **Fire hazard**.
- While in operation, the hearth's door must always be closed;
- The product must be electrically connected to a system equipped with an effective earthing system.
- In case of failure of the ignition system, do not force ignition using flammable materials and contact an authorized technician.
- Do not pull, disconnect, or twist the electric cables connected to the product - where present - even if disconnected from the power grid, and avoid contact with hot parts and/or smoke outlet;
- This product can be installed in a suitable room with a minimum volume of 50 m<sup>3</sup>.
- For the non-airtight product, it is prohibited to install the product in bedrooms, bathrooms, toilets and studio apartments;
- It is prohibited to install the product in environments with explosive atmosphere, places exposed to fire hazard, warehouses of combustible materials.
- Installation in rooms for which there is no heating/ not to be heated is not permitted.

- Check the product for any clogging before using it following a long period of non-use.

## 1.6 LEGAL WARRANTY

In order to take advantage of the legal guarantee, the user must scrupulously observe the instructions indicated in this manual. In particular:

- always operate within the limits of use of the product;
- always carry out routine maintenance;
- authorize use by people of proven ability, aptitude and adequately trained for the purpose;
- use original and specific spare parts for the appliance model.

It is also necessary to provide the following:

- fiscal receipt proving the date of purchase;
- certificate of conformity of the installation, issued by authorized staff.

Failure to comply with the instructions contained in this manual will result in immediate forfeiture of the warranty, both of the product and of any spare parts fitted at a later time.

## 1.7 WARRANTY EXCLUSIONS

All malfunctions and/or damage to the appliance due to the following causes are excluded from the guarantee:

- damage caused by transport and/or handling;
- negligence, careless use, improper maintenance, or installation which does not comply with the manufacturer's specifications (always refer to this manual);
- further damages caused by wrong interventions by the user in an attempt to remedy the initial malfunctioning;
- increased damage caused by further use of the appliance by the user once the defect has occurred;
- in the presence of hydronic systems, any corrosion, encrustations or damages caused by stray currents, condensation, aggressive or acid water, improper descaling treatments, lack of water, mud or limestone deposits;
- damage deriving from using the product as a chafing dish;
- inefficiency of chimneys, flues, or parts of the system whose functioning relies on the appliance;
- damage caused by tampering, atmospheric agents, natural disasters, acts of vandalism, electric shocks, fires, defects in the electrical and/or hydraulic system.

The following are also excluded from the product warranty:

- parts subject to normal wear and tear such as gaskets, glasses, coverings and cast iron grids, painted, chromed or gilded details, handles and electric cables, lamps, ignition resistors, indicator lights, knobs, all parts that can be removed from the firebox (e.g. refractory, brazier) and/or subject to the direct action of fire;
- the chromatic variations of the painted and ceramic parts, as well as the cracks of the ceramic as they are natural characteristics of the material and of the use of the product;
- masonry;
- system details (if present) not supplied by the manufacturer.

Any technical interventions for restoring the product must be agreed with the Authorized Technical Assistance Centre, which reserves the right to accept or not the assignment, and will be carried out for a fee according to the rates in force.

The expenses for remedying incorrect technical interventions, tampering or, in any case, factors harmful to the appliance not attributable to manufacturing defects will also be charged to the user.

Without prejudice to the limits imposed by laws or regulations, any guarantee of containment of atmospheric and acoustic pollution is also excluded.

## 1.8 SPARE PARTS

Use only original spare parts.

Do not wait for the components to wear out before replacing them.

This precaution helps prevent accidents to people, animals or things in the event of product malfunction.

To replace spare parts, consumables, and to carry out extraordinary maintenance, it is recommended to contact an authorized technician.

## 1.9 IDENTIFICATION PLATE

An identification plate, to be found on the back of the product, shows all the product technical information, including the Manufacturer's data, serial number and CE marking.

## 1.10 PRODUCT DISPOSAL

The demolition and disposal of the product is the exclusive responsibility of the owner, who must act in compliance with the laws in force in his country regarding safety, respect and protection of the environment.

At the end of its useful life, the product must not be disposed of together with urban waste.

It can be delivered to the appropriate separate collection centers set up by the municipal

administrations, or to retailers that provide this service.

Disposing of the product separately helps reducing the environmental impact and avoid health issues resulting from inappropriate disposal. It also allows the recovery of the materials it is made of in order to obtain significant savings in energy and resources.

## 1.11 HERMETIC PRODUCT

The products built with a perfectly air-tight structure do not consume room oxygen, as they take the air from outside the building (if properly installed) and can, therefore, be placed inside all houses with a high degree of insulation, such as "passive houses" or highly energy-efficient. Thanks to such technology, there is no risk of smoke emissions into the environment and, therefore, there is no need for ventilation grids.

Hermetic products can also be installed in the presence of forced ventilation or in rooms where pressure can be lower if compared to the outside.

## 2 FUEL FEATURES

Wood pellets are a type of fuel made from compressed sawdust, often retrieved from carpentry processing waste. The material used must be pure and must not contain any foreign matter, e.g., glue, lacquer or artificial substances. The sawdust, after being dried and cleaned of impurities, is pressed through a matrix: due to the high pressure the sawdust heats up, activating the natural binders of the wood; in this way the pellet maintains its shape even without the addition of artificial substances. The density of wood pellets may vary depending on the type and can be 1.5 - 2 times higher than that of natural wood.

One single pellet has a diameter of 6 mm and variable length between 10 and 40 mm.

Their density is approximately 650 kg/m<sup>3</sup>. Due to their low water content (<10%) they have a high energy content.

The main quality certifications for pellets existing on the European market allow us to guarantee that the fuel falls into class A1 according to ISO 17225-2:2014 (formerly EN 14961). Examples of these certifications are for example ENPlus, DINplus, Ö-Norm M7135, and guarantee that the following characteristics are respected in particular:

- calorific value: 4.6 ÷ 5.3 kWh/kg;
- water content: ≤ 10% of its weight;
- ash percentage: max 1.2% of its weight (A1 less than 0.7%);
- diameter: 6±1/8±1 mm;
- length: 3÷40 mm;
- content: 100% untreated wood and without any added binding substances (max. 5% bark

content);

- packaging: bags made of eco-compatible or bio-decomposable material.



For the products in the range, the Manufacturer prescribes the use of certified class A1 fuel, in compliance with ISO 17225-2:2014, DIN PLUS certificate (which is more restrictive than class A1), or else O-NORM M7135.



Pellets must be stored in a dry environment, not excessively cold. It is also advisable to keep some pellet bags (in any case not exceeding 1.5m<sup>3</sup>) in the room where the product is used, so as to allow any moisture to dry out.

Neglecting this aspect will result in lower efficiency of the fuel and, as a consequence, more maintenance to be carried out.

### 3 INSTALLATION



*Installation and use must take place in compliance with all the respective ISO, EN, UNI reference standards in force and pursuant local and national laws.*

Product installation and its connection to both the flue and heating systems must be carried out by a qualified technician, according to the laws in force (in Italy, e.g., see Ministerial Decree 37/08 and subsequent amendments, and Legislative Decree 28/11 and subsequent amendments).



**The manufacturer is not liable for any claim for compensation for damages due to installation which does not comply with the technical standards and all the legislative provisions in force, or for installation carried out non-competent and non-authorized persons, as indicated in the previous paragraph.**

#### 3.1 INSTALLATION ROOM

- The choice of the assembly position must take place according to the installation environment, according to the presence of a suitable flue or its possibility of realisation, according to the presence of a compliant electrical system, where necessary, according to the presence of a hydraulic system, where necessary, and according to the possibility of direct or indirect ventilation or air ducting.
- The installation room must be suitable (see also the technical standards in force, for example UNI10683), it must not be a room at risk of fire, a potentially dangerous room, a deposit of combustible material, a non-heatable room (case in which the appliance heats the installation room).
- Evaluate the capacity of the attic/floor before

laying. If the existing construction does not meet this requirement, appropriate measures should be taken (for example a load distribution plate). It is recommended to consult a professional on the subject.

- The installation room must have a minimum volume of 50 m<sup>3</sup>
- Minimum safety distances for fire prevention must be taken into consideration when installing the appliance in the room. In the presence of combustible materials and/or heat-sensitive materials (furniture, curtains, sofas, wooden walls and surfaces, building insulation, etc.) adjacent to the generator, minimum free space must be observed as per values shown in the relevant table of the "Safety distances" chapter.
- We recommend using a protective platform made of suitable material (steel, glass, etc.) to prevent combustible material from accidentally falling from the front part of the product and causing harm during loading/cleaning operations;
- The installation of the appliance must take into consideration any presence of other heat generators or suction systems (e.g., hoods, extractor fans, etc.) for the following purposes:
  - fire prevention (that may break out due to the combined power of all heat generators);
  - possible coexistence, e.g., with non-airtight gas- and/or diesel-fuelled appliances (see technical standard UNI10683). Remember that it is forbidden to install non-watertight biomass appliances in rooms communicating with other rooms where there is a type A or type B gas or diesel generator;
  - suitability assessment of direct and/or indirect room ventilation system to serve the suction systems and appliances installed;
- The installer must analyze the technical specifications of the appliance, to verify its compatibility with the energy requirements of the room(s) served and the coexistence with any other appliances present.

#### 3.2 VENTILATION - AMBIENT AIR INTAKE

- The installation room of non-hermetic appliances must be sufficiently ventilated with special openings, with particular attention to the position, which allow the reintegration of the air into the room. Remember that non-hermetic appliances feed the fire by consuming the oxygen present in the installation room.
- Ventilation is considered sufficient when the room is equipped with air intakes according to the table:

| APPLIANCE CATEGORY | REFERENCE STANDARD    | % NET SECTION COMPARED TO THE APPLIANCE SMOKE OUTLET | MINIMUM NET VALUE OF THE VENTILATION DUCT OPENING |
|--------------------|-----------------------|--|---|
| Fireplaces         | UNI EN 16510-2-2:2022 | 50%  | 200 cm <sup>2</sup>                               |
| Stoves             | UNI EN 16510-2-1:2022 | 50%  | 100 cm <sup>2</sup>                               |
| Cookers            | UNI EN 16510-2-3:2022 | 50%  | 100 cm <sup>2</sup>                               |

| APPLIANCE CATEGORY | REFERENCE STANDARD    | % NET SECTION COMPARED TO THE APPLIANCE SMOKE OUTLET | MINIMUM NET VALUE OF THE VENTILATION DUCT OPENING |
|--------------------|-----------------------|--|---|
| Pellet stoves      | UNI EN 16510-2-6:2022 | -  | 80 cm <sup>2</sup>                                |
| Pellet boilers     | UNI EN 303-5          | -  | 6cm <sup>2</sup> x kW                             |

- If the ventilation intake is made in an adjacent room directly connected with the outside, the hole between the ventilation room and the installation room must be doubled at each passage (see UNI10683). The hole towards the external environment must be equal to what is prescribed in the previous point. Pay attention to any other suction systems to prevent the ventilation room and/or the installation room from being depressed.
- The maximum pressure difference allowed between the outside and the installation room is always and in any case a maximum of 4Pa (meaning ambient depression).
- The air for ventilation of the installation rooms cannot be taken from rooms at risk of fire, such as garages, bedrooms, bathrooms and toilets, common rooms of the building.
- It is forbidden to take the combustion air from the crawl spaces or less than half a meter from the return/delivery vents of the crawl spaces.
- Ventilation holes can be closed with grids as long as they do not reduce their useful section, and do not hinder ordinary maintenance operations.
- The ventilation inlets must NEVER be obstructed by any type of material, not even partially, which could jeopardize the occupants' health.
- The ventilation outlets must comply with the relevant technical standards and any current local and national regulations, specifically with regard to their section, position, type and characteristics.
- Opening the ventilation hole is not necessary in the case of installation of airtight and watertight appliances, with the appropriate ventilation duct.
- In the presence of CMV (controlled mechanical ventilation), installation with combustion air drawn from the installation room is not permitted - see the "Ventilation ducting" chapter;
- The manufacturer is not liable for any claim for compensation for damages due to non-compliant installation of the ventilation outlets with respect to the above, and to the technical standards and all the legislative provisions in force.

### 3.2.1 VENTILATION DUCTING

- To channel combustion air from the outside to a traditional appliance or, in case of airtight installation (hermetic appliance), it is necessary to install a ventilation duct.
- The ventilation duct must have a section equal to or greater than the combustion air connection of the appliance.
- The ventilation duct must have the same section along its entire length, any section restrictions are

only allowed at the generator inlet;

- The ventilation ducts and relative grilles must comply with the technical standards and any applicable local and national regulations, in particular as regards the section, position, type and characteristics.
- The manufacturer is not liable for any claim for compensation for damages due to non-compliant installation of the ventilation ducts with respect to the above, and to the technical standards and all the legislative provisions in force.
- In the presence of a CMV system (Controlled Mechanical Ventilation) the installation of hermetic appliances or appliances with a closed hearth is permitted as long as combustion air is drawn directly from the outside via a ventilation duct.

### 3.3 SMOKE CHANNEL AND FITTINGS

The term smoke duct refers to the set of pipes and elements that connect the appliance to the chimney/flue and are used to convey the products of combustion towards the outside. The smoke duct is a very important section that must be correctly laid to ensure proper functioning of the system.

- All smoke ducts must be sized using a thermo-fluid dynamic calculation in accordance with EN13384-1;
- The smoke ducts must be installed according to the UNI10683 technical standard;
- For metal ducts, comply with the EN1856-2 product standard;
- The sub-horizontal sections must have a minimum slope of 3% upwards;
- The length of the sub-horizontal section must be minimal and its floor projection must not exceed 2 metres;
- In the case of appliances with rear outlet, there cannot be more than 3 changes in direction, including that of the chimney/flue connection and the T-joint or bend at the generator connection. Changes in direction must not have an angle greater than 90° (bends of max. 45° are recommended);
- The section diameter must be constant or greater from the fireplace outlet to its connection with the flue;
- The use of flexible metal pipes, even those that cannot be stretched, is prohibited;
- The smoke duct for appliances equipped with a smoke side fan must ensure the seal of the combustion products and have the seal class at minimum pressure P1;
- In any case, the smoke ducts must seal any combustion products and condensate, as well as be insulated if they present sections extending outside the installation room;
- With regard to the smoke duct, it is necessary to



create a first vertical section, at least 1 metre long, to guarantee proper fume discharge;

- The smoke ducts must not cross rooms in which the installation of combustion appliances is prohibited, rooms at risk of fire, fireproof rooms, rooms exposed to a specific risk of fire, or non-inspectable spaces;
- The entire route of the smoke duct must maintain the safety distances from flammable materials as foreseen by the manufacturer of the components of the smoke duct itself.
- The installation of manual draft adjustment devices on forced draft appliances is not permitted;
- Provide the sampling point for draft measurement and fume analysis as per UNI10683 and UNI10389-2 standards.

### 3.4 FIREPLACE/FLUE

The term chimney/flue refers to the section of the combustion products evacuation system from the connection to the generator or to the smoke duct up to the roof.

When constructing the fireplace/flue, the following requirements must be applied:

- For metal ducts, comply with the EN 1856-1 product standard;
- All chimneys/flues must be sized using a thermo-fluid dynamic calculation in accordance with EN13384-1.
- Chimneys/flues must be installed according to the UNI10683 technical standard. Both the use of chimney systems and ducting ducts are permitted.
- Operation under positive pressure is not permitted. Chimney systems and ducted ducts must operate under negative pressure with respect to the environment, as per the product's technical data sheet.
- It must be made with suitable materials to guarantee resistance to normal thermal and mechanical stresses, it must have suitable corrosion resistance for solid fuels, and have correct insulation, in order to avoid the formation of condensation, and therefore be thermally insulated;
- The flue must be predominantly vertical and free of bottlenecks along its length;



- Be properly spaced by air gap and isolated from flammable materials. In the case of installation of a composite chimney, to verify surface temperatures for fire-prevention purposes, the thermal calculation must be performed in compliance with EN15287;

- If a chimney system is installed, the safety distances from flammable materials must be assessed, as per the product designation given in the CE marking, in the DoP and in the chimney plate;
- Changes of direction must be a maximum of 2 and with an angle not exceeding 45°;
- The flue inside the house must in any case be insulated and can be inserted in a shaft, provided

it complies with the regulations relating to ducting;

- The smoke duct must be connected to the flue by means of a "T" fitting equipped with an inspectable collection chamber (necessary for collecting combustion residue and, above all, condensate);
- The chimney/flue must expel smoke above the roof, as required by UNI10683 standard.



- It is prohibited to connect the appliance to a fireplace/flue shared with other appliances or in the presence of extractor hoods or other aspirators. Collective flues are not permitted. It is forbidden to use the direct outlet on the wall or towards closed spaces and any other form of outlet not envisaged by the legislation in force in the country of installation (in Italy only roof outlet is permitted).

- It is possible to use the air from the interspace of the technical slot, in compliance with the provisions of UNI10683;
- In case of multiple ducting, avoid mutual interference and pay attention to the pressures, distances and coexistence of the various ducts, as prescribed by UNI10683;
- In case of wet operation, set up the condensate drainage system by scrupulously following the provisions set by standard UNI10683;

### 3.5 CHIMNEY TOP

UNI10683 prescribes that the chimney pot must comply with the following requirements:

- The smoke outlet section must be at least double the internal section of the chimney;
- Be shaped in such a way as to prevent the penetration of water or snow;
- Be built so that in the event of wind the smoke outlet is equally ensured (windproof cap);
- The outlet level, which is measured between the lower roofing mantle and the lower point of the fume outlet section into the atmosphere, must be outside the reflux area;
- Always be positioned away from antennas or satellite dishes and must never be used as a support;
- Must ensure regular maintenance;
- It must be installed at a safe distance from other chimneys, or obstacles with and without openings (e.g., doors, windows, dormer windows, skylights, etc.), in compliance with UNI10683.

### 3.6 HERMETIC PRODUCT INSTALLATION

In case of hermetic products, you can follow the example below:

fume exhaust (1) and recovery of combustion air directly from the outside (2).

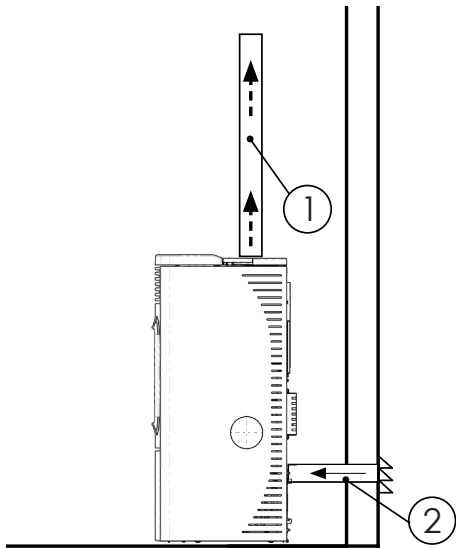

! For installations where combustion air is drawn directly from the outside, do not exceed 1 (one) linear meter to ensure proper oxygen supply to combustion.

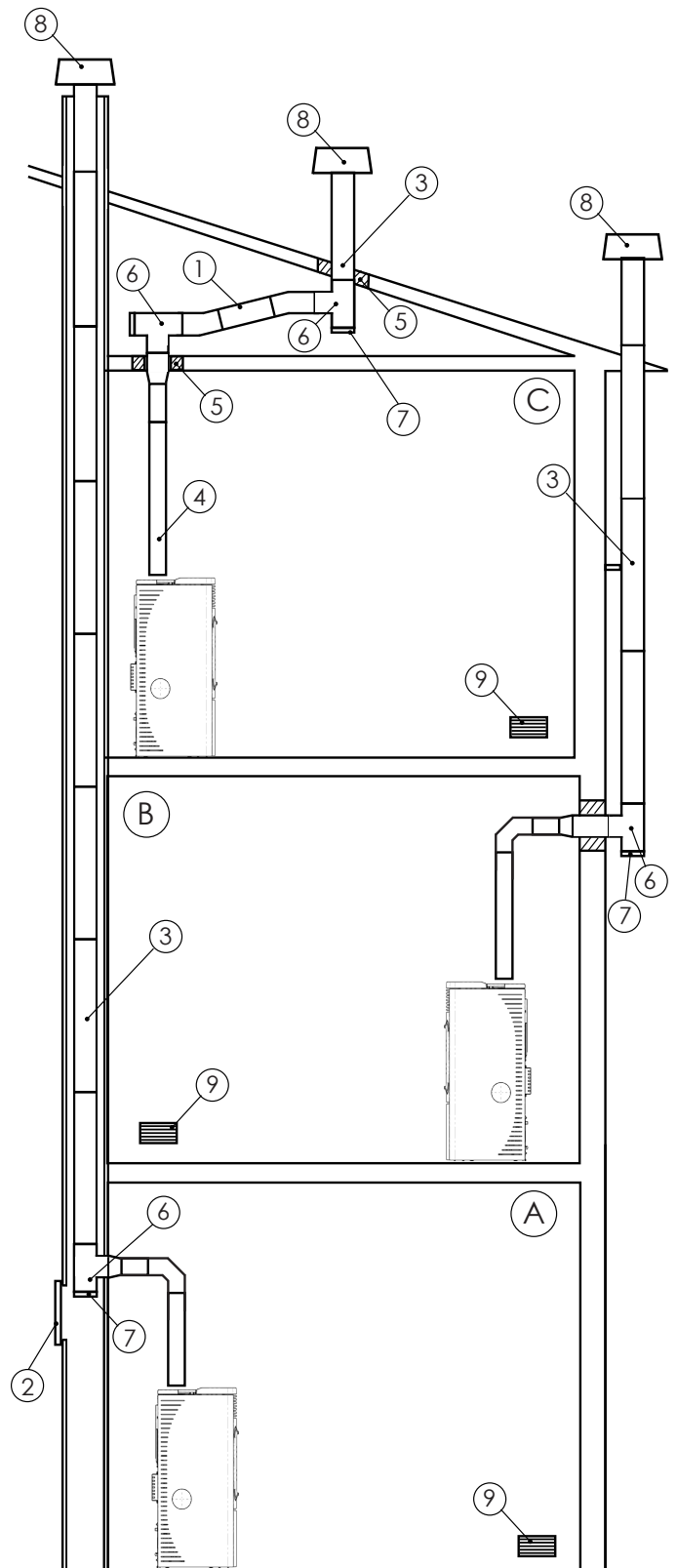

### 3.7 EXAMPLES OF PROPER INSTALLATION

Always refer to the UNI 10683 standard for product installation by a qualified professional, who is required to issue the INSTALLATION CERTIFICATE OF CONFORMITY for the whole Italian territory.

Examples: (A) horizontal section needed for connection to an existing flue. Observe a 3-5% upward slope to reduce the quantity of ash deposit in the horizontal section of the pipe - which must not exceed 2m (1). The existing flue must be inspectable (2).

The installation of the product (B) requires an insulated flue pipe (3), as this has been mounted outside the building.

Example (C) uses the single wall smoke duct (4) for the section inside the house. In relation to the part located in the attic, outside the generator installation room, it is necessary to install an insulated section, with a double crossing of the attic and roof; the holes for the passage of the pipe must respect the minimum safety distances indicated on the labels of the sections of the flue itself, paying attention to the material crossed:

- if in contact with concrete, bricks, etc.;
  - if in contact with wood, composite materials, etc.
- In both cases, insert a suitable roof passage (5) between the flue and the attic.

It is recommended to check and respect the data plate of the flue, in particular the safety distances from combustible materials.

The previous rules also apply to connection holes drilled on the wall.

In the lower part of the flue pipe and at the flue pipe inlet, a "T" type connector (6) with inspection plug (7) has been fitted for the all 3 types of installation.

In the upper part of the flue, for all 3 examples, a windproof chimney pot (8) has been mounted. For all the 3 types of installations, a grate (9) has been provided to ensure good oxygenation of the room where the product has been placed. In case of hermetically sealed appliance, equipped with direct outdoor connection of the air-intake system, a grate is not required.

### 3.8 DOCUMENTS TO BE ISSUED

After installation, the fitter must hand over to the user the following documentation:

- the use and maintenance manual of the appliance as supplied by the manufacturer;
- the technical documentation of the accessories used and subject to maintenance;
- the documentation relating to the combustion products evacuation system;
- The system booklet;
- documentation of successful installation and functional testing;

The documentation useful for the purposes of the installer's responsibilities must include:

- detailed description (also photographic) of the presence of other heat generators;
- declaration of conformity of the plant with the

rules of the art (DM 37/08);

- general description, or diagram, or photographic documentation of the plant modifications made, if it was necessary to intervene during installation;
- The use of certified material with the CE mark (305/2011);
- any relevant information for the purposes of the guarantee;
- date and signature of the installation technician;



**NOBIS SRL declines all responsibility in the event of non-compliance with any standard for the installation and commissioning of its products.**

### 3.9 UNPACKING THE PRODUCT

The packaging is composed of boxes in recyclable cardboard, according to RESY standards, and wooden pallets. All packaging materials can be re-used for similar use or, if necessary, disposed of as urban waste, in compliance with legislation in force.

Cut the strap binding the pallet to the packaging and lift the cardboard; remove the plastic bag around the product, ensuring it is intact.

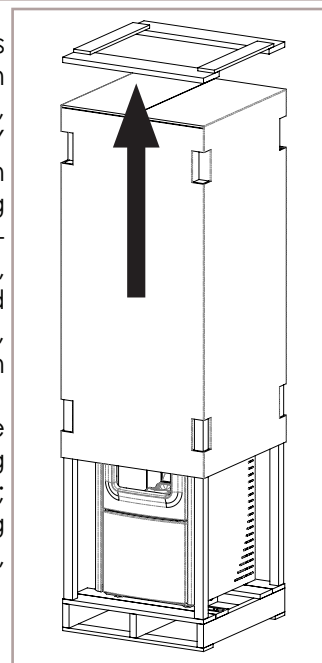

**The body must always be moved in a vertical position using trolleys.**

Pay particular attention so that the door and its glass are protected against mechanical impacts which would compromise their integrity.

If possible, unpack the product near the area where it will be installed.

To remove the appliance from the pallet, unscrew the metal supports holding it, so as to release it from the wooden base.

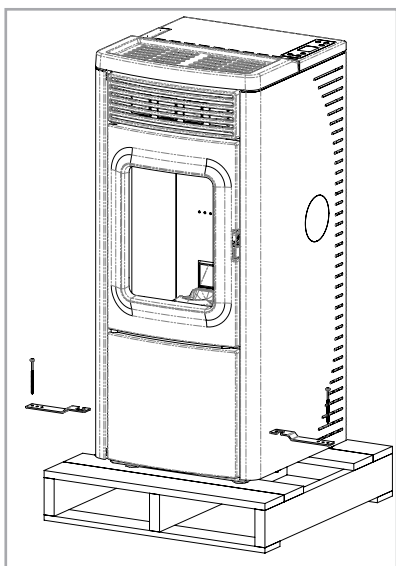

Place the appliance and connect it to the flue pipe. Install the 4 adjustable feet and adjust them to match the smoke outlet with the pipe. Remember that the finishing frame must also be installed. Therefore, make sure to calculate the space accordingly.

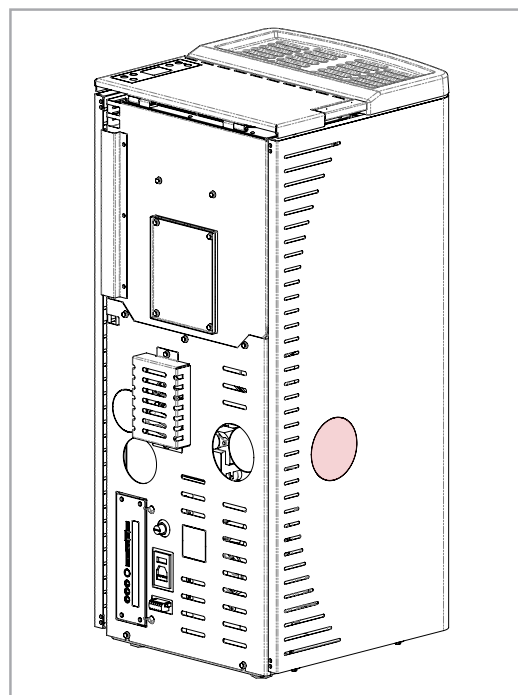

Turn the rear smoke exhaust bend by 90°.

### 3.10 INSTALLATION OF THE SIDE/UPPER FUME-EXHAUST

Below you will find the instructions for proper installation of the smoke outlet.



This chapter also deals with non-standard installation options. Pipes for non-standard installations are not provided and have to be purchased from your trusted dealer/assistance centre.



The installation, disassembly / reassembly of the appliance must be carried out by qualified personnel authorized by Nobis Srl. Please note that opening the appliance by unauthorized personnel will invalidate the product warranty.

#### CONNECTION TO THE SMOKE EXHAUST SYSTEM (SIDE CONNECTION)

Remove the pre-cut part of the left side casing and remove the top cover. Lift the lid of the pellet loading tank and unscrew the two 2 screws that anchor the left side panel to the product structure. Lift the panel to remove it.

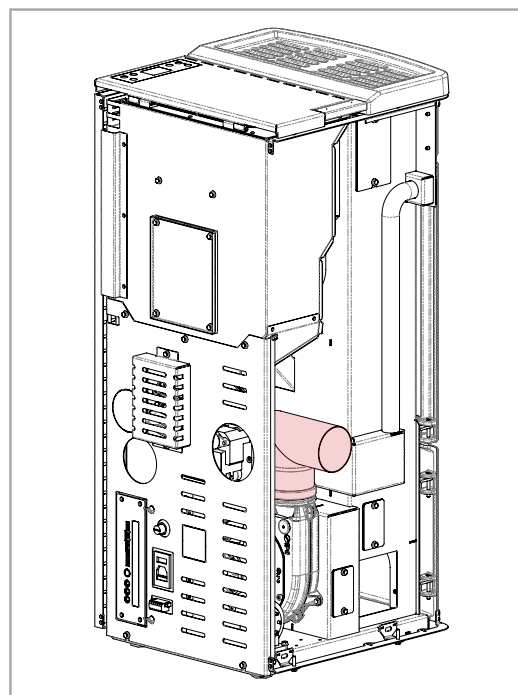

Mount the side casing back into place.

#### CONNECTION TO THE SMOKE EXHAUST SYSTEM (UPPER CONNECTION, N70 TOP COAX only)

Follow the instruction below to install the product with connection on the upper side.

Remove the top cover, lift the lid of the pellet loading tank and unscrew the two 2 screws that anchor the right side panel to the product structure. Lift the panel to remove it.

Unscrew the clamp that holds the corrugated tube to the fixed tube for the combustion air inlet

and unhook the corrugated tube.

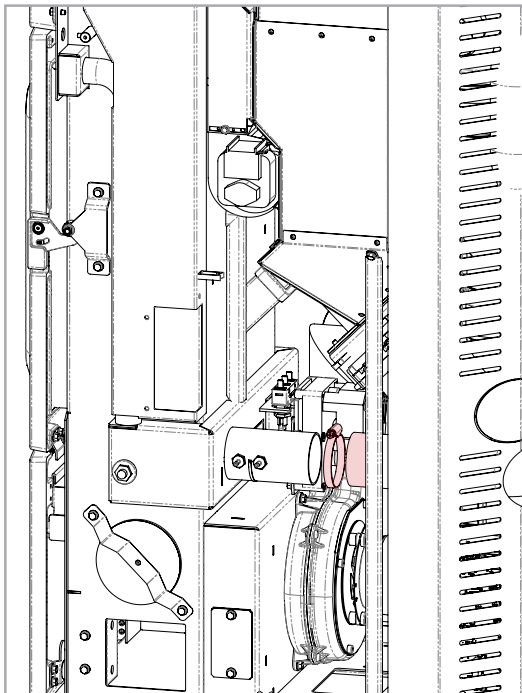

To take air from the room, there is no need to install a tube. In any other case, take a rigid tube (not supplied with the product) and connect it to the combustion air inlet of the product, as shown in the figure below.

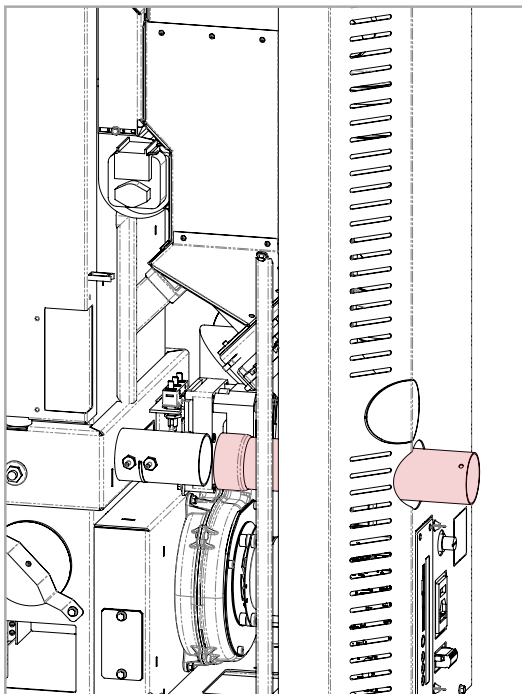

To hide the coaxial inlet of the tube, use the aesthetic cap that you can find in the accessories box (supplied with the product).

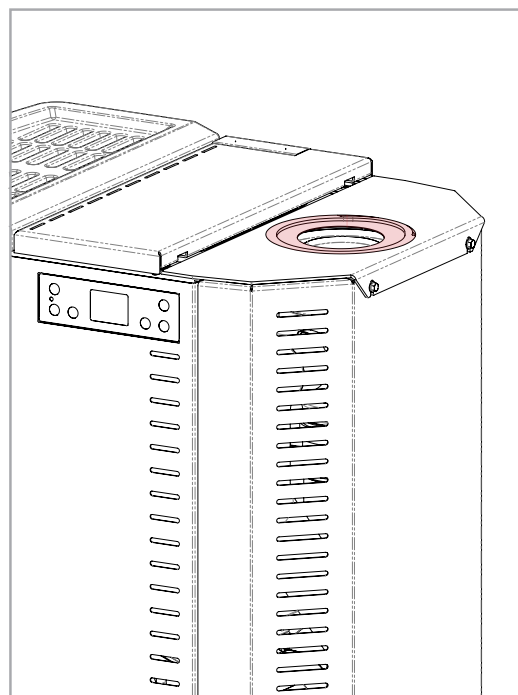

Fit the vertical smoke channel to complete the installation of the product.

### 3.11 INSTALLATION OF THE CANALIZATION KIT

In this chapter you will also find the installation instruction for the **optional** ducting kit, as well as a diagram for disassembling (and reassembling) the appliance covering to place the kit correctly.

#### INSTALLATION OF THE CANALIZATION KIT - OPTIONAL

Remove the top cover, lift the lid of the pellet loading tank and unscrew the two 2 screws that anchor the side panel to the product structure. Lift the panel to remove it.

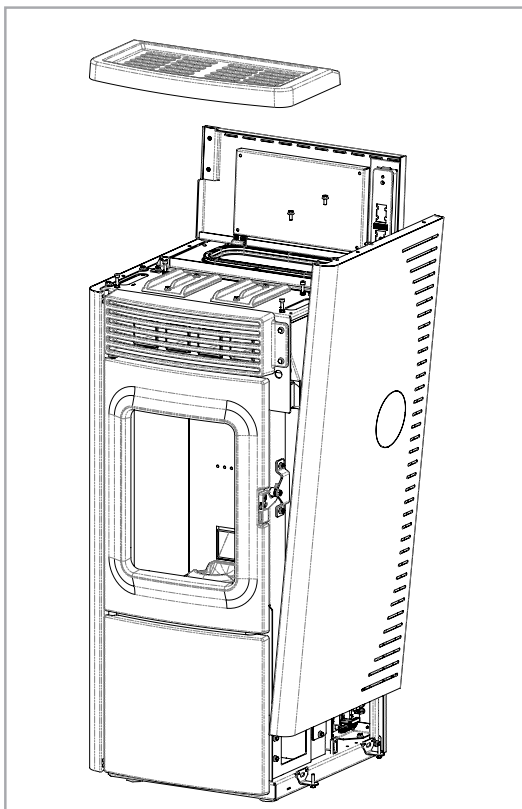

Remove the pre-cut part of the rear casing, insert the ducting kit as shown in the figure, and lock it with the two screws to the side casing.

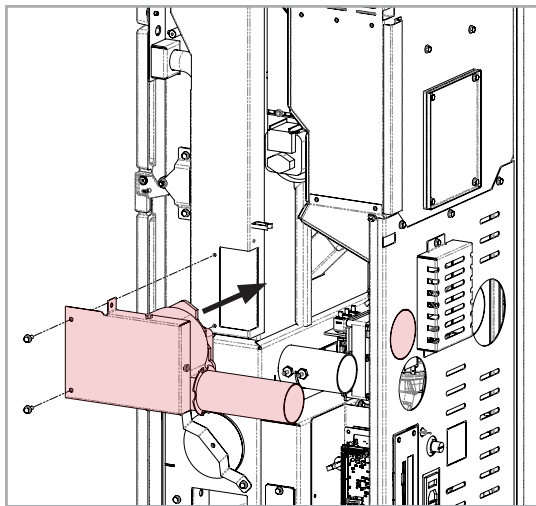

Fix the third screw to permanently secure the ducting kit to the product structure, as indicated in the image below.

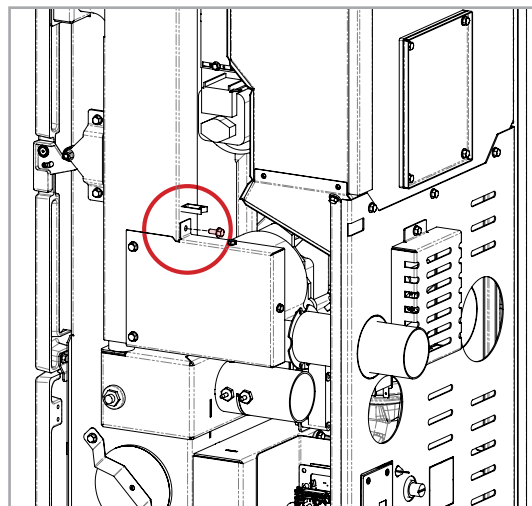

After installing the ducting kit, connect the wires that you find near the ventilation system. Remember to activate the option "single canalization" in the user menu via remote control.

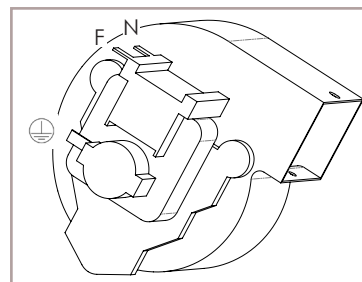

Connect the fan to the power supply using the CANAL extension, supplied with the original wiring of the product. Phase and Neutral can be inverted, unlike the earthing (yellow/green cable) which must necessarily be connected to the fan earthing.

Reassemble the product and, once powered, access USER SETUP > SETTINGS > CANALIZATION and choose SINGLE to activate the ducting menu item (see chapter 13 for further information on the menu entries dedicated to ducting).

### 3.12 ELECTRICAL CONNECTION

The product power cord must be connected only after the complete installation and assembly of the product. The cord must not enter in contact with hot parts and must remain accessible even after installation.

To plug in the product, proceed as follows:

- connect the power cord to the back of the appliance;
- connect the plug of the power cable to the wall socket.

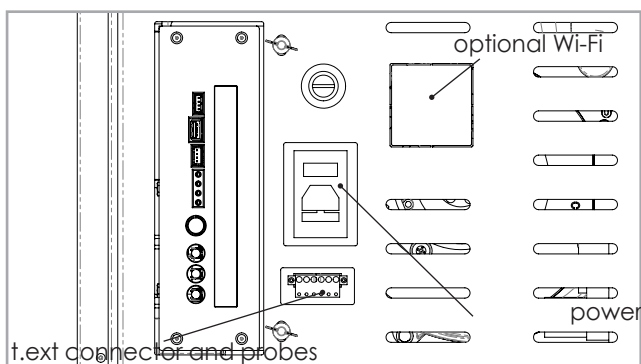

**i** It is possible to connect an external chronothermostat (t.ext) to the appliance for its modulation or switch-on/off combined with the Comfort Clima function. For connection and management of the "external thermostat" and "Comfort Clima" functions, refer to the dedicated chapter in this manual.

**!** It is mandatory that the system is equipped with earthing and a differential switch, as per the laws in force. Also, make sure that the socket is compatible with the type of plug on the power cord used.

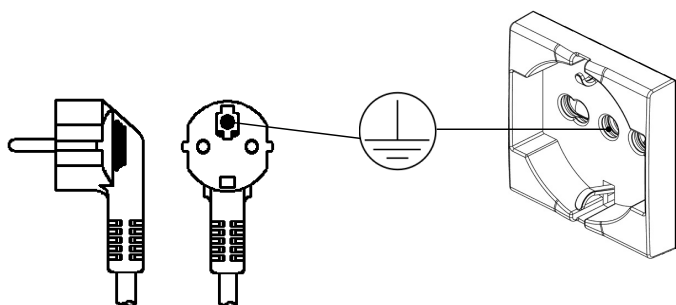

## 4 MAINTENANCE

Maintenance operations, with the exception of ordinary cleaning (see related section in this manual), must be carried out by an authorized technician. Remember to take the following precautions before carrying out any cleaning operation:

- all parts of the product must be "cold";
- make sure that there is no form of combustion (e.g., ash still hot);
- always use protective devices;
- disconnect the plug from the wall outlet;
- once maintenance has been carried out, restore the product, taking care to reactivate all the safety devices.

### 4.1 MAINTENANCE OF THE CHIMNEY SYSTEM

The flue exhaust system must always be clean, as deposits of soot or unburned residues can clog the

section and block the draft, thus compromising proper functioning of the product. Moreover, if present in large quantities, they can catch fire. It is mandatory to have the smoke exhaust system and chimney pot cleaned and checked by a qualified chimney sweep at least once a year or after a prolonged inactivity. At the end of the check/maintenance, get a report certifying that the system is safe.

Neglecting to clean the product may compromise the safety of the system.

## 4.2 PRODUCT MAINTENANCE

To be carried out at least once after each winter or anytime the "Service Hours" notification appears (the message appears on the user interface when the working hours are exceeded, limit beyond which optimal functionality of the product is not guaranteed). During maintenance, the authorized technician will have to do the following:

- clean the smoke duct thoroughly;
- check the tightness of all seals and gaskets;
- remove any pellets residue left in the pellet tank;
- reassemble the appliance in all its parts;
- check proper functioning and combustion.

## 5 PRODUCT TECHNICAL DATA

This chapter provides the end user with all the information relating to the technical data of the product, the dimensions, the installation dimensions and the minimum mandatory distances to be maintained from walls, furniture and possibly flammable objects that can be found in homes.

### 5.1 PRODUCT DETAILS

| PRODUCT DETAILS  |         |         |
|--|---------|---------|
| EU 2015/1186   |         |         |
| Brand  | Nobis   |         |
| Model  | N70 6KW | N70 9KW |
| Energy efficiency class  | A++     | A++     |
| Direct heating output (kW)   | 6.3     | 8.6     |
| Indirect heating output (kW)   | -       | -       |
| Energy efficiency index  | 133     | 131     |
| Useful efficiency (rated pwr. %)   | 94.1    | 92.8    |
| Useful efficiency (reduced pwr. %)   | 94.0    | 94.0    |
| Please observe the warnings, installation procedures, and guidelines for regular maintenance contained in this manual. |         |         |

### 5.2 TECHNICAL FEATURES

| Model                                 | N70 6kW |       | N70 9kW |       |
|---------------------------------------|---------|-------|---------|-------|
|                                       | Reduced | Rated | Reduced | Rated |
| Product weight (Kg)                   | 85      |       |         |       |
| Ø air inlet (mm)                      | 60      |       |         |       |
| Ø smoke outlet pipe (mm)              | 80      |       |         |       |
| Heating max. vol.* (m³)               | 155     |       | 211     |       |
| Input power (kW)                      | 3.2     | 6.7   | 3.2     | 9.3   |
| Output power (kW)                     | 3.0     | 6.3   | 3.0     | 8.6   |
| Yield (%)                             | 94.0    | 94.1  | 94.0    | 92.8  |
| CO with 13% of O <sub>2</sub> (mg/m³) | 162     | 40    | 162     | 16    |
| Tank Capacity (kg)                    | 15      |       | 15      |       |
| Pellet Consumption (kg/h)             | 0.68    | 1.43  | 0.68    | 1.98  |
| Burning time (h)                      | 22.1    | 10.5  | 22.1    | 7.6   |
| Absorbed electrical power (W)         | 260     |       |         |       |
| Power supply (V-Hz)                   | 230-50  |       |         |       |
| Exhaust gas flow (g/s)                | 3.0     | 4.6   | 3.0     | 5.8   |
| Min. draft (Pa)                       | 6       | 12    | 6       | 12    |
| Smoke temperature (°C)                | 89      | 112   | 89      | 142   |

\* this value may vary from the type of energy class of the house and from the type of pellets used.

The data shown are indicative and not binding. Also, they may vary depending on the type of pellets used. The manufacturer reserves the right to make any modifications in order to improve the performance of the products.

### 5.3 PRODUCT DIMENSIONS

#### N70

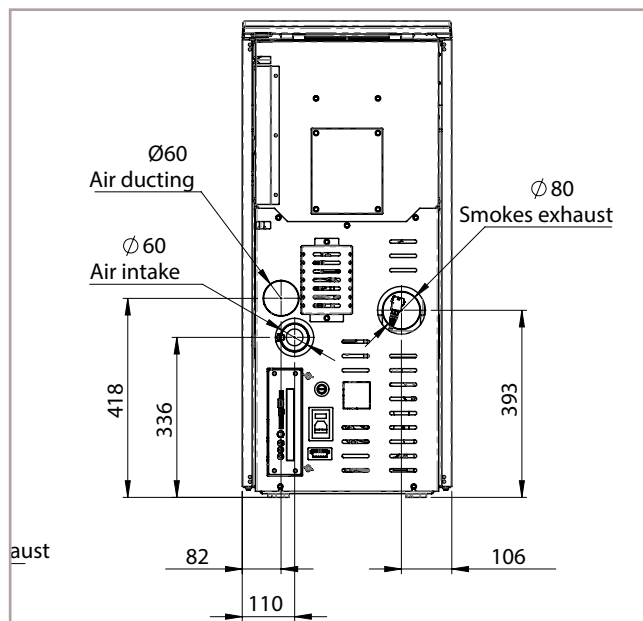
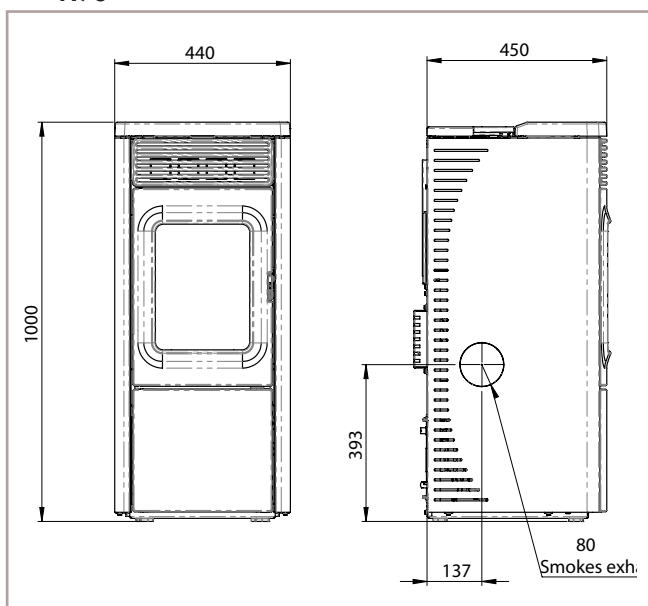

#### N70 TOP COAX

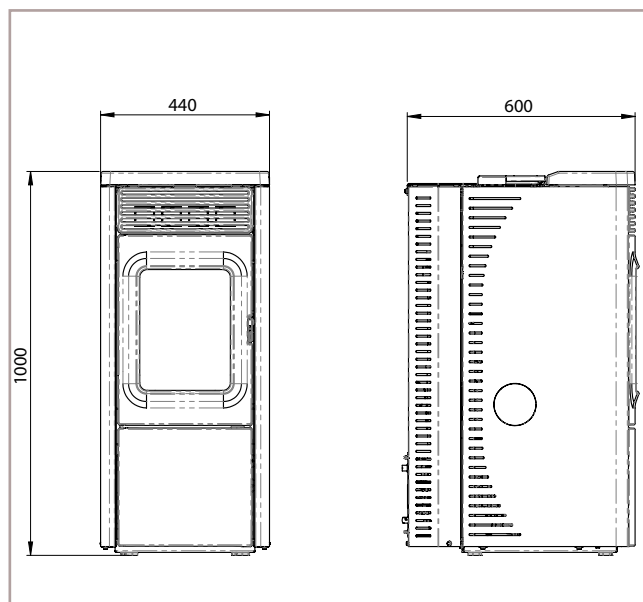

## 5.4 SAFETY DISTANCES

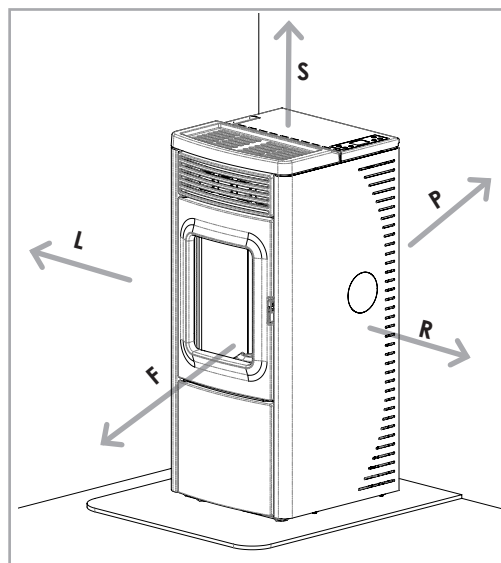
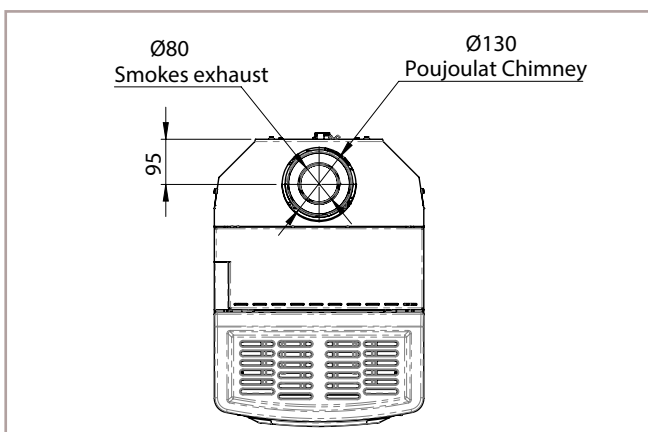
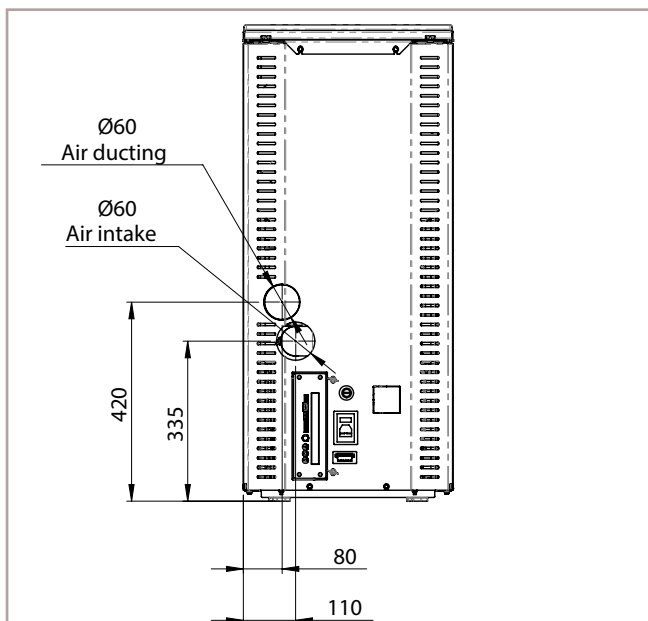

| Minimal distance from flammable materials |            |              |
|---|------------|--------------|
| R   | Right      | 100 mm       |
| L   | Left       | 100 mm       |
| P   | Back       | <b>50 mm</b> |
| F   | Front side | 1000 mm      |
| U   | Upper side | 1000 mm      |



## 6 USER INTERFACE

Once installation instructions has been properly carried out present, including external cladding (where applicable) and electrical connection, access the rear part of the product to power it.

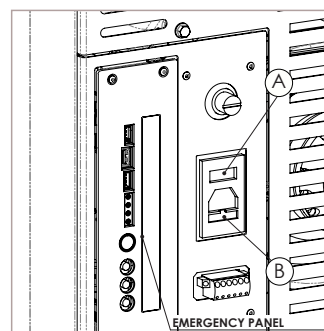

The "I/O" switch - **A** in the figure above - must be positioned on "I". In the event of a power failure, check the condition of the fuse placed in the drawer under the switch - shown as **B** in the figure above - (4A fuse, EU configuration). During periods of non-use, it is advisable to disconnect the power cable from the device and remove the batteries from the remote control.

### 6.1 RECEIVER

The appliance is equipped with a control panel/emergency button (located on the back of the product in most models) to manage the main functions in the event of a fault or malfunction of the remote control.

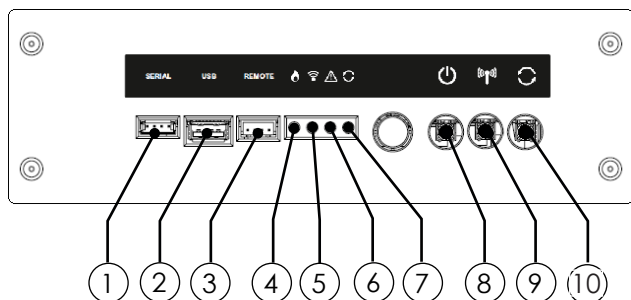

- 1 Serial connection (for authorised staff ONLY)
- 2 USB connection (use by authorised staff ONLY)
- 3 Emergency cable connection
- 4 GREEN LED - appliance operating status
- 5 YELLOW LED - radio communication in progress
- 6 RED LED - alarm active
- 7 BLUE LED - System update in progress
- 8 Appliance on/off button
- 9 Handheld radio receiver pairing button
- 10 Manual update button (For authorized staff ONLY)

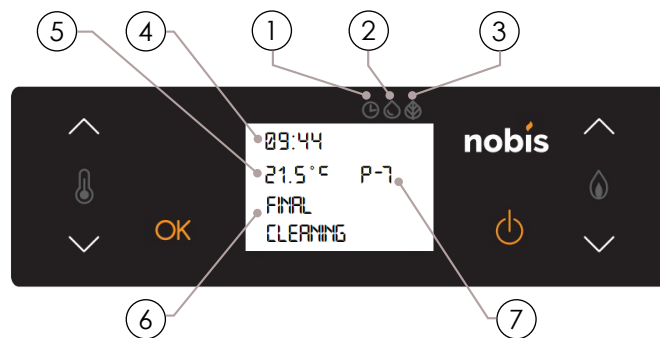

- 1 CHRONOTHERMOSTAT LED active
- 2 ANTICONDENSATION LED active
- 3 PELLET OPTIMIZER LED active
- 4 Clock
- 5 Room temperature
- 6 Display of the machine status.
- 7 Set power level

## 6.2 REMOTE CONTROL: COMMAND KEYS

The screen of the remote control appears as follows:

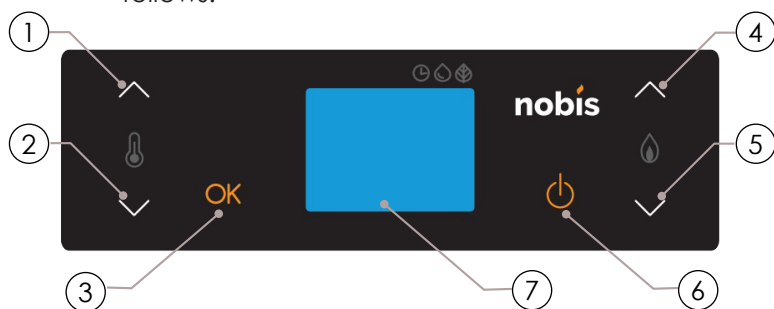

- 1 Increase room temperature
- 2 Decrease room temperature
- 3 Enter / Access menu
- 4 Increase flame power
- 5 Decrease flame power
- 6 Menu exit key / switch on/off key
- 7 Screen

## 6.3 DISPLAY

The screen of the remote control appears as follows:

## 7 MENU BROWSING

To access the menu, press **OK** from the stand-by screen to browse the selection items, as illustrated in below.

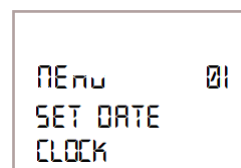

Scroll the menu items on the left side of the display using the keys  $\uparrow\downarrow$

Press  $\uparrow\downarrow$  (on the right of the display) to make changes;

Press **OK** to access the menus or confirm the selection;

Go back to the previous screen by pressing  $\text{⏪}$ ; Below is a practical example on how to browse through the menu with all the selection keys.

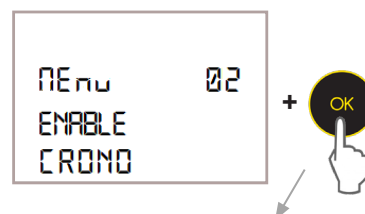
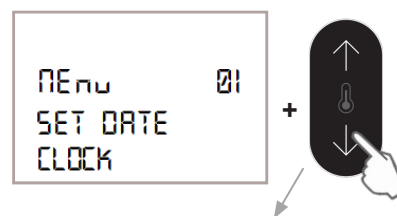

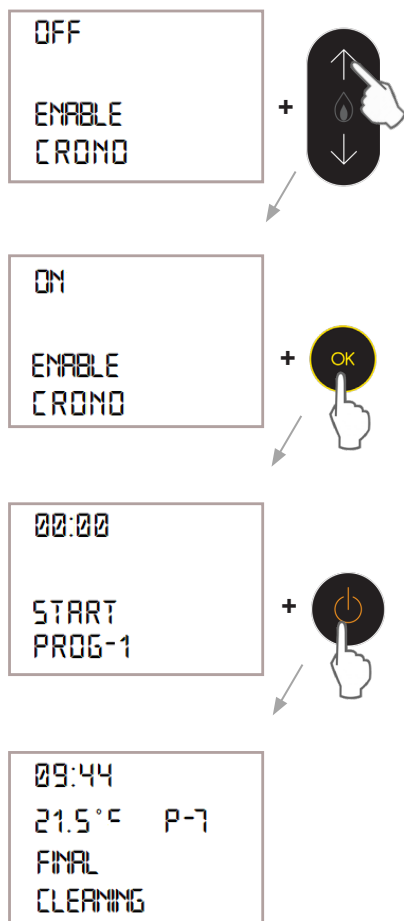

## 8 MENU BROWSING

This chapter highlights a series of operations to be carried out during the first ignition of the product.

### 8.1 PELLET FEEDING

To fuel the appliance, load pellets into the pellet compartment, that you can find on the upper part of the product, by opening the door. When pouring pellets into the tank, ensure that all pellets enter the tank and that no pellets spill over its edges.

Moreover, avoid the following:

- avoid touching hot surfaces with the pellets package during operation or shortly after the stove has been turned off;
- avoid pouring any residual sawdust at the bottom of the pellet bag into the tank.

Load pellets only when the stove is off and cold.

**i** Make sure to close the tank lid properly after loading. FOR SAFETY REASONS, on certain models the closure is controlled electronically. If the lid is not closed correctly, an acoustic signal warns the user to close it as soon as possible. In this case the pellet loading is interrupted. Ignoring the alarm will trigger an alarm.

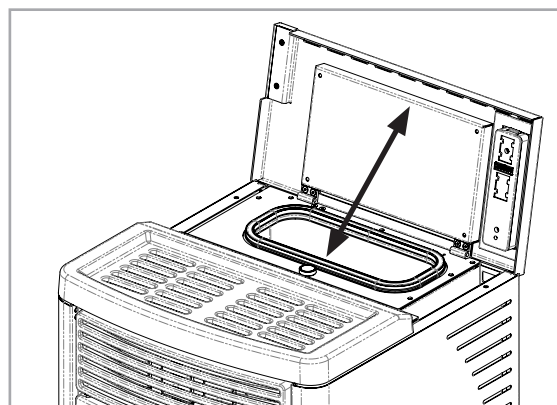

### 8.2 MENU 01 - DATE/HOUR SETTINGS

Below is the procedure to set the date and time. You can use it to create programs via the chronothermostat function available on our products.

OPERATING PROCEDURE:

MENU 01 - HOUR/DATE SETTINGS

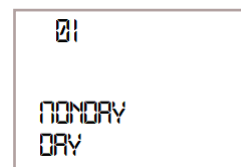

Press **↑↓** (on the right of the display) to make changes;

Press **OK** to confirm the selection;

Repeat the operation to change the calendar.

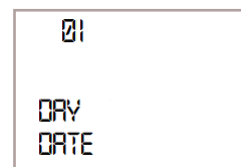

Press **↑↓** (on the right of the display) to make changes;

Press **OK** to confirm the selection;

After confirming the last data, you will be directed to menu 01

Press **⏪** to go back to the main menu.

### 8.3 MENU 10 - ROOM PROBE

The following section outlines the types of sensor that you can use to measure the room temperature.

You have 3 options:

- RADIO probe: you can read the room temperature on the remote control display, as you can use it as an external thermostat.

- T. EXT probe: you can read the room temperature via any other external thermostat not supplied by our company.

ROOMPROBE: you can read the room temperature by using the room probe installed on the product.

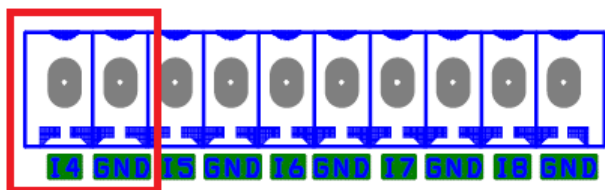

OPERATING PROCEDURE:

MENU 10 - ROOM PROBE

Access this menu to select the type of sensor that you want to use among those outlined above.

Select the type of probe and press **OK** to confirm.

Press to go back to the main menu.



If you select ROOM PROBE, you can calibrate the probe after confirming your selection.

The screen to adjust the room probe will appear, as illustrated in the figure below.

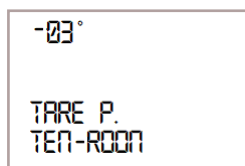

Press (on the right of the display) to make changes;

Example: The reference thermostat displays 21°C while the remote control displays 19°C.

Set +2 to display 21°C on the display.

Press **OK** to confirm.

Press to go back to the main menu.

## 8.4 MENU 04 - AUTO FUNCTION

This function works as follows:

**USER:**

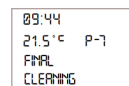

the user can set the desired room temperature and **adjust the operating power** needed to reach it.

**AUTO:**

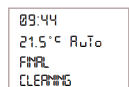

the user simply sets the desired room temperature for the best comfort. The appliance will automatically manage power and ventilation (if present and active) accordingly to reach the set temperature in the shortest time possible.

OPERATING PROCEDURE:

MENU 04 - AUTO FUNCTION

Press (on the right of the display) to activate/deactivate the function;

Press **OK** to confirm.

Press to go back to the main menu.

## 8.5 ROOM TEMPERATURE SETTINGS

This function allows to adjust the temperature in the room where the product is installed.

From the STAND-BY SCREEN, press (on the left of the display) to adjust room temperature.

Press **OK** to confirm, or wait 3 seconds for automatic confirmation.

The values range from 7°C to MAN (MAN stands for MANUAL and it means that, once set, the appliance NEVER switches to eco mode)



It is recommended not to set the temperature on MAN together with the AUTO function, as the product would practically operate at power 7 all the time.

## 8.6 POWER SETTINGS

The power at the hearth defines the quantity of heat produced by the appliance, this implies a different fuel consumption. In practice, this function is used to speed up the time needed to reach the desired temperature where the product is installed.

From the STAND-BY SCREEN, press (on the right side of the display) to adjust the power level.

Press **OK** to confirm, or wait 3 seconds for automatic confirmation.

## 8.7 PRODUCT SWITCH ON/OFF

To turn on the product, hold the button pressed until you will see the screen below, followed by an acoustic signal.

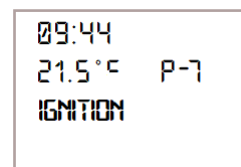

**IGNITION -** Initial pellet-loading phase.

After it, the steps below will follow:

**WAITING FOR FLAME -** Flame-development waiting time.

**FLAME PHASE -** Flame-stabilization phase. Initial load has been completed.

Press and hold the button to turn off the

product and reset any alarms. The operation is accompanied by a sound signal.

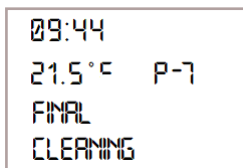

**i** For the models equipped with automatic cleaner, the product activates the brazier cleaning function before IGNITION. In case of NO IGNITION, after pressing , a pop-up message will inform you about the need to clean the brazier before igniting the appliance, so as to avoid dumping any unburned pellets into the ash drawer.

**i** When the stove is running and - above all - during the heating and cooling phases, ticking noises may be heard. These are due to thermal expansion/contraction of the materials due to changes in temperature throughout operation.

**!** When the product is switched on for the first time, unpleasant odours or fumes may be generated due to the evaporation or drying of some of the materials used. Such phenomenon disappears after a few hours of use. During this period, **it is advisable to keep the premises well ventilated.**

## 9 FUNCTIONING

Our products have 7 power levels. Below is a description of the appliance functions available once room temperature has been reached as per settings.

### 9.1 ECO MODE

During operation, the appliance works with the aim of reaching the room temperature as per settings. When this condition has been met, the power is reduced until entering into ECO MODE, a phase in which fuel consumption is minimized.

At this point, it is necessary to explain how you can benefit from the AUTO function switch to ECO mode and/or return to standard operation: the appliance gradually increases the operating power as soon as the temperature in the room drops below the desired level (combustion optimization).

ECO MODE screen:

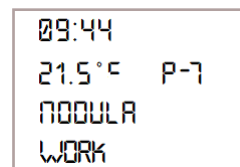



### 9.2 COMFORT CLIMA

As described in the "eco mode" section, the appliance aims to satisfy the user's thermal comfort. If the house has a good energy class, the COMFORT CLIMA function can save fuel by intelligently switching the product on and off. Below is the procedure for activating the function, changing the values with their meaning, and a practical example of setting.

OPERATING PROCEDURE:  
MENU 03 > COMFORT CLIMA

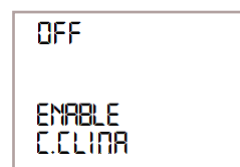
When accessing the menu, the screen to activate this function will appear, as illustrated in the figure below.



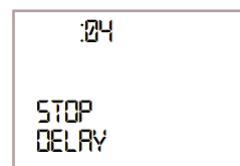

Press  (on the right side of the display) to activate/deactivate the function;  
Press **OK** to confirm the new settings.



Press  (on the right side of the display) to adjust the time you want the product to remain in ECO MODE, before the function turns it off.  
Press **OK** to confirm the new settings.



Press the  keys (on the right side of the display) to set the room temperature value under which you want the product to restart.  
Press **OK** to confirm the new settings.  
Press  to go back to the main menu.

**!** It is recommended to choose at least 2 °C, preferably 3 °C, degrees of difference to turn the

product back on.

#### STATUS SCREEN:

The product will switch off in COMFORT CLIMA mode when the following screen appears <sup>①</sup>.

The product will switch on in COMFORT CLIMA mode when the following screen appears <sup>②</sup>.

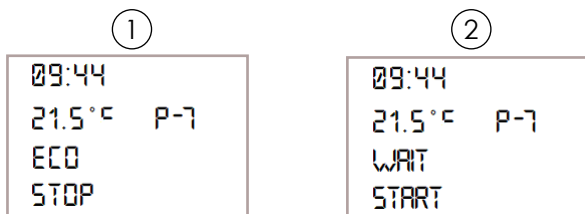

#### PRACTICAL EXAMPLE:

Room temperature set to 21°C;

Eco mode set to 3 minutes;

Set restart value to 2°C lower than the set room temperature.

The product will switch off 3 minutes (eco mode) after room temperature is reached as per settings.

The product will restart as soon as a temperature of 18°C (21°C - 2°C - 0.5°C tolerance) is detected. It is possible to activate this function even if you are using an external thermostat. However, remember that in this case the hysteresis value will not be considered.



In this case, using an external thermostat with an hysteresis value of its own, which can be set up to a maximum of 3°C, is recommended. The appliance could switch on and off several times during the day and this could compromise the life of the glow plug.



The activation of the "Comfort Clima" function could cause the product to switch-on/off several times during the day, especially if the temperatures chosen favour this. This could compromise the life of the ignition resistor, which has a limited warranty.

## 10 "USER SETTINGS" MENU FUNCTIONS

This chapter describes the functions available in the user menu.

These functions aim to improve user comfort and optimize product operation.

### 10.1 MENU 02 - CHRONOTHERMOSTAT

Thanks to the Chronothermostat function, you can program the stove to automatically switch on and off each day of the week by setting up to 4 independent time intervals (PROGRAM 1 - 2

- 3 - 4).

#### OPERATING PROCEDURE:

MENU 02> CHRONOTHERMOSTAT

When accessing the menu, the screen to activate all the time programs will appear, as illustrated in the figure below.

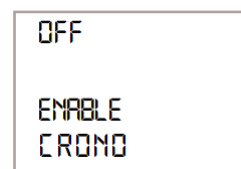

Press **↑↓** (on the right side of the display) to activate/deactivate the function;

Press **OK** to confirm the new settings.

Press **↑↓** (on the left side of the display) to select the program.

Press **OK** to access the program and set the desired values. Press **↑↓** (on the right side of the display) to make changes and then press **OK** again to confirm, as illustrated below.

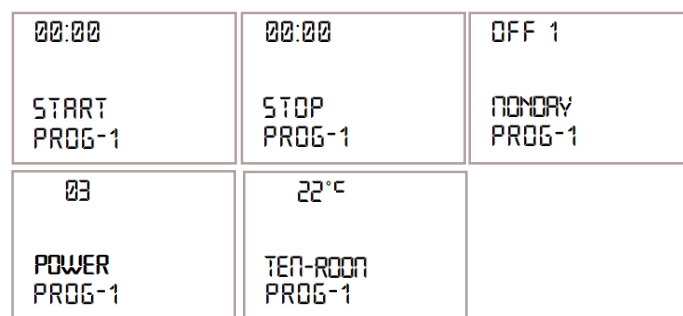

The screens show the options available for each program, e.g., switch on/off time, days of the week when you want the timer to be active.

Press **⏪** to go back to the main menu.

### 10.2 MENU 07 - AUGER LOADING

The following function serves to facilitate the ignition phase of the appliance, correctly filling the loading screw with pellets, before initial commissioning, after an ALARM 03 - pellets exhausted and after each thorough cleaning of the pellet tank (for this (last consult the chapter "Routine maintenance of the product").

Verify that the pellet tank is not empty and that the appliance is "OFF" or in "FINAL CLEANING" status before activating this function.

The number indicates the rotation time of the auger, expressed in seconds, during the loading phase.

Once this time has passed, the auger stops

automatically.



After the initial loading phase, a POPUP appears on the display to remind you to vacuum the pellets from the brazier. This measure PREVENTS the pellets from being poured into the ash drawer when, during the ignition phase, the plate turns upside down (automatic cleaning). The pellets dumped into the ash drawer can catch fire when the stove is operating. This can prevent correct combustion in the brazier and damage the ash drawer.

Always vacuum the brazier using an ash vacuum cleaner. FIRE HAZARD

You can now turn on the device using the display.

#### OPERATING PROCEDURE:

MENU 07 > AUGER LOADING

This function allows you to activate the cleaner<sup>①</sup> (for models equipped with automatic cleaning), before the auger starts loading pellets<sup>②</sup>. The display shows the loading countdown.

①

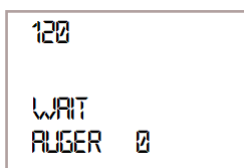

②

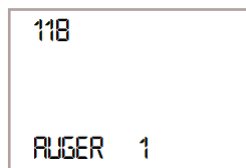

After loading, the appliance moves to the menu item relating to the function.

### 10.3 MENU 06 - PELLET/AIR INTAKE RATIO

The function allows you to safely and in percentage vary the quantity of pellets loaded into the brazier during the work phase and/or the quantity of combustion air sucked into the specific passage usually located on the back of the product.

If necessary, to improve combustion, start adjusting the level of combustion air, increasing or decreasing it according to your needs. If this is not enough, then you can try adjusting the pellet load as well.

Any change in the values is stored in the electronics, so that the user can always check them. Such values are obtained using DIN Plus certified pellets. If you use a different pellet, it may be necessary to act via this menu to optimize combustion.

#### OPERATING PROCEDURE:

MENU 06 > P/A RATIO

When accessing the menu, the following screen will be displayed.

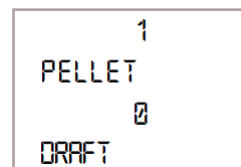

Press  $\uparrow\downarrow$  on the right side of the display to change the pellets load.

The values vary from -5: reduction in pellets load expressed in %

to +5: increase in pellet load in %

Confirm by pressing **OK** and move to aspiration settings.

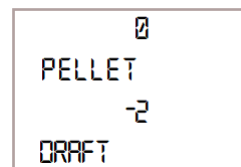

Press  $\uparrow\downarrow$  on the right of the display to change the air intake.

The values vary from -5: reduction of smoke extraction expressed in %

to +5: smoke extraction increase in %

%

Press **OK** to confirm. The screen will automatically go back to the functions menu.

Press  $\text{⏪}$  to go back to the main menu.



Pay particular attention when changing the values in this menu, as the product can be severely damaged.

The example above shows a % decrease of -2 PELLETS and +3 AIR;

such a setting derives from a lack of oxygen in the combustion chamber and by the fact that the pellet size is 2 cm smaller than the average.

### 10.4 MENU 12 - STOVE STATUS

Through the stove status menu it is possible to view a series of information on the operation of the appliance such as: the work phase, the speeds of the main motors and the operating temperatures. Furthermore, if the WiFi module is connected to the stove, you can manage it and check its operating status; see the WiFi manual for further details. This menu is mainly designed for the technical assistance service.

#### OPERATING PROCEDURE:

MENU 12 > STOVE STATUS

When accessing the menu, the following screen will be displayed.

```

PRG 1
1250 RPM
05. ZPA. SET
05. ZPA.

```

```

PRG 2
425° C.SK
189° C.SJ
025° C.SC

```

Press  $\uparrow\downarrow$  (on the right side of the display) to move from screen 1 to screen 3.

Press  $\text{⏪}$  to go back to the main menu.

## 10.5 MENU' 08 - LANGUAGE SETTINGS

Use this menu to select your language. Follow the procedure below to choose the desired language.

### OPERATING PROCEDURE:

MENU 08 > LANGUAGE SETTINGS

When accessing the menu, the following screen will be displayed.

```

ENGLISH
LANGUAGE

```

Press  $\uparrow\downarrow$  on the right of the display to select your language and press **OK** to confirm.

Press  $\text{⏪}$  to go back to the main menu.

## 10.6 FIRMWARE VERSION

This menu is usually reserved for technical service. By using this menu item you can view detailed information about the firmware version installed on the motherboard responsible for operating the device.

### OPERATING PROCEDURE:

MENU 09 > FIRMWARE VERSION

When accessing the menu, the screen with the ducting settings will be displayed, as in the figure below.

```

FILE NBS
ELEMENTO ARIA
/A 0XX

```

Press  $\text{⏪}$  to go back to the main menu.

## 10.7 MENU 05 - ANTICONDENSATION

Once activated, this function guarantees that the flue gas exhaust temperature remains above condensation temperature.

The main cause for condensation in the flue gas exhaust is usually due to the prevalent use of the product at low power levels (P1 or P2). The high levels of efficiency imposed by the current anti-pollution regulations led to a significant reduction exhaust fume temperature, as almost all of the heat produced is exchanged with the environment. Heat exchange contributes to lower exhaust fumes temperature, which is too low to avoid condensation when the fumes are expelled if the product is not used correctly at the rated operational power (that is, P7 or at a slightly lower).

Moreover, failure to comply with the laws for product installation and the use of fuels other than those described in chapter 2 can cause condensation in the flue exhaust as well.



Pay particular attention to any formation of condensation in the exhaust pipe, as it could severely damage the product. In this case, the damages are not covered by the 24-month European warranty on manufacturing defects.



Remember that the anti-condensation system, once activated, only comes into operation when smoke is too cold in the exhaust, protecting the product from possible severe damage.

### OPERATING PROCEDURE:

MENU 05 > ANTICONDENSATION

When accessing the menu, the following screen will be displayed.

```

OFF

ENABLE
FUNCTION

```

Press  $\uparrow\downarrow$  (on the right side of the display) to activate/deactivate the function and press **OK** to confirm.

Press  $\text{⏪}$  to go back to the main menu. When this function is active, a LED lights up on the display in correspondence with the "water drop" symbol that you can find silkscreened on the interface.

## 10.8 MENU 00 - VENTILATION SETTINGS

For models where the front ventilation is always

active, the possibility has been added to deactivate it **ONLY** if the appliance is operating at low power or is in a modulation state, exploiting the natural convection system that guarantees heat supply to the room, in the total absence of noise.

#### OPERATING PROCEDURE:

MENÜ 00 > VENTILATION SETTINGS

Upon accessing the menu, the screen as in the figure below appears.

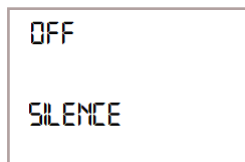

Enable or disable the function with the display right keys **↑↓** and confirm with the **OK** button.



If, during operation in "silence" mode, overheating of the product should occur, the function is temporarily deactivated and the ventilation is switched to maximum speed, showing on the display the message **HOT SMOKE**.

To return to the main menu, press the **⏪**.

## 10.9 MENU 14 - WIFI (WIFI OPTIONAL KIT)

The following menu shows the WiFi connection status, the WPN function for quick connection to your home router (if your router is equipped with a WPN button), as well as the option to reset the module in case of poor connection. Below is the procedure for accessing the menu.

#### OPERATING PROCEDURE:

MENÜ 14 > WIFI

Access the menu and press **↑↓** (on the left side of the display) to select an item, as shown in the image below. Press **OK** to display values or access a specific function.

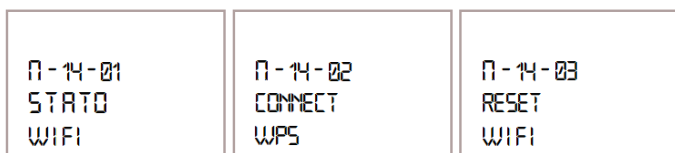

Press **⏪** to go back to the main menu.



Further details about this function are described in the WiFi manual supplied with the product (in case of integrated WiFi), or available in the optional WiFi kit.

## 11 DUCTING (Optional)

If you need to heat a room adjacent to the one where the product is installed, it is possible to install a single ducting kit, even after purchasing the product. Contact your retailer for further information.

### 11.1 SINGLE DUCTING SETTINGS

This paragraph illustrates how to activate/deactive and manually set the speed of the fan used to channel hot air in the ducting system. It also shows how to activate automatic channeling, a function that is linked to the room temperature that you wish to obtain in the room.

#### OPERATING PROCEDURE:

MENÜ 00 > VENTILATION SETTINGS

When accessing the menu, the screen with the ducting settings will be displayed, as in the figure below.

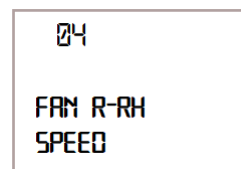

Press **↑↓** (on the right of the display) to adjust fan speed

0 - ventilation deactivated;

1-7 - ventilation settings range;

PS - Ventilation speed follows the product's operating power.



If you don't set the PS function, the fan will always run independently of the device.

Press **OK** to confirm and move to the next settings.

Once the set room temperature has been reached, it is possible to modulate fan speed (in ducted configuration);



Press **↑↓** (on the right side of the display) to activate/deactivate the function and press **OK** to confirm.

If you decide to manage the temperature of the ducted room after activating the function described above,

you must decide whether you want to manage the room temperature with the supplied probe or by using an external thermostat.

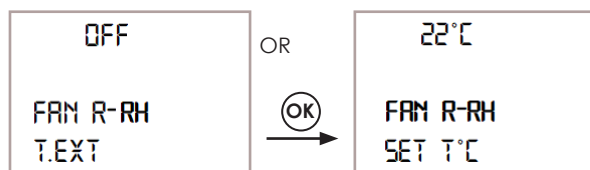

#### EXAMPLE WITH EXTERNAL THERMOSTAT:

Press  $\uparrow\downarrow$  (on the right side of the display) to check/uncheck the mark, if you want to manage the temperature of the area where you want the air to be channeled via an external thermostat (not supplied). Press **OK** to confirm.

#### EXAMPLE WITH ROOM PROBE.

Press  $\uparrow\downarrow$  (on the right side of the display) to adjust the temperature of the area where you want the air to be channeled via an optional room probe (supplied upon request by Nobis).

**i** If you activate the "ducting" temperature management function when the external thermostat is activated, it will no longer be possible to change the temperature of the adjacent room via the remote control, as it will be managed directly by the external thermostat.

## 11.2 PROGRAMMABLE DUCTING

In the SET CHRONO menu, for models equipped with ducting, it is possible to adjust both the ducting power (ventilation speed) and the temperature you want to get in the room where the ventilation outlet is installed. After programming the switch-on/off times of the appliance, the following screens will appear in succession.



Press  $\uparrow\downarrow$  (on the right side of the display) to adjust ducting speed.  
Press **OK** to confirm.

Press  $\uparrow\downarrow$  (on the right side of the display) to adjust the temperature of the ducted room.  
Press **OK** to confirm.

Press  $\odot$  to go back to the main menu.

**i** By setting the room temperature for the ducting, this is managed only if the TEMPERATURE CONTROL function (see above), is activated and ENABLE EXT T. is deactivated in SETTINGS > DUCTING.

## 11.3 DISPLAY DUCTING STATUS

From the STANDBY screen, press  $\uparrow\downarrow$  (on the left of the display) simultaneously to display the ducting status.

Below is the display screen:

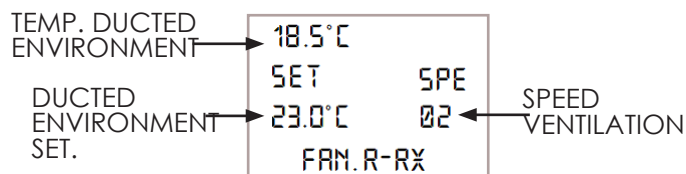

Moreover, the quick function to access the ducting status allows you to do the following:

- adjust room temperature by pressing  $\uparrow\downarrow$  (on the left side of the display).
- adjust fan speed by pressing  $\uparrow\downarrow$  (on the right of the display).

Press **OK** to confirm and go back to the STAND BY screen.

## 11.4 DOUBLE DUCTING SETTINGS

This paragraph illustrates how to activate/deactivate and manually set the speed of the fan used to channel hot air in the ducting system. It also shows how to activate automatic channeling, a function that is linked to the room temperature that you wish to obtain in the room.

#### OPERATING PROCEDURE:

MENU 00 > DUCTING SETTINGS

When accessing the menu, the screen with the right-hand side ducting settings will be displayed, as in the figure below.

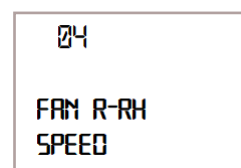

Press  $\uparrow\downarrow$  (on the right of the display) to adjust fan speed

0 - ventilation deactivated;

1-7 - ventilation settings range;

PS - Ventilation speed follows the product's operating power.

Press **OK** to confirm and move to the left-hand side ducting settings.

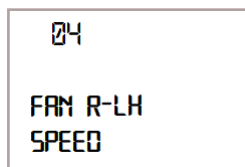

**i** If you don't set the PS function, the fan will always run independently of the device.

Press **OK** to confirm and move to the next settings. Once the set room temperature has been reached, it is possible to modulate fan speed (in ducted configuration);

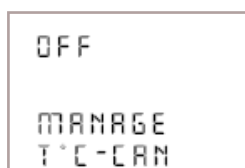

Press **↑↓** (on the right side of the display) to activate/deactivate the function and press **OK** to confirm.

If you decide to manage the temperature of the ducted room after activating the function described above, you must decide whether you want to manage the room temperature with the supplied probe or by using an external thermostat.

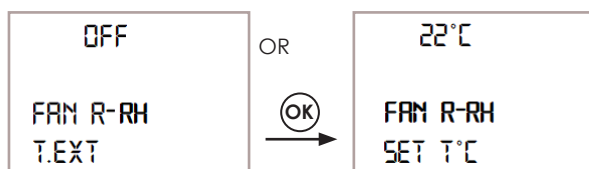

EXAMPLE WITH EXTERNAL THERMOSTAT:

Press **↑↓** (on the right side of the display) to check/uncheck the mark, if you want to manage the temperature of the area where you want the air to be channeled via an external thermostat (not supplied). Press **OK** to confirm.

EXAMPLE WITH ROOM PROBE.

Press **↑↓** (on the right side of the display) to adjust the temperature of the area where you want the air to be channeled via an optional room probe (supplied upon request by Nobis).

After selecting the right-hand side ducting settings, press **OK** to confirm and move to the left-hand side ducting settings.

**i** If you activate the "ducting" temperature management function when the external thermostat is activated, it will no longer be possible to change the temperature of the adjacent room via the remote control, as it will be managed

directly by the external thermostat.

## 11.5 PROGRAMMABLE DUCTING

In the SET CHRONO menu, for models equipped with ducting, it is possible to adjust both the ducting power (ventilation speed) and the temperature you want to get in the room where the ventilation outlet is installed. After programming the switch-on/off times of the appliance, the following screens will appear in succession.

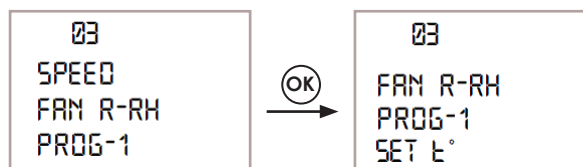

Press **↑↓** (on the right side of the display) to adjust the speed of the right-hand side ducting. Press **OK** to confirm.

Press **↑↓** (on the right side of the display) to adjust the temperature of the ducted room. Press **OK** to confirm and move to the left-hand side ducting.

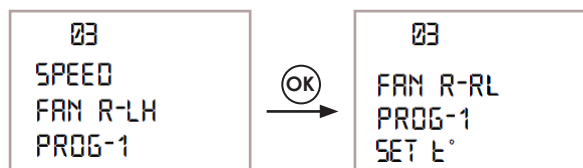

Press **↑↓** (on the right side of the display) to adjust the speed of the left-hand side ducting. Press **OK** to confirm.

Press **↑↓** (on the right side of the display) to adjust the temperature of the ducted room. Press **OK** to confirm.

**i** By setting the room temperature for the ducting, this is managed only if the TEMPERATURE CONTROL function (see above), is activated and ENABLE EXT T. is deactivated in SETTINGS > DUCTING.

Press **⏪** to go back to the main menu.

## 11.6 DISPLAY DUCTING STATUS

From the STANDBY screen, press **↑↓** (on the left of the display) simultaneously to display the status of the right-hand side ducting. Below is the display screen:

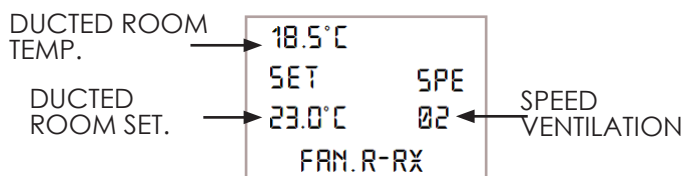

Moreover, the quick function to access the ducting status allows you to do the following:

- adjust room temperature by pressing **↑↓** (on the left side of the display).
- adjust fan speed by pressing **↑↓** (on the right of the display).

Press **OK** to confirm and display the ducting status  
Press **↑↓** (on the left of the display) to adjust room temperature.

- adjust fan speed by pressing **↑↓** (on the right of the display).

Press **OK** to confirm and go back to the STAND BY screen.

| PHASE                 | DESCRIPTION  |
|-----------------------|--|
| <b>RESTART</b>        | Product restart is required after cooling off. Once this condition has been met, the appliance restarts automatically. |
| <b>FINAL CLEANING</b> | The appliance is switching off and it has not fully cooled down yet.   |
| <b>OFF</b>            | The appliance is OFF and all motors are deactivated too.   |

## 12 PHASE OVERVIEW

| PHASE                    | DESCRIPTION   |
|--------------------------|---|
| <b>SWITCH-ON</b>         | - The glow plug starts to pre-heat and pellets start to fall into the brazier.  |
| <b>WAITING FOR FLAME</b> | - The pellet lights up by exploiting the heat of the incoming air that passes through the incandescent resistance duct. |
| <b>FLAME PHASE</b>       | - The stove resumes the pellets loading operation and the flame develops.   |
| <b>FUNCTIONING</b>       | The stove has completed the switch-on phase and starts working according to power settings.                             |
| <b>ECO MODE</b>          | The desired room temperature has been reached.  |
| <b>BRAZIER CLEANING</b>  | The stove activates the brazier cleaning without moving the brazier (periodic function).                                |
| <b>ACTIVE CLEANER</b>    | The brazier is undergoing MECHANICAL cleaning. The appliance turns off and on automatically.                            |



## 13 FUNCTION OVERVIEW



| PHASE | DESCRIPTION  |
|-------|--|
|       | Desired room temperature is set on MAN: the stove always work with the heath power as per settings (NEVER switching to eco mode).  |
|       | The room temperature is managed by means of an external thermostat (not supplied).   |
|       | When Comfort Clima is active, the product switches off automatically as soon as room temperature has been reached as per settings (see specific paragraph).  |
|       | For better comfort, when the AUTO function is active, the stove automatically manages the hearth power, the ventilation (if active) and the ducting (if present and active - optional) to guarantee the best comfort (see specific paragraph). |
|       | The product switches to maximum power to speed up heating.   |

| PHASE               | DESCRIPTION  |
|---------------------|--|
| <b>OPTIMA FLAME</b> | The stove optimizes combustion to guarantee optimal heating while minimizing pellet consumption. |

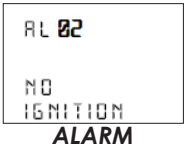
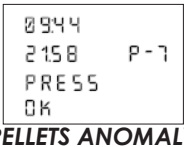
| PHASE                             | DESCRIPTION  |
|-----------------------------------|--|
| <b>FAULTY FLAME-READING PROBE</b> | The product signals a malfunction of the probe that detects the flame temperature. For safety, while waiting for the intervention of a technician, it goes into saving mode. |

## 14 ALERTS OVERVIEW

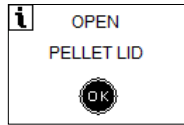
| PHASE   | DESCRIPTION   |
|---|---|
|   | Something triggered and alarm. Consult the "ALARMS" Chapter for further details.  |
|   | The product detects an anomaly but does not shut down. See "ANOMALY OVERVIEW"   |
|  | The service-hour limit has been reached. We recommend that you contact an authorized technician to perform extraordinary maintenance. |

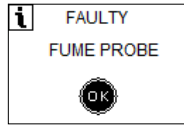
| PHASE  | DESCRIPTION  |
|--|--|
|  | When the user opens the door, the ash drawer or the pellet-tank door, the auger stops loading pellets into the brazier and the stove signals the anomaly with an acoustic signal. Make sure that all the doors are closed to restore normal operation. Otherwise, the product will trigger an alarm. |
|  |  |
|  | Anomaly of the probe controlling the temperature of the exhaust smoke. Contact the authorised technician to solve the problem.   |

**i** **Anomalies** are warnings that reset themselves automatically once the problem has been solved. Press the **OK** to view the type of anomaly. **Alarms** are warnings that, for safety reasons, will cause the heat generator to stop immediately.

## 15 ANOMALY OVERVIEW

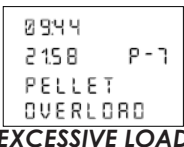
| PHASE  | DESCRIPTION  |
|--|--|
| <b>FAULTY PRESSURE SENSOR</b>  | The product detects a fault with the combustion sensor. For safety reasons, the stove switches to eco mode while waiting for the technician.                             |
|  | The maximum smoke temperature threshold has been reached; the appliance will switch to eco mode with ventilation at maximum power to cool down.                          |
|  | This message appears when the quantity of pellets is excessive for the machine power. In P/A Ratio, reduce the pellet load by acting on the % (see dedicated paragraph). |

**!** To solve some anomalies, technical intervention by authorized personnel is required. Although the appliance continues to function, the user must contact the local technical assistance centre to solve the problem. Ignoring the warning can cause malfunction, even serious, of the product which is no longer covered by the warranty due to negligence on the part of the customer.

## 16 DESCRIPTION OF ALARMS

The stove operation is constantly monitored by **elemento**, the software (firmware) that constantly monitors the safe functioning of the product. When the system detects a fault or incorrect values, for the SAFETY of the user, *the appliance always turns off immediately*. An error code with further details is displayed on the remote control.

**!** To turn the product back on, it is necessary to check the type of problem detected, solve it (use the information in the alarm table below as a reference) to reset the alarm, and then turn the appliance back using the remote control. Long press of the power button (ⓘ). The heat generator carries out a final cleaning cycle

anyway, and then switches OFF before allowing it to be turned back on.

| ALARM CODE   | REASON  |
|--|---|
| <b>01 - BLACK OUT</b>  | The power supply failed while the stove was operating.  |
|  | SOLUTION  |
|  | Check that the power cable is well inserted both in the wall socket and in its socket on the stove, taking care to turn it off with the I/O button before operating.  |
|  | Follow the instructions on the remote control and clean the brazier before trying to start the product. DANGER: MALFUNCTIONING  |
| ALARM CODE   | REASON  |
| <b>02 - NO IGNITION</b>  | Insufficient pellets in the tank or the loading screw was not filled using the appropriate menu before switching on.  |
|  | Change of pellets compared to those used to make adjustments for the start-up of the appliance.   |
|  | The electrical resistor responsible for ignition is defective or not in the correct position.   |
|  | SOLUTION  |
|  | Load the tank and use the filling function of the loading auger before turning the stove back on.   |
|  | Use, insofar as possible, the same type of pellet used for the start-up of the appliance. If this is not possible, contact the Support Service to readjust the values according to the new pellets.   |
| Clean the brazier thoroughly using the ash vacuum cleaner, especially on the right side of the brazier, next to the hole for the electric resistor. <i>Avoid dumping combustion residues into the brazier.</i> |   |
| If the problem persists, and/or to replace the resistor, contact the Authorized Assistance Service.  |   |
| ALARM CODE   | REASON  |
| <b>03 - PELLETS EXHAUSTED</b>  | The pellet tank is empty or else the brazier lacks pellets.   |
|  | SOLUTION  |
|  | Check the tank load and fill it if necessary.   |
|  | In the "P/A Ratio" menu, check that you have not decreased the pellet load too much and that you have not increased the supply of combustion air, distorting the balance of correct combustion. Bring both values back to zero and try again. |
| If the problem persists, contact the Authorized Assistance Service.  |   |
| ALARM CODE   | REASON  |

| <b>04 - SMOKE TEMPERATURE</b>                            | Combustion in the brazier is not optimized due to excess of fuel, dirty smoke passages inside the appliance or incorrect adjustments of the "P/A Ratio" function.                                     |
|--|---|
|  | SOLUTION  |
|  | Turn the product off and on again, actually operating the cleaner; adjust the combustion with "P/A Ratio" starting from Zero.   |
|  | If the problem persists, contact the Authorized Assistance Service.   |
| ALARM CODE   | REASON  |
| <b>05 - SMOKE EXTRACTOR NOT RESPECTING RPMs</b>          | The revolutions of the smoke extractor present a loss of efficiency due to the obstruction of the fan caused by accumulated ash or foreign bodies entering from the chimney, or to a drop in voltage. |
|  | SOLUTION  |
|  | If the problem persists, contact the Authorized Assistance Service.   |
| ALARM CODE   | REASON  |
| <b>06 - FAULTY SMOKE EXTRACTOR</b>                       | No power to the fume extractor.   |
|  | Fume extractor blocked.   |
|  | SOLUTION  |
|  | If the problem persists, contact the Authorized Assistance Service.   |
| ALARM CODE   | REASON  |
| <b>07 - PELLET-LOADING GEARMOTOR NOT RESPECTING RPMs</b> | The speed of the gearmotor presents a loss of efficiency due to a drop in voltage.  |
|  | SOLUTION  |
|  | If the problem persists, contact the Authorized Assistance Service.   |
| ALARM CODE   | REASON  |
| <b>08 - FAULTY PELLET-LOADING GEARMOTOR</b>              | Gearmotor revolution detection system (encoder) not working or not connected correctly.   |
|  | No power to the gearmotor.  |
|  | SOLUTION  |
|  | If the problem persists, contact the Authorized Assistance Service.   |
| ALARM CODE   | REASON  |
| <b>09 - PELLET-LOADING AUGER BLOCKED</b>                 | Possible foreign body or excess sawdust that prevents correct handling.   |
|  | SOLUTION  |
|  | Empty the tank and remove any foreign bodies or excess sawdust accumulation.  |
|  | If the problem persists, contact the Authorized Assistance Service.   |
| ALARM CODE   | REASON  |
| <b>10 - PELLET-LOADING AUGER POWER SUPPLY DEFECT</b>     | No power or no power supplied The electronic control unit is not powering the pellet loading motor completely or correctly.   |
|  | SOLUTION  |
|  | If the problem persists, contact the Authorized Assistance Service.   |

| ALARM CODE                                    | REASON  |
|---|---|
| <b>11 - PASCAL MIN. NEGATIVE PRESSURE</b>     | The sensor does not detect a sufficient minimum depression of combustion air entering the appliance such as to guarantee safe operation.  |
|   | <b>SOLUTION</b><br>Check if the door and ash drawer are closed correctly, check if the combustion air intake pipe (air inlet) is blocked.   |
| ALARM CODE                                    | REASON  |
| <b>12 - FAULTY BRAZIER CLEANER</b>            | The automatic brazier cleaner has not completed its movement and is not in the correct position or the door is not closed correctly.  |
|   | <b>SOLUTION</b><br>Check if the door is closed correctly, reset the alarm and wait for the product to turn OFF. Unplug and plug in the power again system reactivates the cleaner, searching for the correct position again.  |
|   | If the problem persists, contact the Authorized Assistance Service.   |
| ALARM CODE                                    | REASON  |
| <b>13 - NEGATIVE PRESSURE IN CHIMNEY FLUE</b> | The combustion fume evacuation system (smoke channel and flue) are blocked or particular adverse weather conditions have triggered the safety system.   |
|   | The sensor that checks the correct depression of the fume exhaust system does not work correctly.   |
|   | <b>SOLUTION</b><br>Check that the smoke evacuation system (flue) is not blocked: have it checked and cleaned by a chimney sweep or the installer.<br>If the problem persists, contact the Authorized Assistance Service.  |
| ALARM CODE                                    | REASON  |
| <b>14 - THERMOSTAT MANUAL-RESET SWITCH</b>    | The safety thermostat has detected anomalous temperatures in areas where they are not normally reached. For safety, the stove stops after a cooling cycle.  |
|   | <b>SOLUTION</b><br>Eliminate the alarm and reset the thermostat by pressing the button under the plastic cap, after the stove has cooled.   |
|   | Check that all parts of the stove with ventilation and ventilation grills are not obstructed and/or the appliance respects the minimum distances from objects, especially the rear distance.<br>If the problem persists, contact the Authorized Assistance Service. |

Position of the manual reset thermal switch

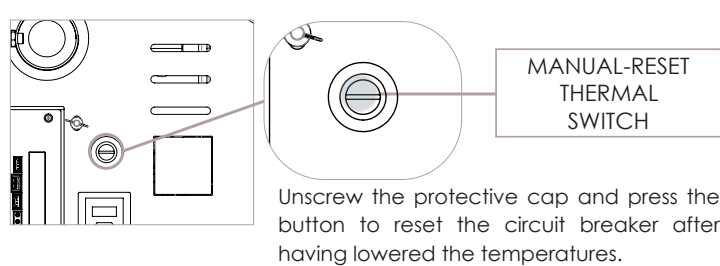

| ALARM CODE                    | REASON  |
|-------------------------------|---|
| <b>15 - ASH DRAWER OPEN</b>   | Either the fire door was not closed correctly or else the ash drawer was forgotten open, or closed incorrectly while cleaning the product.  |
|                               | <b>SOLUTION</b><br>Check the correct closure and/or the correct insertion of the ash pan in its housing.<br>If the problem persists, contact the Authorized Assistance Service.   |
|                               | ALARM CODE  |
| <b>18 - FLAME PROBE</b>       | Simultaneous failure of the flame temperature and smoke temperature reading probes.   |
|                               | <b>SOLUTION</b><br>Contact the Authorized Support Service.  |
| ALARM CODE                    | REASON  |
| <b>22 - FLAME TEMPERATURE</b> | An obstruction in the brazier or in the internal passages of the appliance is hindering proper combustion. This may be due to the use of pellets other than those recommended;  |
|                               | <b>SOLUTION</b><br>Turn the product off and on again to activate the cleaner; adjust combustion with "P/A Ratio".<br>If the problem persists, contact the Authorized Assistance Service.  |
|                               | ALARM CODE  |
| <b>23 - AUGER TRIAC</b>       | Anomaly in a component inside the electronic board that manages the loading motor or the automatic mechanical cleaner.  |
|                               | Possible voltage drops or incorrect input voltage to the appliance or lack of earthing in the home's electrical system or in the socket to which the appliance is connected.  |
|                               | <b>SOLUTION</b><br>Have the power supply voltage checked by a trusted electrician. Try turning the plug in the wall socket to reverse Phase and Neutral - if this fixes it indicates problems with the earthing.<br>If the problem persists, contact the Authorized Assistance Service. |
| ALARM CODE                    | REASON  |

|                                  |   |
|----------------------------------|---|
| <b>24 - AUGER PHASE</b>          | Erratic voltage detected between the electronic board and the loading/cleaning gearmotors.  |
|                                  | <b>SOLUTION</b>   |
|                                  | Have the power supply voltage checked by a trusted electrician. Try turning the plug in the wall socket to reverse Phase and Neutral - if this fixes it indicates problems with the earthing. |
| <b>ALARM CODE</b>                | <b>REASON</b>   |
| <b>28 - FAULTY SMOKE ENCODER</b> | The sensor that checks the correct functioning of the fume extractor has failed or the signal no longer reaches the electronic board.   |
|                                  | <b>SOLUTION</b>   |
|                                  | If the problem persists, contact the Authorized Assistance Service.   |
| <b>ALARM CODE</b>                | <b>REASON</b>   |
| <b>29 - CLEANING CYCLE LIMIT</b> | The maximum limit of automatic brazier cleaning cycles allowed during a prolonged work phase has been reached.  |
|                                  | <b>SOLUTION</b>   |
|                                  | Safely, vacuum the brazier and light it again.  |
|                                  | If we are at the end of the winter season, even if the hours of use before the "service" signal have not yet been reached, the stove requires thorough cleaning.                              |
|                                  | If the problem persists, contact the Authorized Assistance Service.   |

## 17 PRODUCT CLEANING

**!** The installation must guarantee easy access to all parts of the generator and to the combustion smoke evacuation system, in case of extraordinary maintenance and any repair work.

**!** Please carefully follow the instructions provided in this chapter to carry out correct routine cleaning and keep the generator functioning and in good condition. Failure to carry out maintenance could cause operating problems, even serious ones, not covered by the warranty.

Before cleaning the appliance, **it is mandatory** to take the following precautions:

- turn off the product, wait for the OFF status, press the **I/O** button to turn off the power supply and disconnect the power cable;
- check that all parts are cool to the touch;
- verify that the combustion ash is completely cold and does not still hide any burning embers.

To clean surfaces on painted metal parts, use a

soft damp cloth and a little neutral soap. Never spray a detergent directly on the stove: always spray it on a damp cloth in small amounts. The use of harsh detergents or thinners will damage to the product aesthetic surfaces. Such damage is not covered by the 24-month European warranty on manufacturing defects.

### 17.1 FIRE COMPARTMENT CLEANING

Open the door and:

- vacuum the grate;
- vacuum the brazier thoroughly;
- vermiculite does not require cleaning as the action of pyrolysis during combustion eliminates all carbon deposits. In any case, to remove soot particles, only use a soft brush.
- With the same soft brush, and always being very careful, it is possible to also clean the probe that detects the flame temperature, **WITHOUT FORCING IT**, to keep it efficient.

OPERATING PROCEDURE:

Mount the door lever in its specific slot and turn it upwards to open the door.

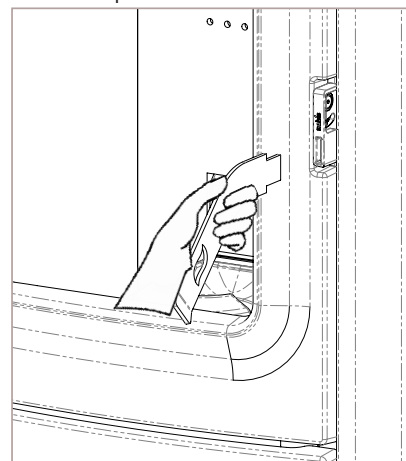

To remove the flame trap, lift it slightly as shown in the image below:

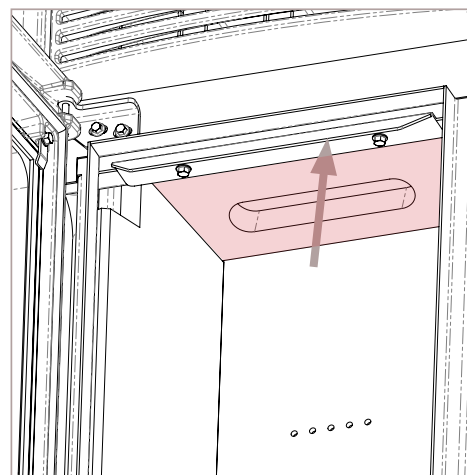

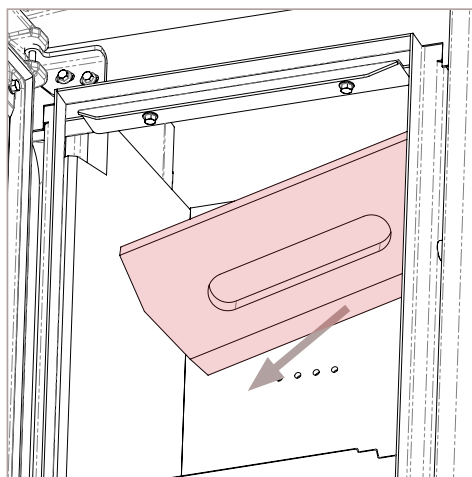

With a soft brush, remove the combustion dust from the vermiculite and the tube bundle (which is made visible by the removal of the fire door), dumping it onto the grate.

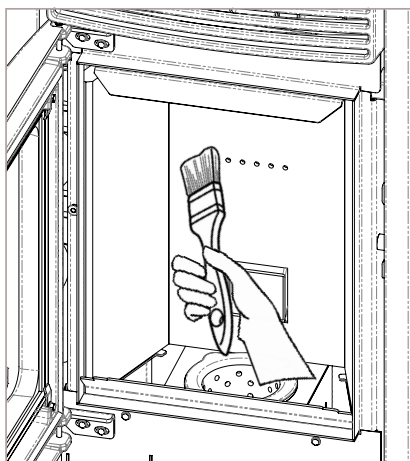

Vacuum both the grate around the brazier and the brazier (you do not need to do it if the product is equipped with the automatic cleaner), being careful not to hit the vermiculite with the nozzle of the vacuum cleaner to avoid any damage.

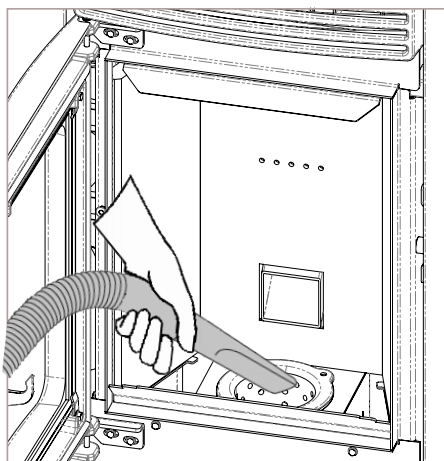

## 17.2 CLEANING OF THE DOOR GLASS

Before cleaning the glass, carefully remove the

ash deposited in the gaps between the door and glass with an ash vacuum cleaner.

It is recommended to *always clean the glass when cold*, using a soft cotton cloth moistened with a little water and combustion ash (which has an abrasive function): avoid as much as possible the use of products with additives which could, over time, deteriorate the seals, the glass and the painted parts. Above all, never spray the product directly on the glass: spray it on the cloth and then clean the glass.



Do not turn on the appliance if you notice any damage to the glass.  
Contact the Service Centre for replacement.

### OPERATING PROCEDURE:

clean with a soft cotton cloth as shown in the figure below.

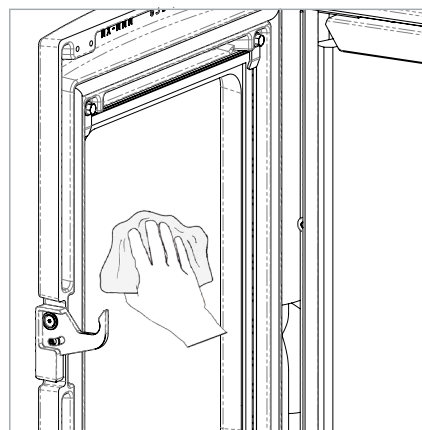

## 17.3 CLEANING OF THE ASH PAN

Remove the drawer from the appliance and remove the deposited ash using an ash vacuum cleaner; pay close attention to the presence of still hot embers which could damage the appliance used for cleaning.

The frequency of cleaning operations depends on the quality of the pellets used and the hours of daily use of the product. There may be a need to vary the number from that recommended in this manual.

### OPERATING PROCEDURE:

Open the door, as explained above and, using the handle of the drawer, release it, as shown in the figure.

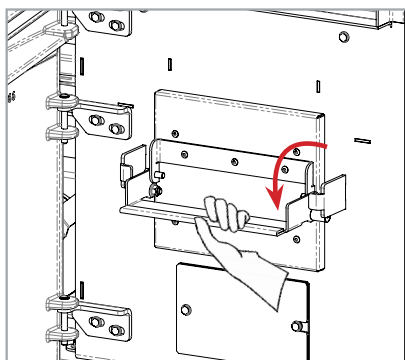

Remove and empty the ash drawer.

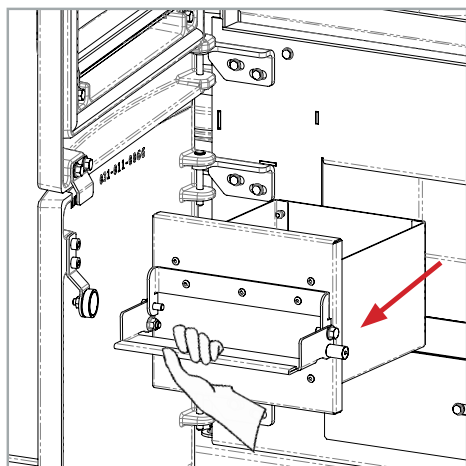

During this phase, pay particular attention, as the embers keep burning beneath the ash for several hours: *risk of fire in the ash vacuum cleaner and/or burns.*

#### 17.4 CLEANING OF THE PELLET TANK

We recommend to clean the bottom of the pellet tank to eliminate the sawdust that is physiologically created by loading the fuel over and over again (see the ideal cleaning frequency in the specific section of this manual).

We recommend to let all the pellets finish in the hopper: at that point it will be possible to vacuum the bottom using an ash vacuum cleaner. If you want to recover the few pellets left, just remember to clean the ash vacuum cleaner before the operation and then sift what has been vacuumed.

Cleaning the tank on a regular basis prevents possible malfunctioning of the loading auger and subsequent machine downtimes.



At the end of the season it is mandatory to empty the pellet tank, thoroughly vacuum any the sawdust and, taking advantage of the "auger first load" function, empty the auger from any pellets left in it. This is to prevent the pellets from absorbing humidity during the summer season. Humid pellets can flake apart and clog the auger.

#### OPERATING PROCEDURE:

Let the pellets finish in the tank and consume as much as possible. Vacuum up all the dust and sawdust (see examples of a tank with a dirty bottom compared with a clean one below).

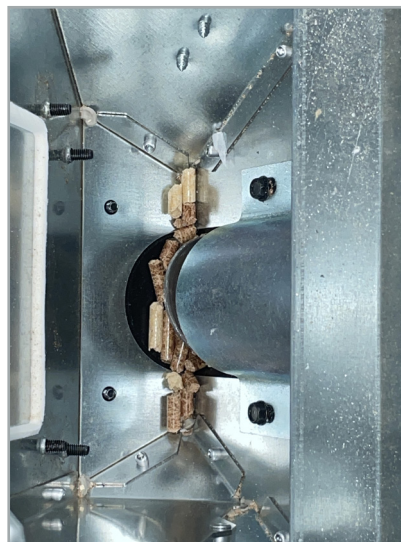

#### 17.5 MAINTENANCE TIMETABLE

The following table summarizes the types of ordinary interventions, which can/must be carried out by the user, and extraordinary ones which must *only* be carried out by qualified personnel authorized by the manufacturer (during the warranty period).

| PARTS                         | FREQUENCY |
|-------------------------------|-----------|
| Ash drawer (suggested period) | 7 DD      |

| <b>PARTS</b>                           | <b>FREQUENCY</b> |
|--|------------------|
| Glass                                  | <b>2-3 DD</b>    |
| Combustion chamber                     | <b>2-3 DD</b>    |
| Cleaning the bottom of the pellet tank | <b>30 DD</b>     |
| Smoke extraction duct*                 | <b>1 SE</b>      |
| Door / ash drawer seal*                | <b>1 SE</b>      |
| Smoke exhaust system*                  | <b>1 SE</b>      |
| Electromechanical components*          | <b>1 SE</b>      |

**LEGEND:**







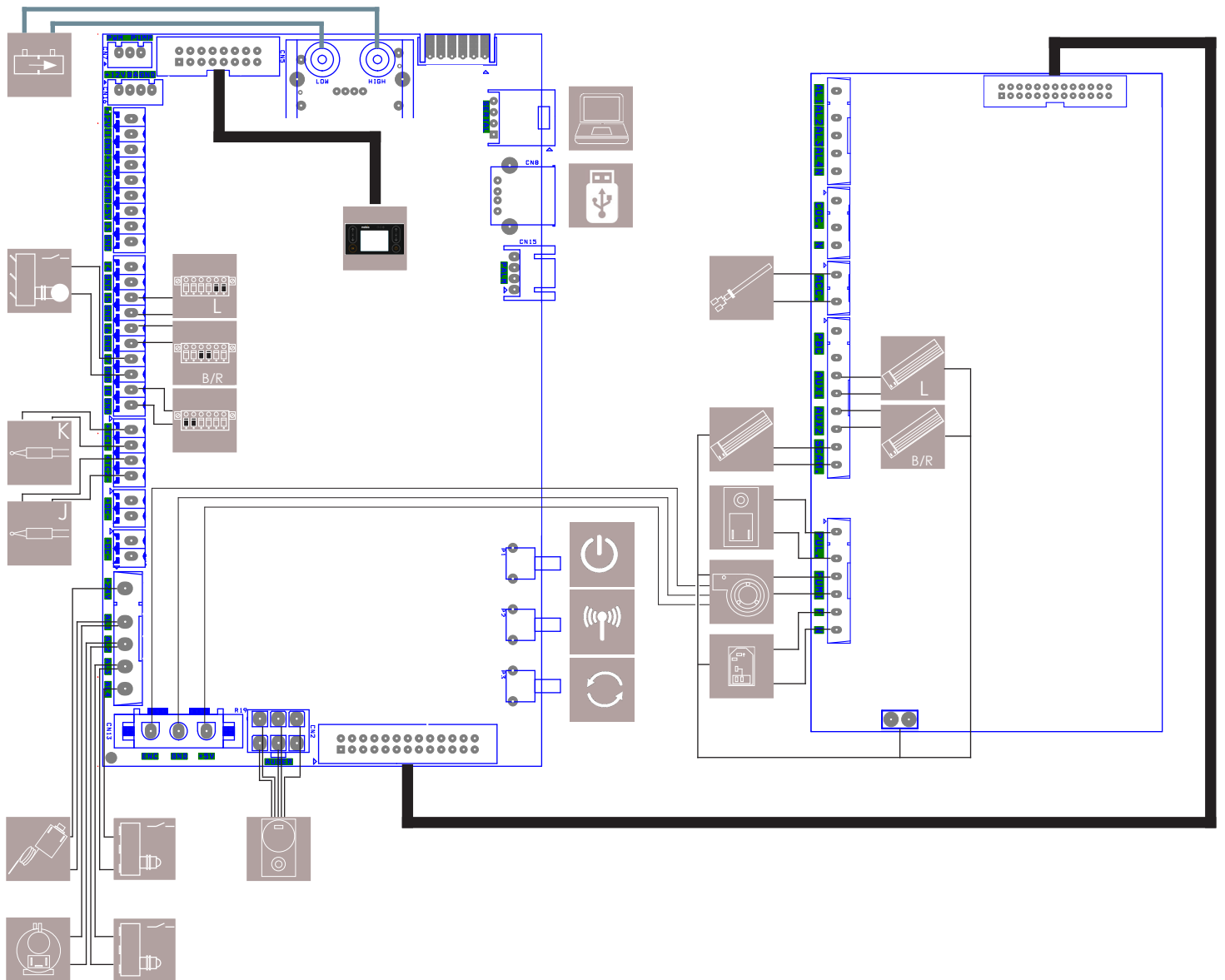















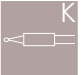

|            |   |
|------------|---|
| <b>*</b>   | operations that must be carried out by a qualified technician authorized by the manufacturer. |
| <b>dd.</b> | days  |
| <b>SE</b>  | seasons   |

The legislation provides the possibility for the user to contact his trusted technician rather than the authorized technician, who must in any case be authorized for legal purposes, who will assume all responsibilities relating to the intervention carried out, after the warranty period of 24 months on manufacturing defects.

# 18 WIRING DIAGRAM



LEGEND:

|  |   |  |  |
|--|---|--|--|
|  PRESSURE SENSOR                             |  SMOKE EXTRACTOR                                   |  SAFETY VACUUM SWITCH                       |  RADIO UNIT BUTTON  |
|  STROKE COUNTER<br>MECHANICAL CLEANER        |  RESET THERMAL<br>MANUAL                           |  VENTILATION<br>FRONT SIDE                  |  FW UPGRADE BUTTON<br>(technical support only)                  |
|  TERMINAL BOARD<br>CONNECTION<br>EXTERNAL T. |  GLOW PLUG<br>SWITCH-ON                            |  PC CONNECTION<br>(technical support only)  |  VENTILATION<br>BACK OR RIGHT<br>B/R                            |
|  K<br>FLAME PROBE                            |  GEARMOTOR<br>MECHANICAL CLEANER                   |  USB CONNECTION<br>(technical support only) |  TERMINAL BOARD<br>BACK PROBE OR EXT T.<br>OR BACK-RIGHT<br>B/R |
|  J<br>SMOKE PROBE                            |  DOOR/ASH DRAWER<br>CONTACT (1)<br>PELLET TANK (2) |  6-KEY DISPLAY                              |  VENTILATION<br>REAR LEFT<br>L                                  |
|  GEARMOTOR<br>BLDC 24V                       |  PRESA 220V CON<br>INTERRUTTORE ON/OFF<br>AND FUSE |  APPLIANCE SWITCH-ON<br>KEY                 |  TERMINAL BOARD<br>CONNECTION<br>PROBE OR T.EXT L<br>L          |









**NOBIS Srl**

Via Aldo Kupfer, 31  
25036 - Palazzolo s/O - BS  
[www.nobisfire.it](http://www.nobisfire.it)

Nobis Srl cannot be held in any way liable for any errors in this manual and considers itself free to change the features of its products without prior warning.