

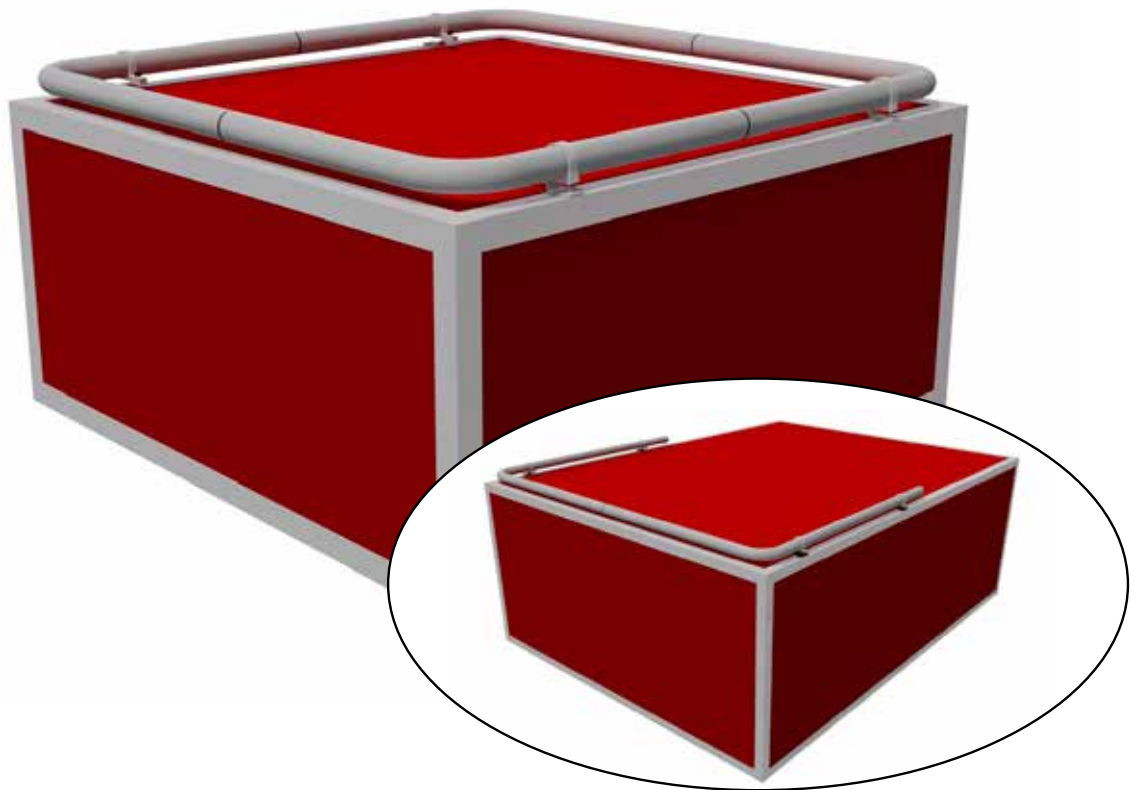

T-RACK MAXI FLEX L3200 x B2400mm (max) RUND & HALV

Art nr: TM92000 & TM92001
Monteringsatts: 93430 & 93483



Installation

Monteras med blindnit eller genomgående bult beroende på valt fäste (ingår ej i grundprodukt).



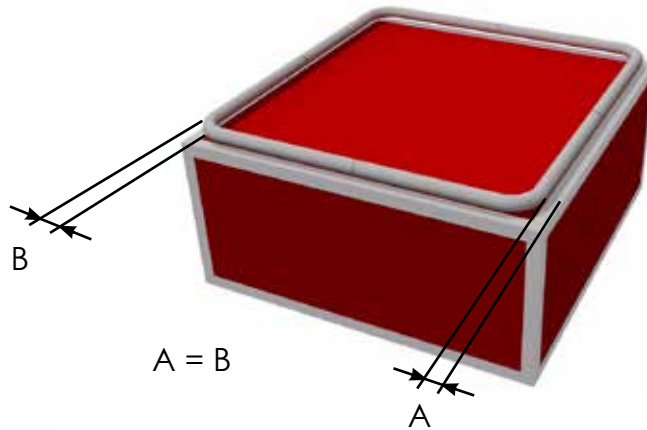

Fäste för skåp - art.nr: 98530

Alt.

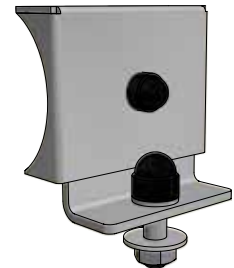

Fäste Universal - art.nr: 98520

Ø4,8mm (12x)

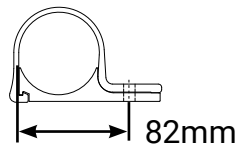
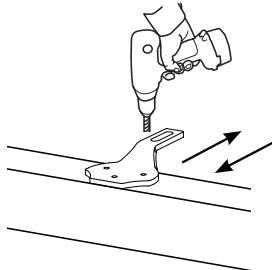

! Mät in
Beroende på bredd
hamnar fästet
olika långt in på
alu profilen

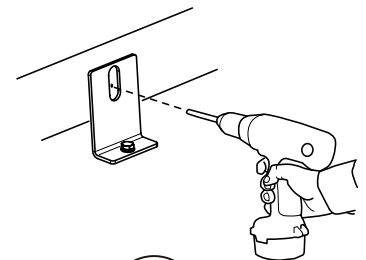

Alt. höjd:
0, 1 eller 2st

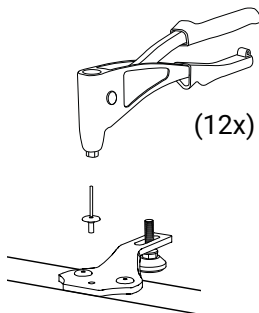
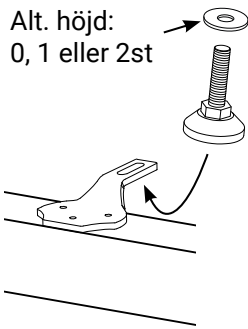

(12x)

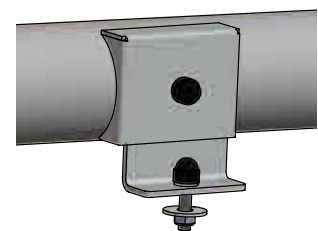
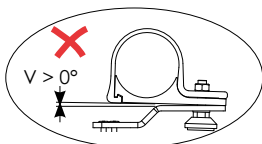
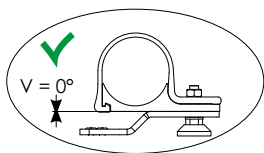
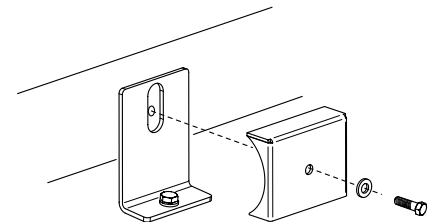
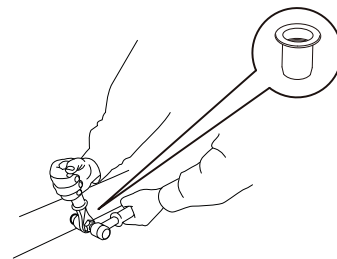

HALV
BF-2

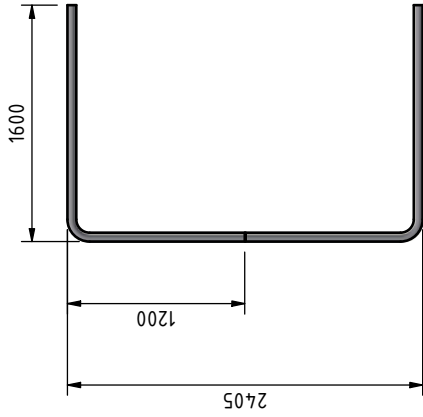

HEL
BF-1

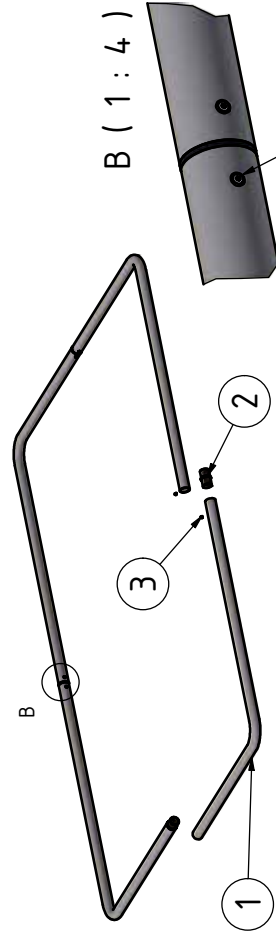
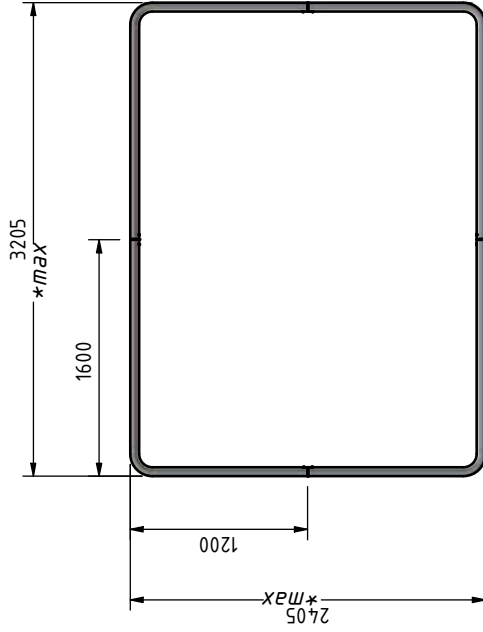

3	8	MRT TT M5x10	5x10	34235
2	4	Aluskarv	Ø60 x 6	100790
1	1	T-rack Maxi Flex	BF-152	
Pos	Ant	SMST	Titel	Artikel nr./Referens

TILLBEHÖR FÖR MONTAGE PÅ SKÅP/TAK
(INGÅR EJ I TM92000 & TM92001, KÖPS SEPARAT):

Art.nr: 98530

Förflyttning av rör
från grundposition:

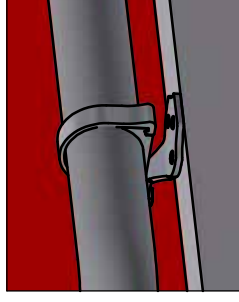
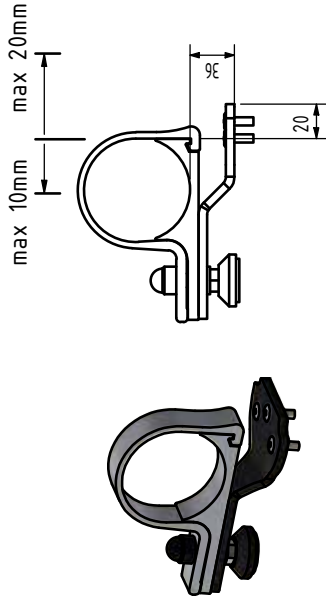

Art.nr: 98520

Förflyttning av rör
från grundposition:

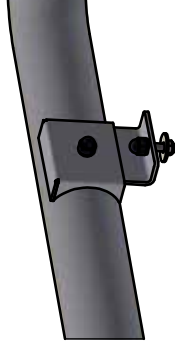
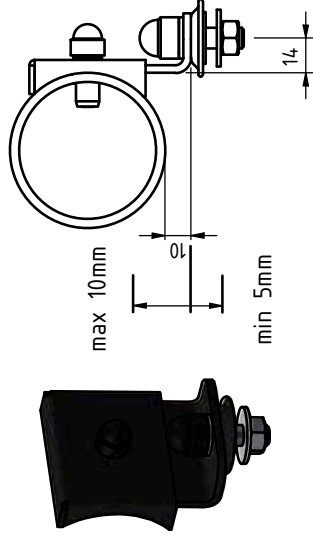

*Vinkel kan vändas
in under bågen

Nr	Ant	Ändring	Datum	Godk.
B		Rund & Halv	2023-03-07	

Konstr.	Ritad	Kop.	Kontr.	Stand.	Godk.	Skala	Ersätter	Ersatt av
JNO	JNO					1 : 35		
<small>Där ej annat anges, gäller SS/ISO 2768 - C och SMS 723 - B. Svarskvalitet för sveats enligt SS - ISO 5817 nivå C.</small>								
			T-RACK Maxi Flex Rund & Halv L3200xB2400 max			Filnamn 93430.idw Datum 2020-01-22		
						Art. nr 93430		Rev B
<small>Tel +46 (0)851-760-460 email:info@qpax.se</small>								