



T-RACK MAXI FLEX RUND & DESIGN

Art nr: TM92100 & TM92100-1
Monteringssats: 93526



Installation

Monteras med blindnit eller genomgående bult beroende på valt fäste (ingår ej i grundprodukt).



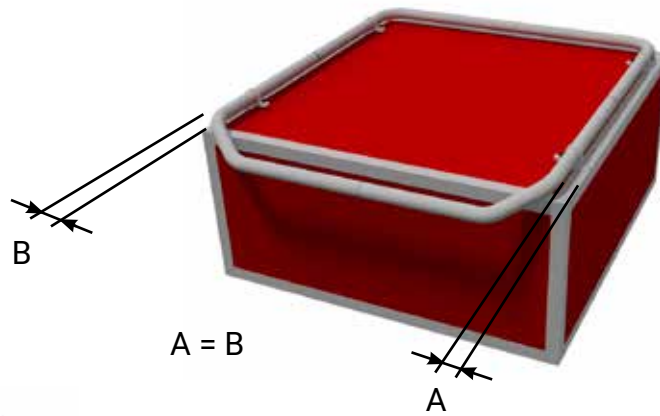

Fäste för skåp - art.nr: 98530

Alt.

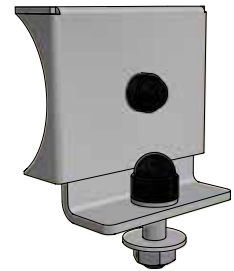

Fäste Universal - art.nr: 98520

Ø4,8mm (12x)

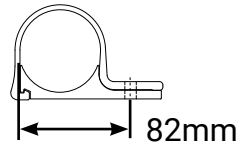
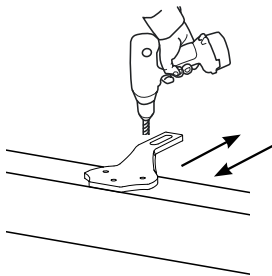

! Mät in
Beroende på bredd
hamnar fästet
olika långt in på
alu profilen

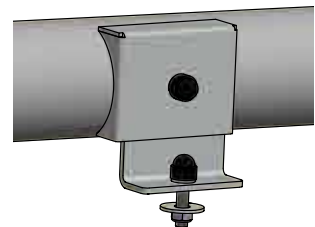
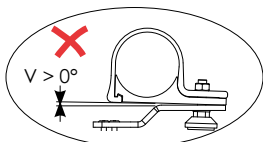
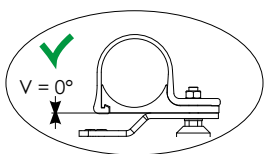
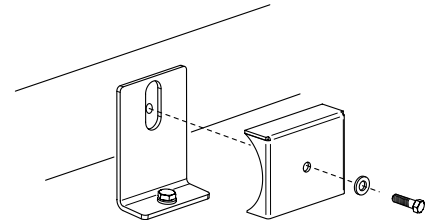
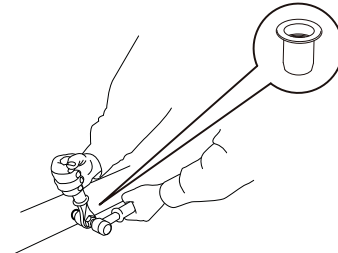
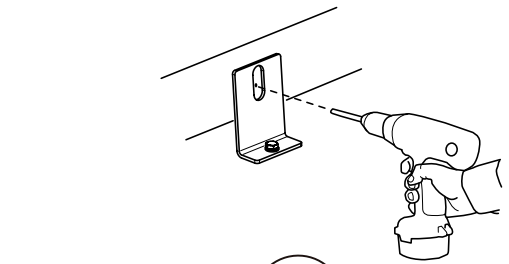
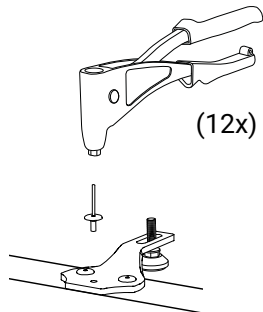
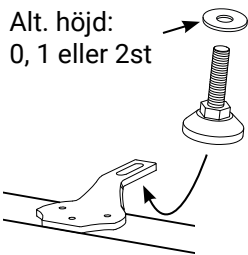

RUND
BF-4

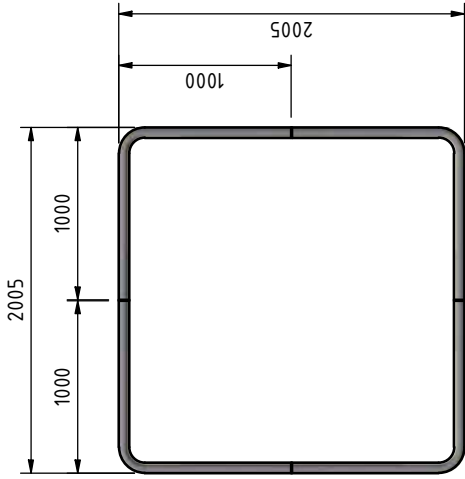

DESIGN
BF-3

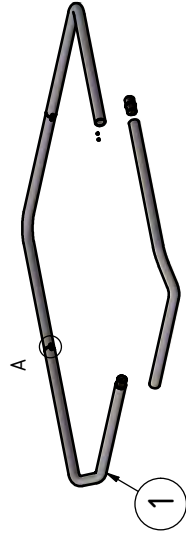
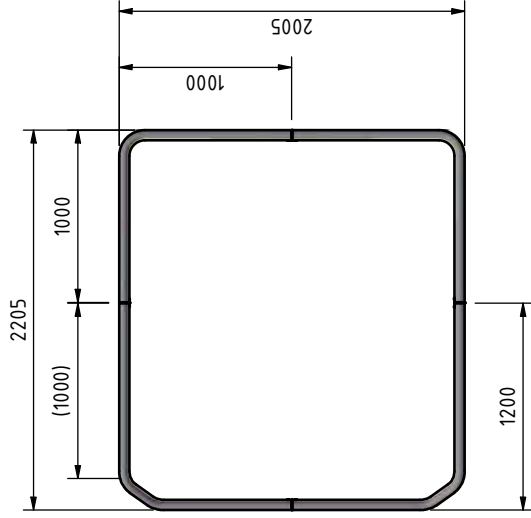

A (1 : 3)

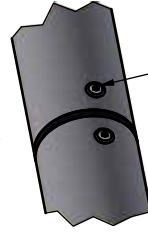

3	8	MRT TT M5x10	5x10	34235
2	4	Aluskarv	Ø60 x 6	100790
1	1	T-RACK Maxi Flex Design B2000xL2000	BF-352	
Pos / Ant		SMST Titel	Dimension	Artikel nr/Referens

TILLBEHÖR FÖR MONTAGE PÅ SKÅP/TAK
(INGÅR EJ I TM92100 & TM92100-1, KÖPS SEPARAT):

Art.nr: 98530

Förflyttning av rör
från grundposition:

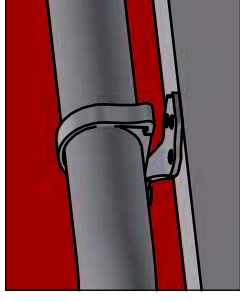
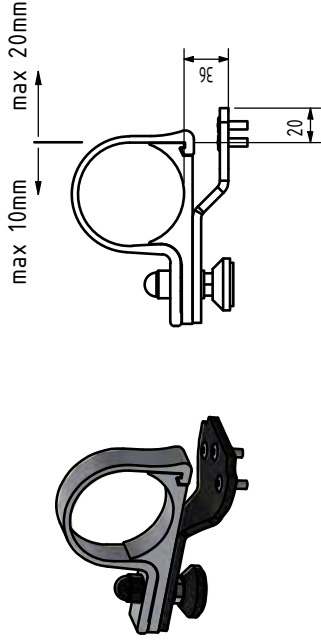

Art.nr: 98520

Förflyttning av rör
från grundposition:

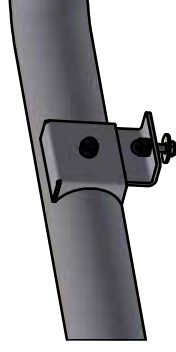
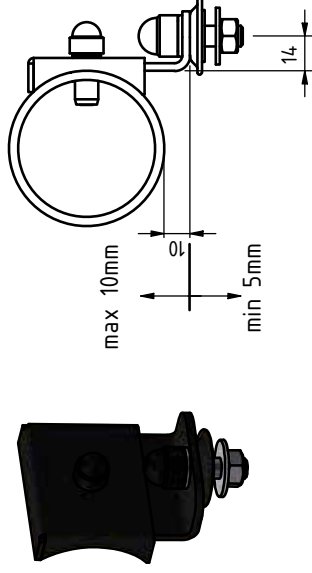

*Vinkel kan vändas
in under bågen

Nr	Ant	Ändring	Datum	Godk.
B		Rund & Design	2023-03-07	

Konstr.	Ritad	Kop.	Kontr.	Stand.	Godk.	Skala	Ersätter	Ersatt av
JNO	JNO					1:30		
Där ej annat anges, gäller SS/ISO 2768 - C och SMS 723 - B. Svarskvalitet för sveisar enligt SS-ISO 5817 nivå C.								
T-RACK Maxi Flex Rund & Design			Filnamn 93526.idw			Datum 2022-04-26		
B2000xL2000 (2200) max			Art. nr 93526			Rev B		
								
Tel: +46 (0)651760460 Mail: info@qpax.se								