

Preparation

- Thoroughly clean and dry the toilet pan
- Screw the ***threaded stud*** into one of the threaded holes in the metal disc (as tightly as possible)
- Align the 2 ***threaded studs*** into the holes in the toilet pan
- VERY IMPORTANT – tighten the ***locking screw***
- Insert the ***plastic disc*** and slide the ***threaded studs*** into the holes in the toilet pan

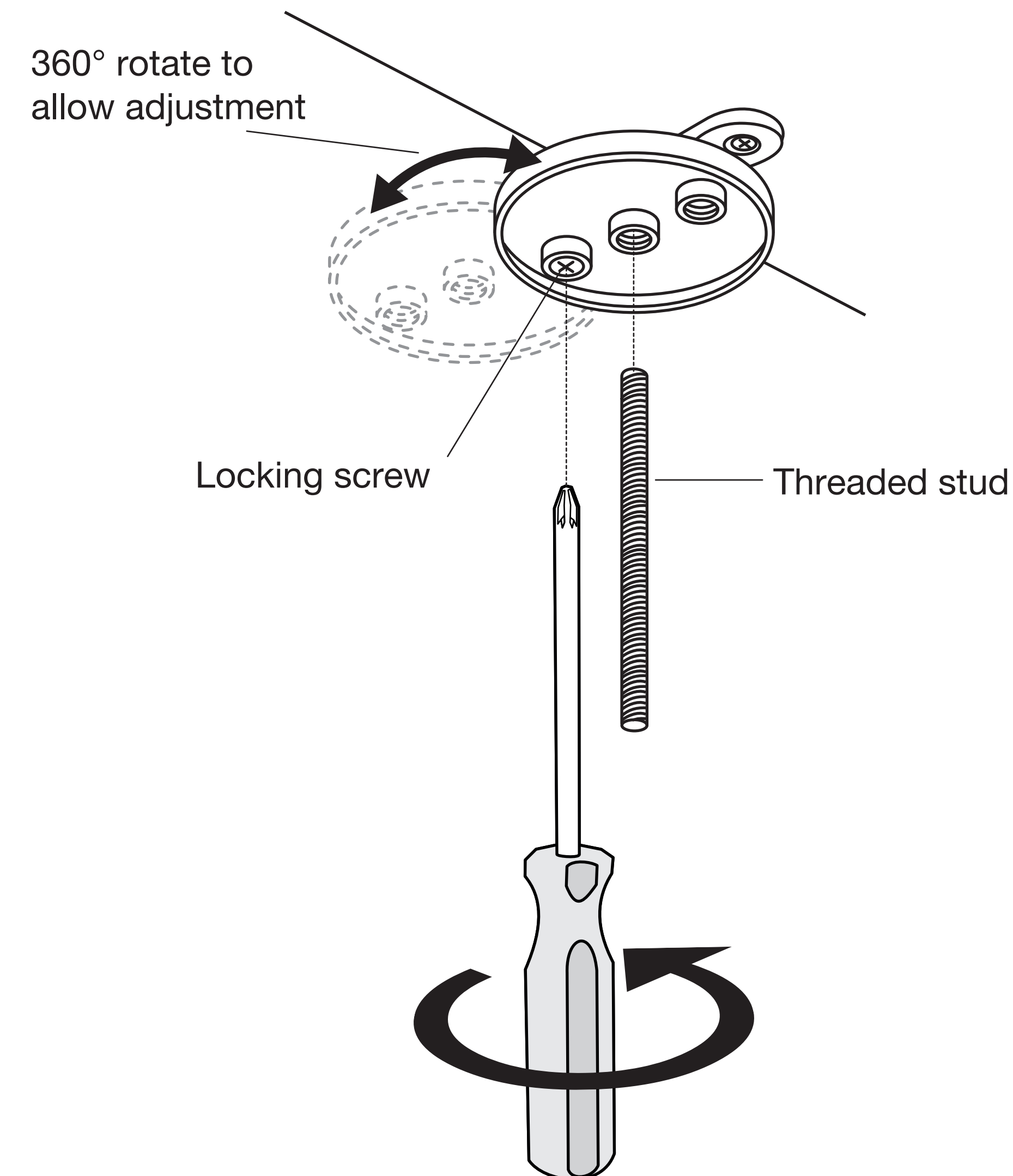

From underneath

- Slide up the ***conical washer***
- Slide up the ***metal washer***
- Screw on the ***metal wingnut*** (but not too tight)
- Align the seat centrally onto the toilet pan
- Tighten both ***metal wingnuts***

