

Fitting Instruction for Toilet Seat 84310

Option 1 : Top fixing

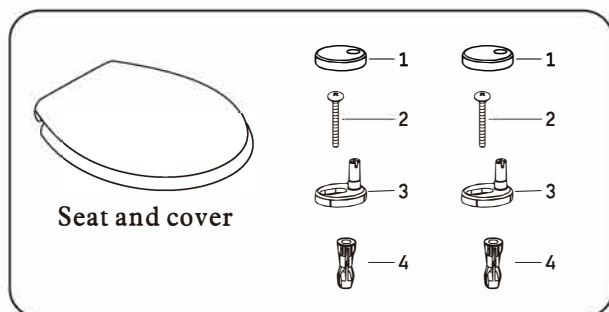

Hinge set.

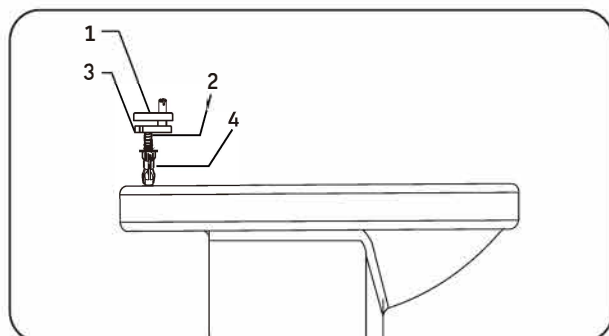

❶ Insert the hinges into the toilet.

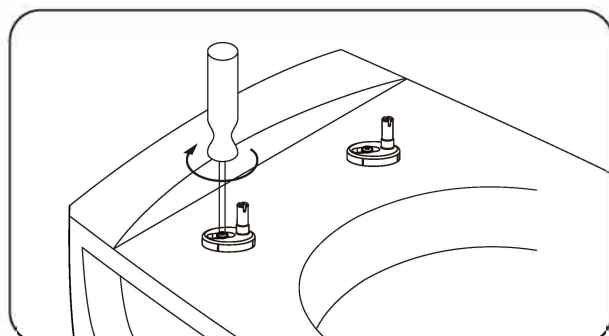

❷ Tighten the screws of the hinges.

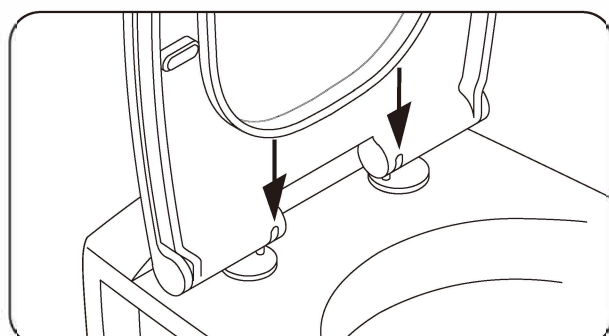

❸ Place covering caps on the hinges.
Insert the seat cover onto the toilet
at 90° degree.

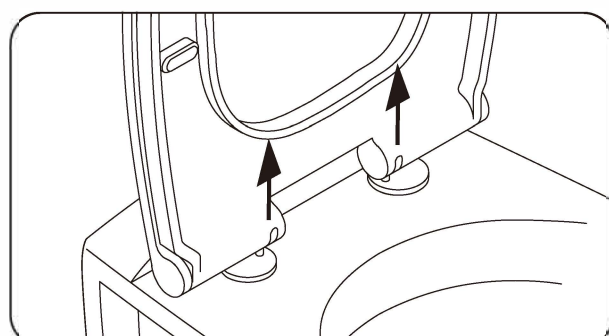

❹ Lift the seat cover at 90° degree.

Option 2 : Bottom fixing

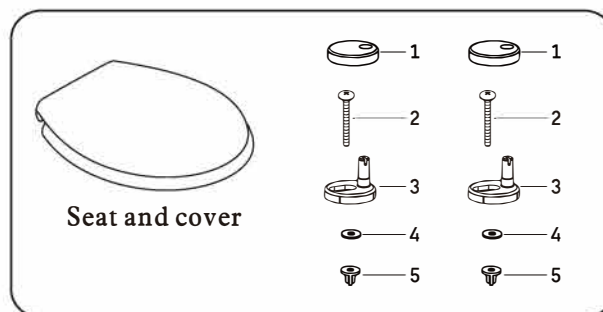

Hinge set.

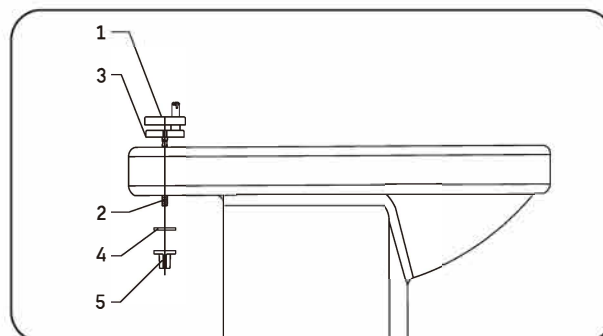

❶ Insert the hinges into the toilet.

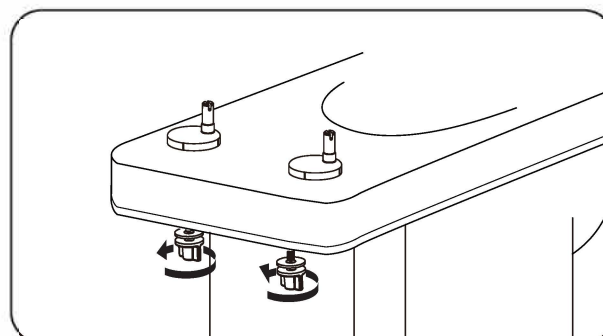

❷ Tighten the screws of the hinges.

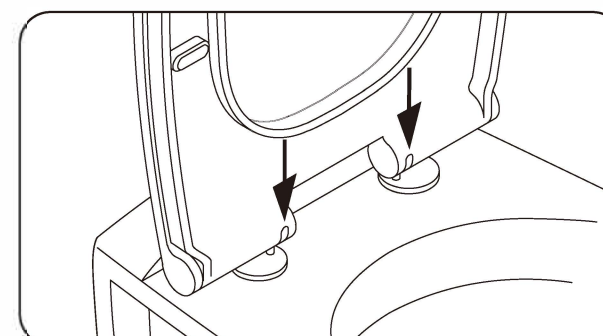

❸ Place covering caps on the hinges.
Insert the seat cover onto the toilet
at 90° degree.

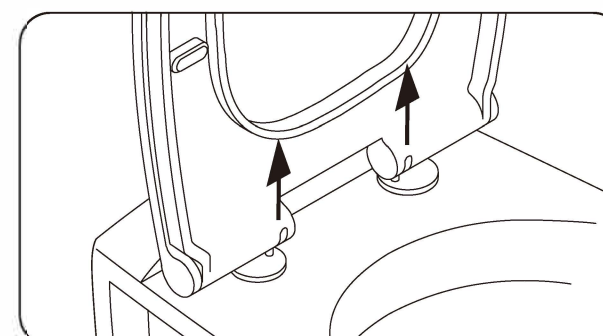

❹ Lift the seat cover at 90° degree.