

CE REV 000A

Quick®

High Quality Nautical Equipment

BALDER

BLD 600

BLD 900

BLD 1200



User's Manual

WINDLASS FOR INSIDE/STERN



GB **INDEX**

Pag. 14	Technical data	Pag. 19	Usage - Warning
Pag. 15	Installation	Pag. 20	Installation: rope fall positioning
Pag. 16	Connection diagram 600W	Pag. 21	Installation: fixing of the automatic stop
Pag. 17	Connection diagram 900/1200W	Pag. 22/23	Maintenance
Pag. 18	Free Fall Usage		



MODELS	BALDER 600		BALDER 900		BALDER 1200	
MOTOR OUTPUT	600W		900W		1200W	
Motor supply voltage	12 V	24 V	12 V	24 V	12 V	24 V
Maximum working load	200 Kg (440,9 lb)		320 Kg (705,5 lb)		480 Kg (1058,2 lb)	
Maximum speed	25-28 m/min (82-91 ft/min)		22-25 m/min (72-82 ft/min)		28-30 m/min (91-98 ft/min)	
Motor cable size (1)	16 mm ² (AWG5)	10 mm ² (AWG7)	25 mm ² (AWG7)	10 mm ² (AWG7)	35 mm ² (AWG2)	16 mm ² (AWG5)
Protection circuit breaker (2)	60 A	40 A	50 A	40 A	80 A	50 A
Deck thickness (3)	20 ÷ 30 mm (25/32" ÷ 1" 3/16 ft)					
Weight	9,0 Kg (19.8 lb)		14,6 Kg (32.2 lb)		19,2 Kg (34.6 lb)	
Rope size (4)	• 12 mm • 14 mm • 16 mm					

(1) Minimum allowable value for a total length L<20m (see pag. 24/25). Determine the cable size according to the length of the wiring

(2) With circuit breaker designed for direct currents (DC) and delayed-action (thermal-magnetic or hydraulic-magnetic).

(3) On request, studs can be supplied for greater deck thicknesses.

(4) Recommended leaded rope.

DIMENSIONS OF MODELS mm (inch)

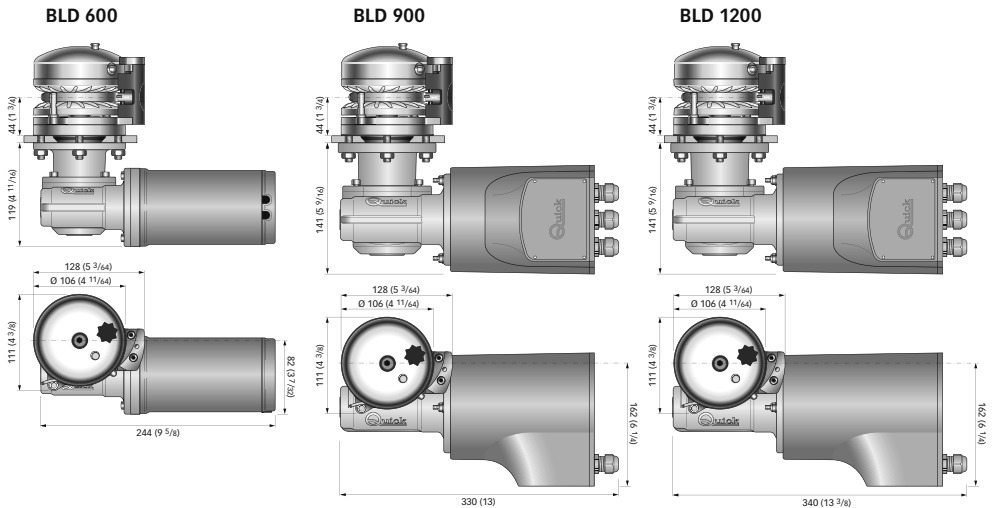

BALDER'S ACCESSORIES for inside/stern installations

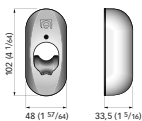

Thru-hull



Automatic Stop

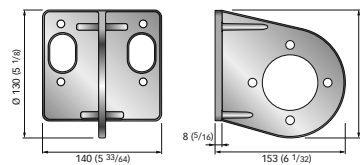

Mounting bracket



Quick® reserves the right to introduce changes to the equipment and the contents of this manual without prior notice.

In case of discordance or errors in translation between the translated version and the original text in the Italian language, reference will be made to the Italian or English text.



BEFORE USING THE WINDLASS READ THESE INSTRUCTIONS CAREFULLY.

IF IN DOUBT, CONTACT YOUR NEAREST "QUICK®" DEALER.

- ⚠ WARNING:** the Quick® windlasses are designed to weigh the anchor.
- ⚠ Do not use the equipment for other purposes. ⚠ Quick® shall not be held responsible for damage to equipment and/or personal injury, caused by a faulty use of the equipment. ⚠ The windlass is not designed for the loads that might occur in extreme weather conditions (storms). ⚠ Always deactivate the windlass when not in use.
 - ⚠ Check that there are no swimmers nearby before dropping anchor. ⚠ For improved safety we recommend installing at least two anchor windlass controls in case one is accidentally damaged.
 - ⚠ We recommend the use of the Quick® hydraulic-magnetic switch as the motor safety switch. ⚠ The contactor unit or reversing contactor unit must be installed in a point protected from accidental water contact.
 - ⚠ Secure the rope with a further device before starting the navigation. ⚠ To prevent accidental releases, the anchor must be secured. The windlass shall not be used as the only securing device. ⚠ Isolate the windlass from the power system during navigation (switch the circuit breaker off) and lock the chain securing it to a fixed point of the boat.

THE PACKAGE CONTAINS: windlass - contactor unit or reversing contactor unit - base gasket - drill template - handle - bolts and screws (for assembly) - user's manual - conditions of warranty.

TOOLS REQUIRED FOR INSTALLATION: drill and drill bits: Ø 9 mm (23/64"); Ø 60 mm (2 3/8") hollow mill; hexagonal wrench: 13 mm.

"QUICK®" ACCESSORIES RECOMMENDED: anchoring RL control board (mod. 800) - Waterproof hand helds R/C (mod. HRC1002) - Foot switch (mod. 900) - Hydraulic-magnetic circuit breaker - Radio control RRC (mod. R02, PO2, H02).

COVER INSTALLATION

Ensure that the upper and lower surfaces of the deck are as parallel as possible; if this is not the case, compensate the difference appropriately (a lack of parallelism could result in a loss of motor power).

The deck thickness must be included among the figures listed in the table.

In cases of other thicknesses it is necessary to consult a Quick® retailer.

There must be no obstacles under deck to the passage of cables and rope; lack of depth of the peak could cause jamming.

The motorgearbox can be rotated and fixed in several positions every 45°.

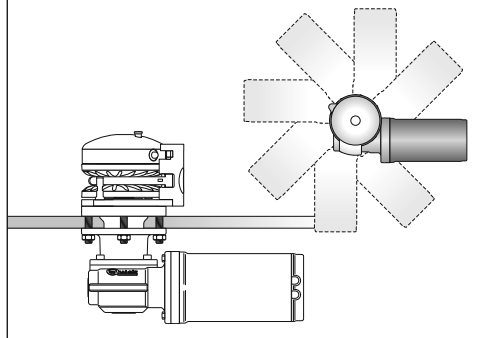

INSIDE/STERN INSTALLATIONS

The mounting bracket allows the user to install the windlass in a variety of combinations.

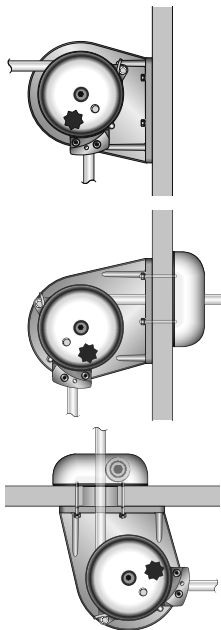

WARNING: before wiring up, be sure the electrical cables are not live.



BASIC SYSTEM BALDER 600W

SEE PAGE 20 SHOWING
THE MAIN CONNECTION DIAGRAM

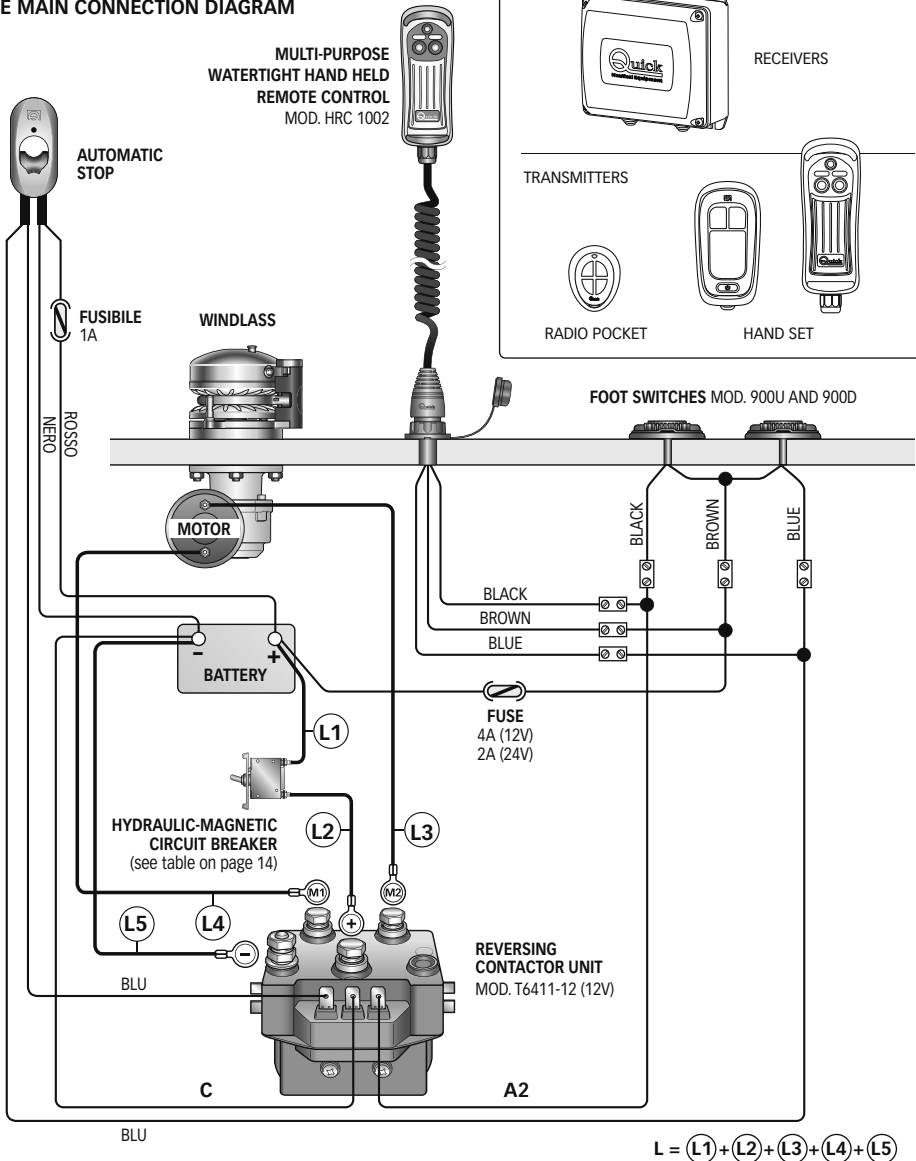



BASIC SYSTEM BALDER 900/1200W

SEE PAGE 21 SHOWING
THE MAIN CONNECTION DIAGRAM

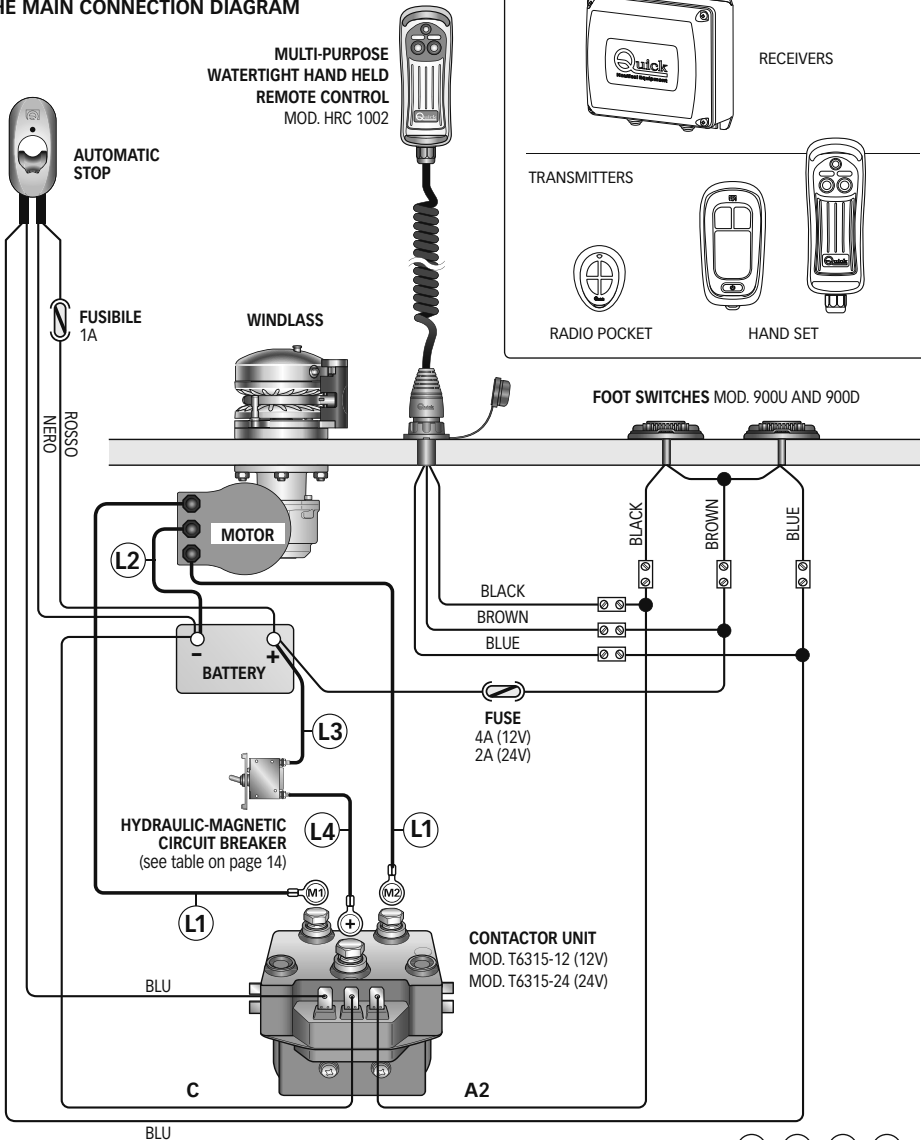



AUTOMATIC FREEFALL SYSTEM



ATTENTION: the automatic system should be activated or deactivated with the clutch closed (engaged) to avoid damage to the electromechanical components.

ATTIVAZIONE SISTEMA AUTOMATICO DI CADUTA LIBERA

Con questa procedura si attiva il sistema automatico di caduta libera.

- Turn the cover **A** until the pin's hole **B** faces upwards (as shown in fig. 1).
- Shut off power to the windlass.
- Block the rope with a lock.
- Pull the knob **C** until the pin is completely out **B** (as shown in fig. 2).
- Make certain the clutch is closed (engaged).
- Release the rope.
- Turn power to the windlass back on.

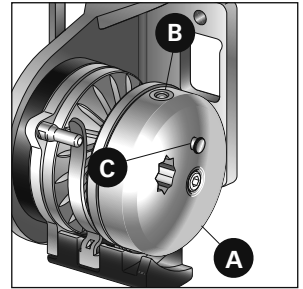

FIG. 1

Hold down the DOWN button to open the clutch (disengaged). As a result the gypsy will turn freely around its axis.

On the other hand, hold down the UP button to close the clutch (engaged).

As a result, the gypsy is integral to the axis again.

Casting with the automatic freefall system

With the freefall system activated, keep the DOWN button pressed up to the point in which the anchor can fall freely without encountering any problems and then release the button.

To slow down or stop letting the rope fall down, hold down the UP button until the desired effect is obtained.

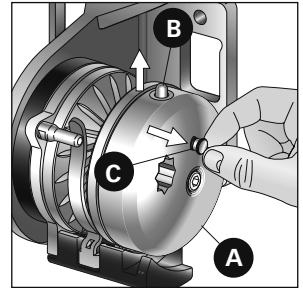

FIG. 2

Weighing the anchor with the automatic freefall system

Perform the procedure given in paragraph USAGE - WEIGHING THE ANCHOR.

DEACTIVATING THE AUTOMATIC FREEFALL SYSTEM

Follow the directions given below to deactivate the automatic freefall system:

- Turn the cover **A** until the pin's hole **B** faces upwards (as shown in fig. 1).
- Shut off power to the windlass.
- Block the rope with a lock.
- Push the pin **B**, into the center of the gypsy with the aid of a suitable tool (as shown in fig. 3).
- Make certain the clutch is closed (engaged).
- Release the rope.
- Turn power to the windlass back on.

When the automatic freefall system is deactivated, the rope can be lowered only electrically or manually (see paragraph USAGE - CLUTCH USE).

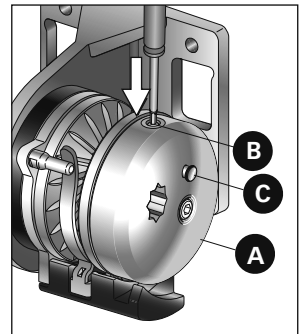





FIG. 3



WARNING

-  **WARNING:** stay clear of the chains, ropes and gypsy. Make sure the electric motor is off when windlass is used manually (even when using the handle to disengage the clutch). In fact people with windlass remote controls (hand-held remote control or radio-controlled systems) might accidentally operate it.
-  **WARNING:** secure the rope with a device before starting the navigation.
-  **WARNING:** do not operate the windlass by using the electrical power when the handle is inserted in the drum or into the gypsy cover.
-  **WARNING:** Quick® recommend using a circuit breaker designed for direct current (DC) with delayed-action (thermal-magnetic or hydraulic-magnetic) to protect the motor supply line from overheating or short circuits. The circuit breaker can be used to cut off power to the windlass control circuit and so avoid accidental activation.

CLUTCH USE

The clutch (23) provides a link between the gypsy and the main shaft (2 or 4). The clutch can be released (disengagement) by using the handle (28) which, when inserted into the gypsy cover (26), must be turned counter-clockwise. The clutch will be re-engaged by turning it clockwise.

WEIGHING THE ANCHOR

Turn on the engine. Make sure the clutch is engaged and remove the handle. Press the UP button on the control provided. If the windlass stops and the hydraulic magnetic switch (or thermal cutout) has not tripped, wait a few seconds and try again (avoid keeping the button pressed).

If the hydraulic magnetic switch, has tripped, reset it and wait a few minutes before weighing anchor once again.

If, after a number of attempts, the windlass is still blocked, we suggest to move the boat to release the anchor.

Check the upward movement of the chain for the last few meters in order to avoid damages to the bow.

CASTING THE ANCHOR

The anchor can be cast by using the electrical control or manually. To operate manually, the clutch must be disengaged allowing the gypsy to revolve and letting the rope or chain fall into the water.

To slow down the chain, the handle must be turned clockwise. To cast the anchor by using the electrical power, press the DOWN button on the control provided.

In this manner, anchor casting is under control and the chain and rope unwind evenly. In order to avoid any stress on the windlass -once the boat is anchored- fasten the chain or secure it in place with a rope.



ROPE FALL POSITIONING

According to the windlass installation, the rope may have different angles.

Here following is the procedure to follow in order to adapt the rope guide support (21) at the rope outlet.

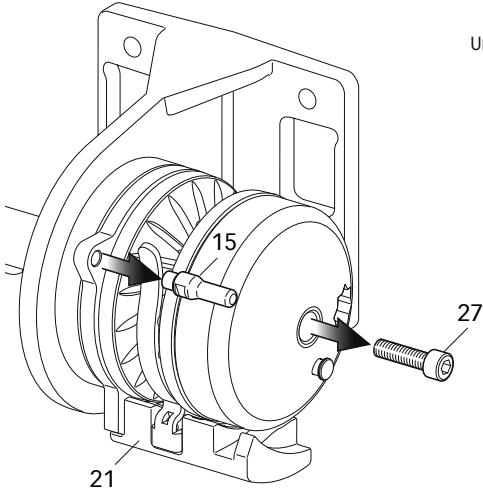

Unscrew and remove the pin (15) and the screw (27).

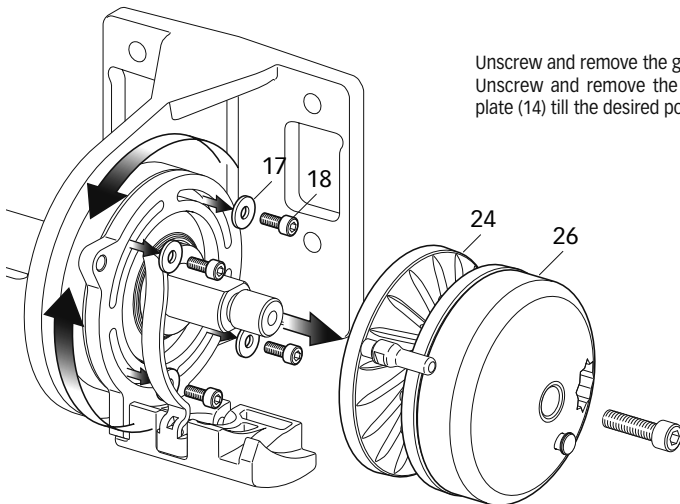

Unscrew and remove the gypsy lid (26) and the gypsy (24).
Unscrew and remove the 4 screws (18) and rotate the base plate (14) till the desired position.



FIXING OF THE AUTOMATIC STOP TO THE ROPE

- Weigh anchor till it blocks in the Bow Roller.
- With the rope under strain, position the Automatic Stop as close as possible to the thru-hull, measure the distance between the Automatic Stop and the Bow roller pin.
- In the established spot of the rope, fix the Automatic Stop with the 4 screws (see fig. 1).

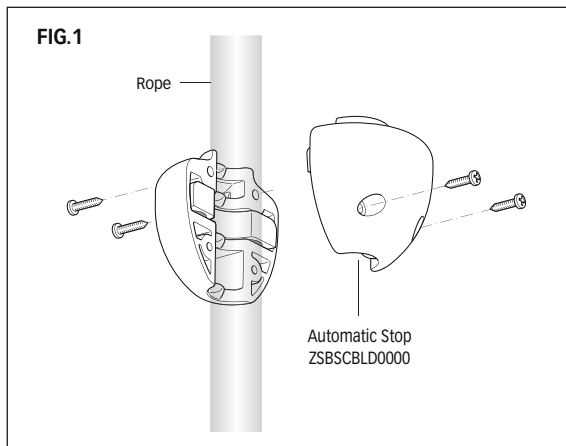
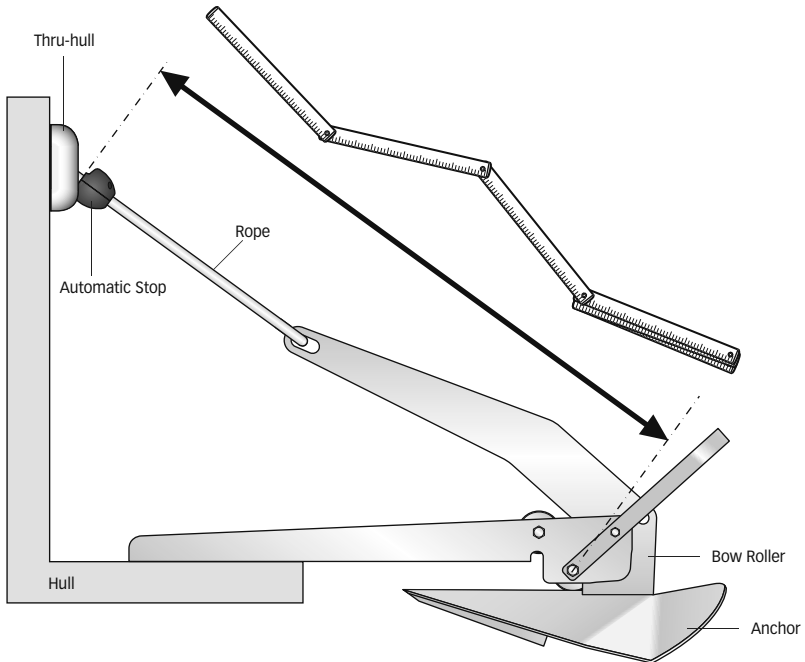

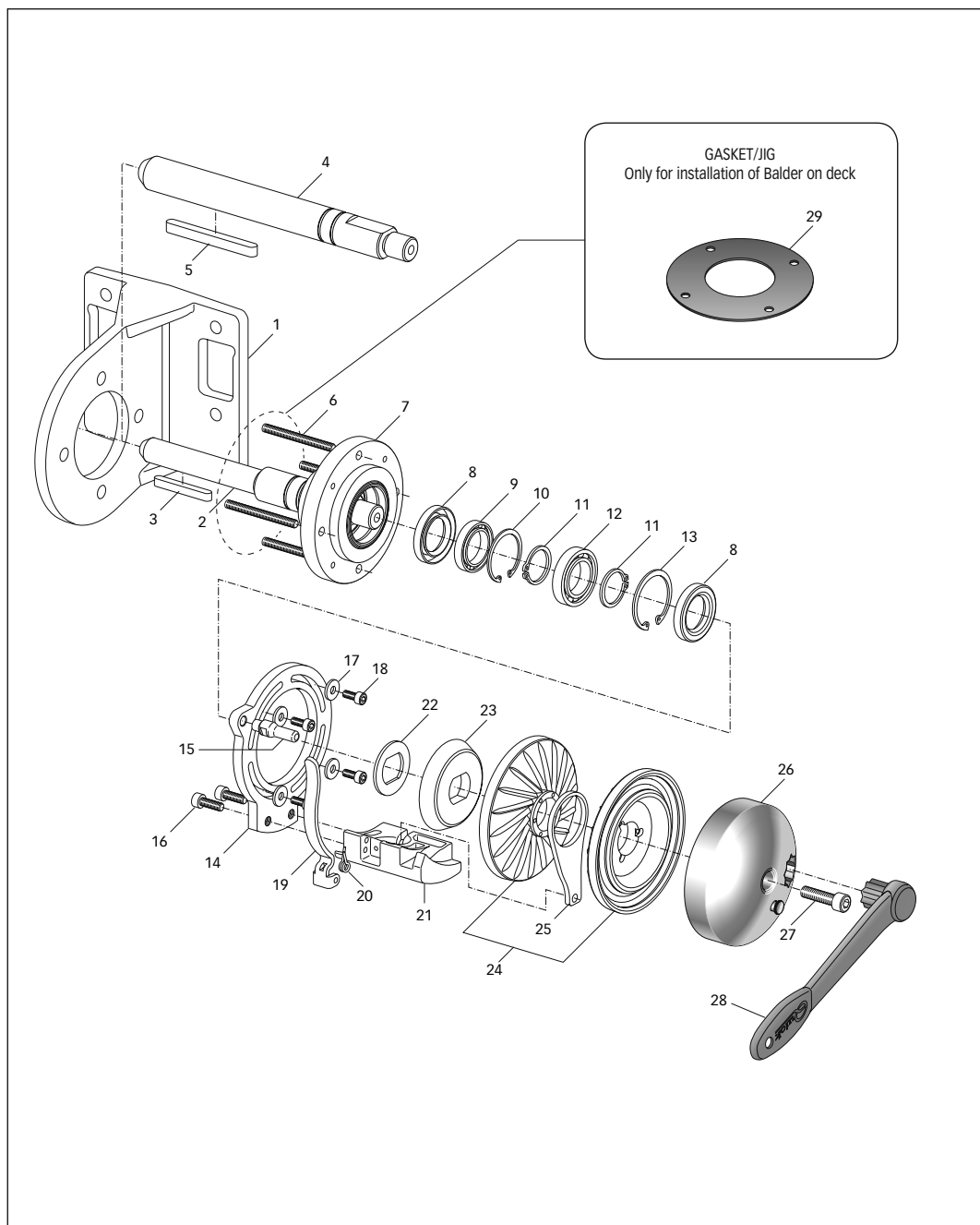



POS.	DESCRIPTION	CODE
1	Mounting bracket "BLD" Ø105 al anod	MMSTFSBLDA00
2	Shaft series "BLD" Ø105 600W	MSAS06209R00
3	Key 6*6*50 Stainless steel	MBH060650X00
4	Shaft series "BLD" Ø105 900W	MSAS09239R00
5	Key 6*6*50 Stainless steel	MBH060650X00
6	Stud M8 x 60	MBP08600X00
7	Anodized base "BLD" Ø105	SGMSCBBLD105
8	Oil seal 25*42*7mm	PGPRL2542700
9	Bearing 61805	MBJ616050000
10	Internal circlip	MBAN3715Y000
11	External circlip	MBAE2520Y000
12	Bearing 61905	MBJ619050000
13	Internal circlip	MBAN4217Y000
14	Base plate "BLD" Ø105 Stainless steel	SGMSCBBLD105
15	Mooring rope puller lock pin "BLD" Ø105 Stainless steel	SPMSNPBLD105
16	Stainless steel hex. cheese-headed screw M 6*18	MBV0618MXCE0
17	Washer Ø 05 Stainless steel	MBR05X000000
18	Screw M 5*16 Stainless steel T cilind cava esag	MBV0516MXCE0
19	Mooring rope puller "BLD" Ø105 Stainless steel	SPMMTCBLD000
20	Spring for mooring rope puller windlass 800W "AS/C" Stainless steel	MMTND08ASC00
21	Rope guide support "BLD" DX Stainless steel	SPMSNBLDDXX0
22	Washer reinforcement	MBR254025X00
23	Clutch cone 800W "AS/C"	MSF08ASCN000
24	Gypsy 800W "BLD" complete rope	ZSB08CMBLDR0
25	Rope/chain stripper "BLD" Ø105 Stainless steel	SPMSNBLD1050
26	Gypsy cover "G" FF complete	SAKCPBBGFF00
27	Screw M 8*30 Stainless steel T cilind cava esag	MBV0830MXCE0
28	Windlass lever - Nylon	PVLVSDN00000
29	Gasket/jig	PGBSTB050000



WARNING: make sure the electrical power to the motor is switched off when working manually on the windlass. Carefully remove the rope from the gypsy.

Quick® windlasses are manufactured with materials resistant to marine environments. In any case, any salt deposits on the outside must be removed periodically to avoid corrosion and damage to the equipment. The parts where salt may have built up should be washed thoroughly with fresh water.

Once a year, the drum and the gypsy are to be taken apart as follows:

Use the handle (28) to unscrew the gypsy cover (26); loosen screw (27) and take off the gypsy cover. Loosen the screws (16) of the chain stripper (25) and remove it; remove the gypsy (24).

Clean all the parts removed to avoid corrosion, and grease the shaft thread (2, or 4) and the gypsy (24) where the clutch cones (23) rest (use grease suitable for marine environment).

Remove any oxide deposits from the terminals of the electric motor and the contactor unit or reversing contactor unit; grease them.

MAIN CONNECTION DIAGRAM

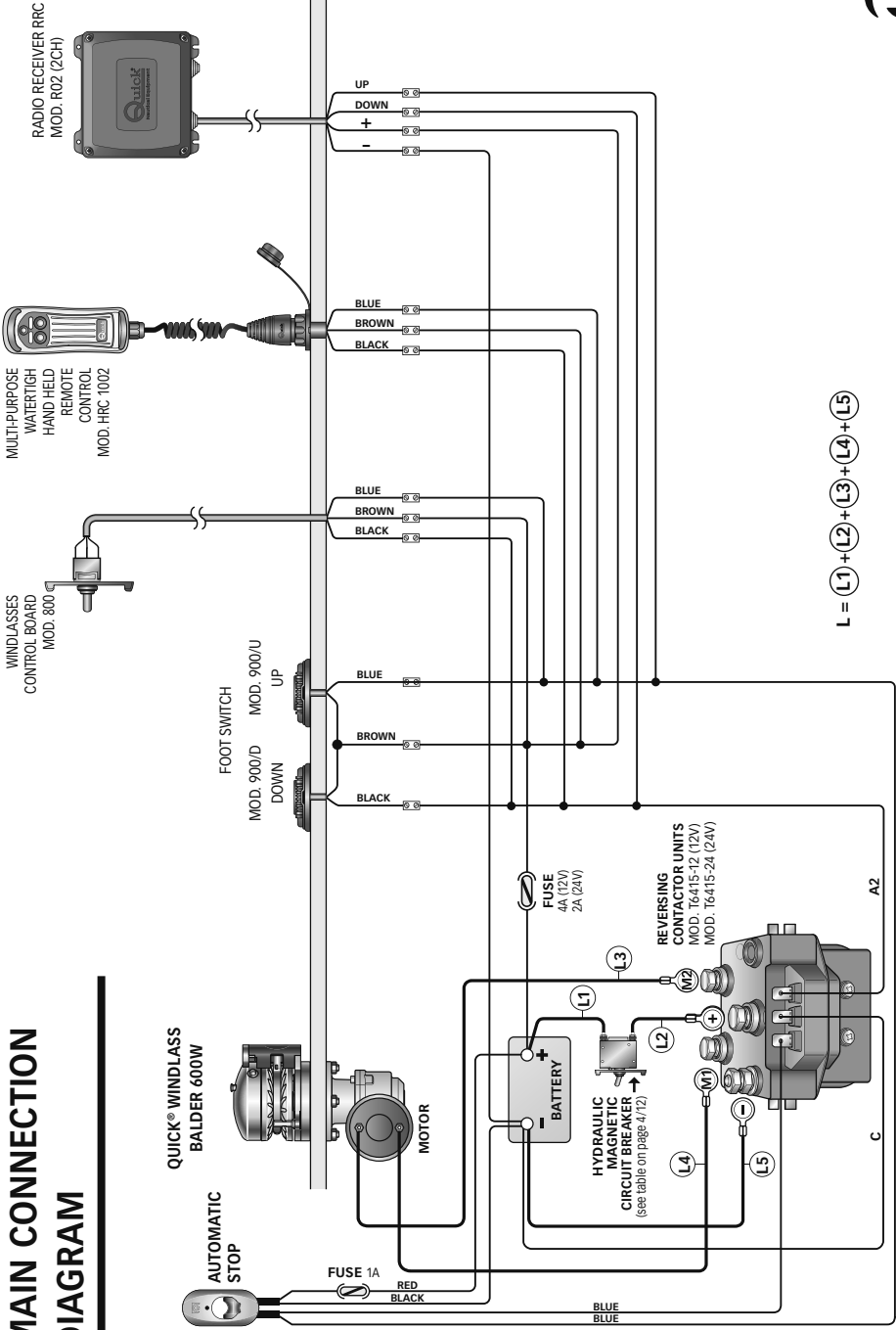

MAIN CONNECTION DIAGRAM

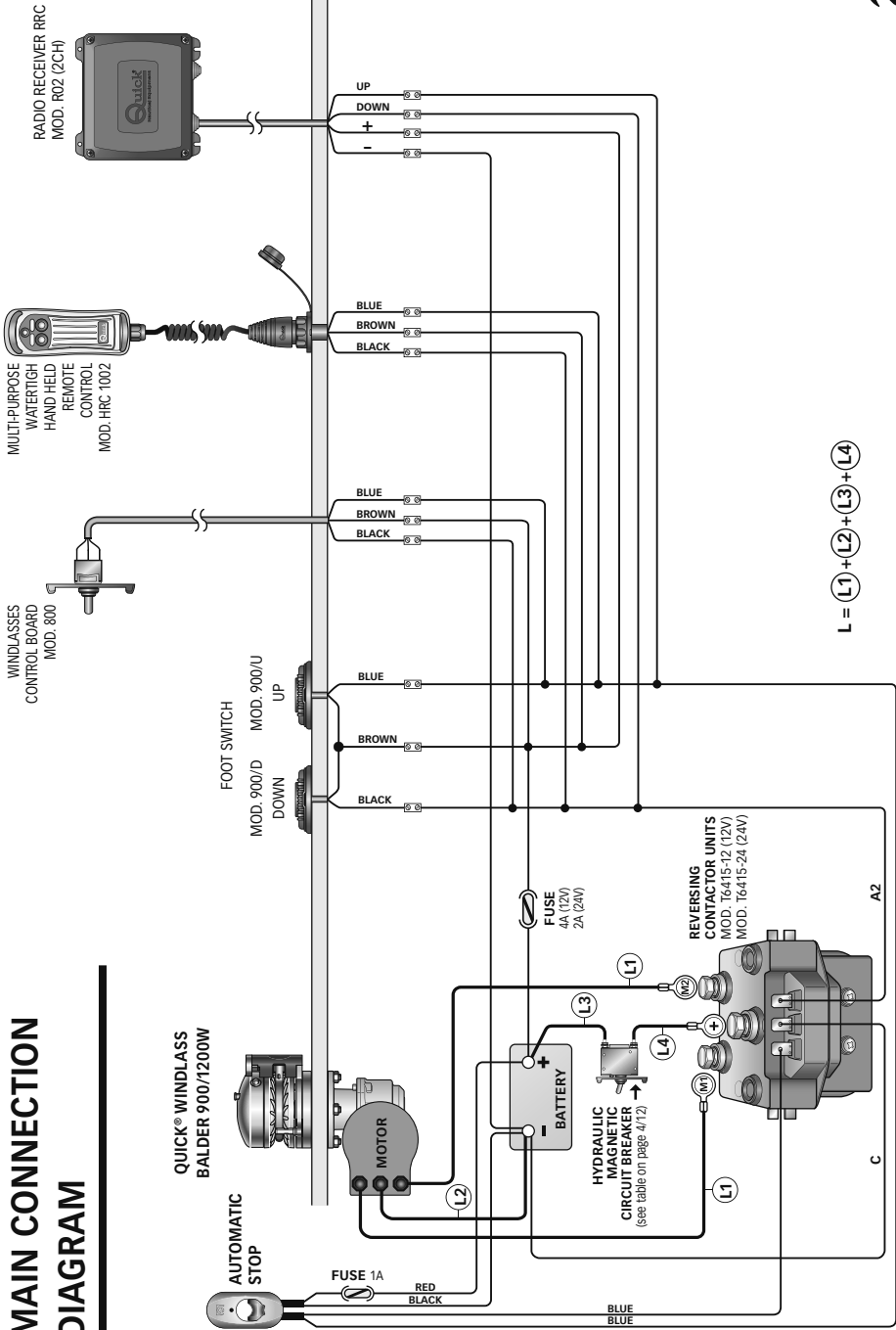

BALDER

R00A

BLD600 BLD900 BLD1200

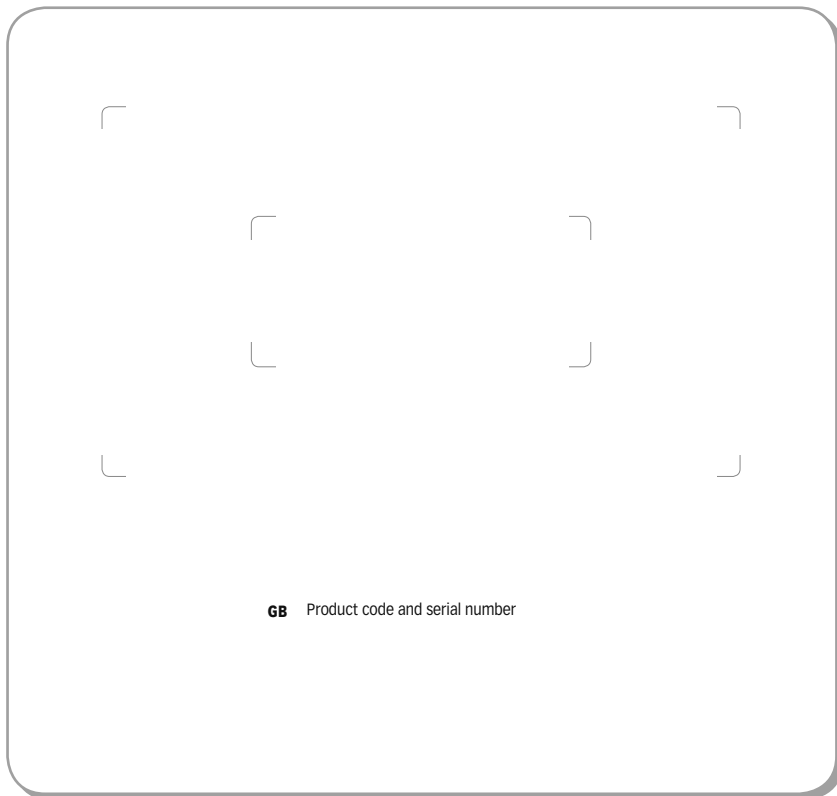

Quick[®]
Nautical Equipment

QUICK[®] S.p.A. - Via Piangipane, 120/A - 48124 Piangipane (RAVENNA) - ITALY
Tel. +39.0544.415061 - Fax +39.0544.415047
www.quickitaly.com - E-mail: quick@quickitaly.com