



JORDAN JX125NG. (Updated rim)

This is the smaller brother of the amazing JX150NG, but nevertheless a stunning performer spanning from 37 to 10 kHz making it a good match for the JXR6HD in a 2 way system. One thing that sets this woofer apart is the unique chassis, made from acoustically dead composite.

The new dual voice coil assembly makes it possible for you to match it to any preferred cabinet solution.

The dual voice coil also makes the driver very suitable in a line array in various combinations. Just like the JX92S, this driver will blow you away with its crisp and natural bass performance, making it sound like a much bigger driver. We recommend using two units in parallel (16 and 16Ohm), then by shorting second coil with a 1-6 Ohm resistor, Q can be controlled and adjusted (drops to almost half), or why not try a tall linear array with 8 units in parallel (32/8= 4Ohm)?

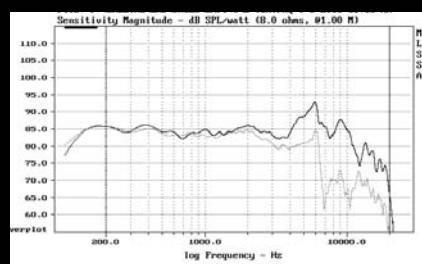

Frequency

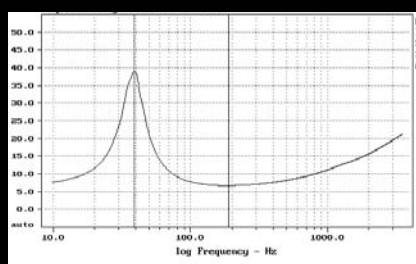

Impedance

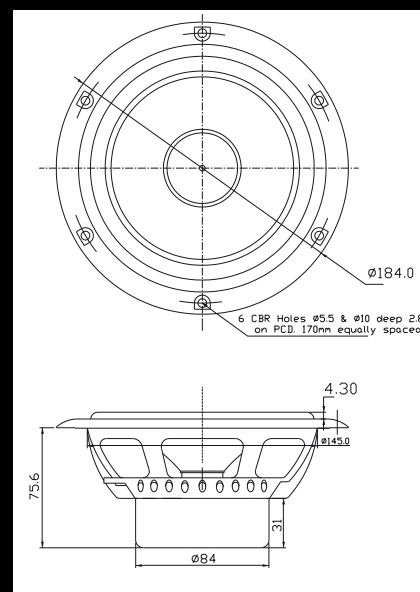

Measures

1/S Parameters, 1 coil, 16ohm
 "Method: Fixed-Mmd (13.100 grams)"
 "DCR mode: Fixed (11.66 ohms)"
 "Area (Sd): 138.93 sq cm"
 "Series resistance: 75.00 ohms"
 "Stimulus level: 3.83 volts"
 "SPLref reference impedance: 8 ohms"
 0.944 "RMSE-free Ohms"
 37.111 "Fs Hz"
 11.660 "Re Ohms"
 35.103 "Res Ohms"
 2.950 "Qms"
 0.980 "Qes"
 0.736 "Qts"
 0.463 "L1 mH"
 1.030 "L2 mH"
 9.740 "R2 Ohms"
 0.000 "RMSE-load Ohms"
 35.547 "Vas(Sd) liters"
 14.027 "Mms(Sd) grams"
 1311.262 "Cms(Sd) æM/Newton"
 6.238 "Bl(Sd) Tesla-M"
 82.874 "SPLref(Sd) dB[8 ohms]"
 0.011 "Rub-index"
 X-max +/- 5mm. p-p

1/S Parameters, 2 coils parallel, 8ohm
 "Method: Fixed-Mmd (13.100 grams)"
 "DCR mode: Fixed (6.10 ohms)"
 "Area (Sd): 138.93 sq cm"
 "Series resistance: 75.00 ohms"
 "Stimulus level: 3.83 volts"
 "SPLref reference impedance: 8 ohms"
 0.624 "RMSE-free Ohms"
 38.038 "Fs Hz"
 6.100 "Re Ohms"
 32.962 "Res Ohms"
 2.902 "Qms"
 0.537 "Qes"
 0.453 "Qts"
 0.459 "L1 mH"
 0.983 "L2 mH"
 9.986 "R2 Ohms"
 0.000 "RMSE-load Ohms"
 33.835 "Vas(Sd) liters"
 14.027 "Mms(Sd) grams"
 1248.103 "Cms(Sd) æM/Newton"
 6.171 "Bl(Sd) Tesla-M"
 88.407 "SPLref(Sd) dB[8 ohms]"
 0.025 "Rub-index"
 X-max +/- 5mm. p-p

Thiele/Small Parameters, 2 coils series 32ohm
 "Method: Fixed-Mmd (13.100 grams)"
 "DCR mode: Fixed (24.00 ohms)"
 "Area (Sd): 138.93 sq cm"
 "Series resistance: 75.00 ohms"
 "Stimulus level: 3.83 volts"
 "SPLref reference impedance: 8 ohms"
 2.473 "RMSE-free Ohms"
 38.094 "Fs Hz"
 24.000 "Re Ohms"
 137.990 "Res Ohms"
 3.021 "Qms"
 0.526 "Qes"
 0.448 "Qts"
 1.832 "L1 mH"
 4.010 "L2 mH"
 40.405 "R2 Ohms"
 0.000 "RMSE-load Ohms"
 33.736 "Vas(Sd) liters"
 14.027 "Mms(Sd) grams"
 1244.460 "Cms(Sd) æM/Newton"
 12.383 "Bl(Sd) Tesla-M"
 82.559 "SPLref(Sd) dB[8 ohms]"
 0.015 "Rub-index"
 X-max +/- 5mm. p-p