



The dosing pump is designed for controlled, automated chemical feeding.

Features:

- integrated, electrically controlled chemical pump.
- optimized chemical consumption.
- feeding in pre-selected, user-programmable intervals and times.

Technical Data

Approx. Weight.....N/A
Outside Dimensions.....70 x 395 x 183 mm (LxWxH)
Generic Material.....Industrial Plastic

Operating Data

Voltage.....100-240V
Frequency.....50 // 60 Hz
Power Consumption.....2 W
Nominal Current.....0.35A
Temperature Range.....-5 to 80°C

Disclaimer

Note: Our products and services are offered and sold subject to Jets Vacuum AS' General Sales Conditions, copies of which will be furnished upon request. Information provided herein is solely for information purposes, does not constitute any warranty or representation of any kind and is subject to change without notice. We strive to reproduce product colors reasonably accurate. Without prior written approval, this document or any part of may not be reproduced in any form. Jets™, Vacuumator™, Helivac™, VC™, VOD™, CVS™ and Softsound™ are trademarks and/or registered trademarks of Jets. © Jets AS. All rights reserved.

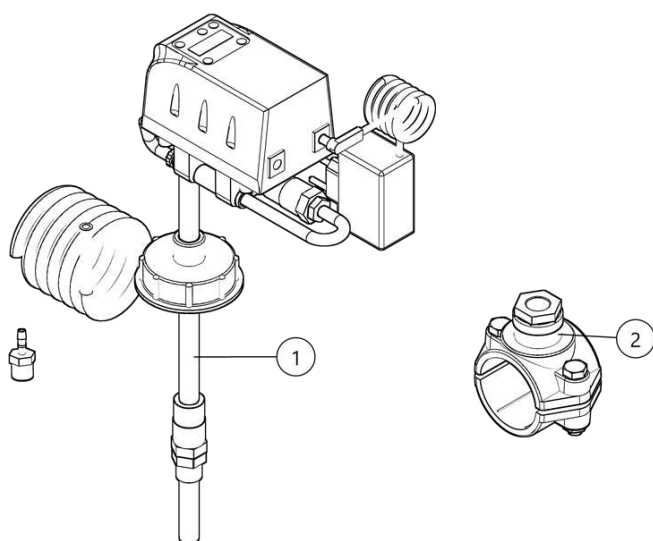

Components

1 | Dosing Pump813398885*

* Component/s available as replacement parts.

Accessories

Construction Characteristics

Pipe Clamp set, ø50mm.....034233050
Pipe Clamp set, ø63mm.....034233051
Pipe Clamp set, ø75mm.....034233052

Pre-Installation

The dosing unit should be connected at the end of each horizontal main branch.

Pipe Connection

Note: The pipe connector must be installed above the horizontal middle line of the vacuum pipe.

A - Correct mounting

B - Incorrect mounting

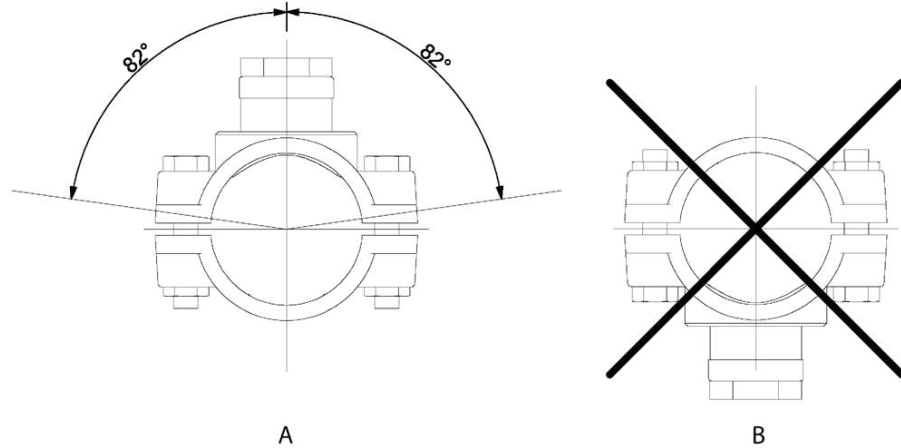

Installation

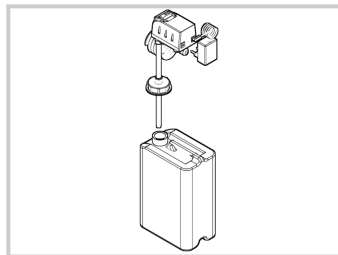

1

Insert the dosing unit pipe into the opening on the supply (i.e. Can).
A 5 ltr or 10 ltr can is recommended.
If a 5 ltr can is used unscrew the extension piece on the pipe.

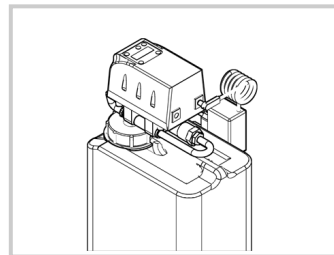

2

Tighten the cap.

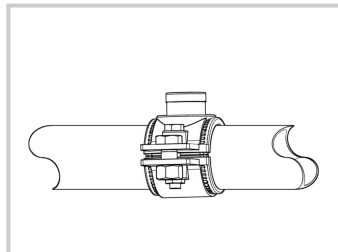

3

Attach the pipe clamp securely over the pipe.

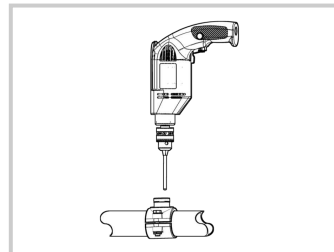

4

Drill a Ø8mm hole into the pipe from above. Do not drill through the entire pipe.

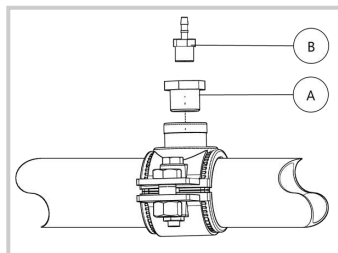

5

Screw the reducer (A) and the dosing nipple (B) into the pipe clamp.

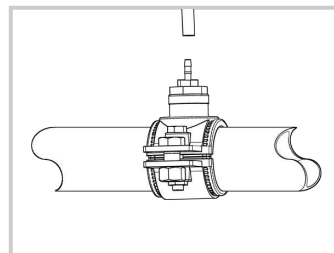

6

Connect the hose.

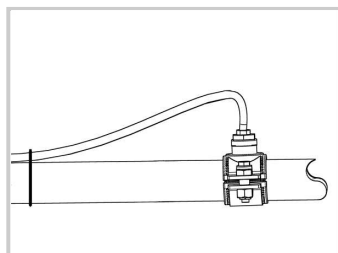

7

Ensure that the pipe clamp and the hose are secured tightly to the pipe.
Secure the hose with a cable tie.

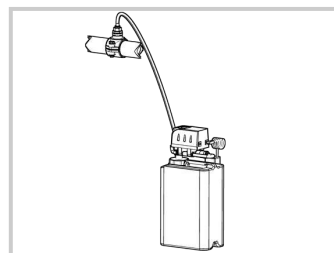

8

Plug in the electrical supply.
Slowly restore pressure to the system.

Completed.