



ATV

**ATV LIGHT BAR  
MOUNTING KIT INSTALLATION INSTRUCTIONS  
40630 FITS (1) 6" E-SERIES® OR SA-SERIES®  
41030 FITS (1) 10" E-SERIES OR SA-SERIES**

Lights Sold Separately\*

**PARTS INCLUDED**

(1) Mounting Bracket

**TOOLS NEEDED**

5/16 wrench or socket  
17mm wrench or socket

**IMPORTANT**

Thank you for purchasing Rigid Industries' products for your ATV. Installation is fairly simple with the right tools and good mechanical abilities. If you are not confident in your mechanical skills, please seek the help of a professional to perform the installation. Please read through all of these instructions and tips before proceeding with installation. **It is strongly recommended that this product be installed by a professional.**

**Always disconnect any power sources connected to your vehicle before servicing fuses or electrical systems.**

**INSTALLATION**

To mount your new light kit remove the handle bar mounting system from ATV. Mount the bracket between the handle bar clamp and the steering stem. You shouldn't have to remove your handle bars from the mount or any of the controls on the bars.

Once the mount is installed, as shown in Fig. 1, install the light into the mounting bracket using the hardware provided with light. Make sure the black compression spacers are located between the bracket and the light housing or **damage to the light may occur.**

**WIRING**

Wire your lights according to the instructions included with the light. Take care to avoid any heat sources and sharp or abrasive surfaces.

Figure 1. Mounting Bracket

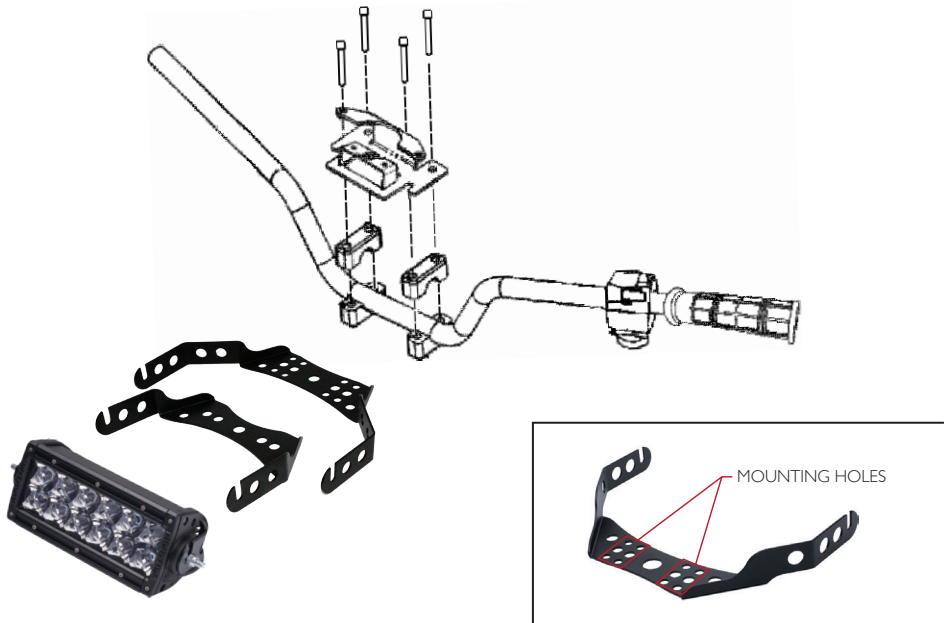

**Your installation is now complete.**

**Welcome to the Rigid Nation!**

### **WARRANTY INFORMATION**

Rigid Industries warrants that this product will be free from defects in material and workmanship. If you believe your Rigid Industries product is defective, it must be returned to Rigid Industries for inspection by our warranty claims department. If, after inspection, Rigid Industries verifies that the defect was not caused by negligence, abuse, unauthorized repair or disassembly, Rigid Industries will determine whether the product will be repaired or replaced in accordance with Rigid Industries Limited Lifetime Warranty\*.

#### **Warranty Periods:**

- All LED Lights – Limited Lifetime
- Flashlights – 1 year
- Accessories and Mounts – 2 years
- Batteries – 90 days

#### **Warranty Coverage:**

To begin your warranty claim, you must have a Return Merchandise Authorization (RMA) number. To get your RMA number, please contact our warranty department by phone at 480-655-0100 ext. 1008, or by filling out the Return Merchandise Authorization Form on our website.

All of the following will immediately void all warranties:

- Customer negligence – The customer has modified the light and/or is not using it for the recommend application.
- Customer abuse – Damage to the light beyond normal wear and tear.
- Repair work done by unauthorized personnel without Rigid Industries' approval.
- If the light has been opened or any screws have been removed.

All warranties are non-transferable. Warranty terms and policies are subject to change without notice.

\*For all information regarding the Rigid Industries' Limited Lifetime Warranty please call 855-760-5337 ext. 1008, email [warranty@RigidIndustries.com](mailto:warranty@RigidIndustries.com), or visit our warranty page online at [rigidindustries.com/about/warranty](http://rigidindustries.com/about/warranty).

**FOLLOW US ON FACEBOOK AT**  
**[facebook.com/RigidIndustries](https://www.facebook.com/RigidIndustries)**

779 N Colorado St, Gilbert, AZ 85233 • 855-760-5337 [www.rigidindustries.com](http://www.rigidindustries.com)

E-Series, SR-Series and Rigid Industries are registered and/or common law marks owned by JST Performance, Inc. d/b/a Rigid Industries

PKG-IS-104-rev2