

IMPORTANT

This manual contains instructions for installation, use and operation of the appliance. This manual is an integral part of the device. It must be stored in the vicinity of the device for the entirety of its service life and must be made available to the user any time the device is installed, moved, used or maintained. Read this manual carefully before installing and using the device. It contains important information necessary to ensure that all operations are done properly and safely.

Due to the continuous improvement of the products, the pictures are located in the manual illustrative only and may differ from the purchased goods.

This manual is a translation of the original Czech manual.

LINDR.CZ s.r.o.

Sadová 132
503 15 Nechanice, Czech Republic

mobile: + 420 775 715 494

tel.:+420 495 447 239

e-mail: info@lindr.cz

web: www.lindr.cz, www.lindr.eu

14

SYMBOLS AND MARKINGS USED IN THE MANUAL:



WARNING:

Not following instructions may cause injury or damage the device.



DANGER:

Risk of injury by electrical current.



NOTE:

This symbol indicates information and recommendations for the user.



WARNING:

The cooling system contains flammable coolant R290 (propane)!



Contents:

1.	Introduction	16
2.	Description of the cooler	16
3.	Machine plate	16
4.	General instructions, measures and safety instructions	16
5.	Installation and placement	17
6.	Electrical connection	18
7.	Testing	18
8.	Warranty	18
9.	Description of the device	18
10.	Pouring fluid into the tank	19
11.	Beverage supply connection and pressurisation	19
12.	Putting into operation	20
13.	How to work with speed fittings	20
14.	Temperature and adjustment	21
15.	Tap installation	21
16.	Cleaning the condenser	21
17.	Keg coupler assembly	21
18.	Keg tapping and untapping	22
19.	Spare parts	22
20.	Sanitation by water	22
21.	Maintenance	23
22.	Inspection before every use	23
23.	Periodic checks	23
24.	Environmental protection	23
25.	Table of malfunctions	24

1. INTRODUCTION:

Thank you for purchasing this LINDR product.

2. DESCRIPTION OF THE COOLER

The under counter dispensing machine with ice bank is primarily intended for cooling beverages in kegs. The water in these machines serves to transfer cold to the beer line and also as a cold accumulator.

This manual is intended for models:

CWP 100 Green Line new
CWP 200 Green Line new
CWP 300 Green Line new
CWP 200 Green Line mobilní new
CWP 300 Green Line mobilní new
CWP 300/Kprofi Green Line mobilní new
AS-40 Green Line new
AS-40 Glycol Green Line new
AS-45 2xkohout Green Line new
AS-80 Green Line new
AS-110 Green Line new
AS-110 INOX Tropical Green Line new
AS-160 Green Line new
AS-160 INOX Tropical Green Line new
AS-200 Green Line new

3. MACHINE PLATE



4. GENERAL INSTRUCTIONS, MEASURES AND SAFETY INSTRUCTIONS:

When using the device, follow basic safety instructions stated by the manufacturer. The cooling device is designed for flow-through cooling of beverages. Any other use is considered impermissible and therefore dangerous. The supplier is not liable for damage caused

by incorrect use.

DO NOT USE THE DEVICE FOR PURPOSES OTHER THAN THOSE STATED BY THE MANUFACTURER!

The devices meet safety protection IP21.

General safety principles. Observe the following safety instructions.

The supplier is not liable for damage caused by activities carried out on this device without observing the following instructions!

⚠ WARNING: Children aged 15 or more and persons with reduced physical, sensory or mental capabilities or insufficient experience and knowledge may only use the device when supervised or instructed in safe use of the appliance and familiarised with potential dangers.

⚠ WARNING: Children must not be allowed to play with the appliance. Store all packaging material out of reach of children (*comes with a plastic bag – suffocation hazard*).

⚠ WARNING: Cleaning and maintenance of the appliance on the part of the user must not be done by unsupervised children.

⚠ WARNING: Before connecting to main electrical supply, check that the voltage and frequency in the mains corresponds to the data stated on the device.

⚠ WARNING: Always make sure that the socket you intend to plug the cooler into meets the specifications on the machine plate (voltage, frequency, input power).

⚠ WARNING: Before performing operations on the device such as cleaning or maintenance, ALWAYS disconnect the device from power supply: set the thermostat to "O" position and unplug the appliance from the socket.

⚠️ WARNING: Never place tools or other object into the fan.

⚠️ WARNING: Never touch electrical components with wet or damp hands.

⚠️ WARNING: To ensure the cooling unit works properly and at full capacity, make sure air supply to the unit is not obstructed.

⚠️ WARNING: Water temperature during sanitation must not be higher than 25 °C!

⚠️ WARNING: Always make sure the power socket you intend to plug the cooler into is accessible, so that the appliance can be immediately unplugged in case of emergency.

⚠️ WARNING: When unplugging the device from the socket, grab the plug and pull it out. Do not under any circumstances pull at the cable; risk of damage.

⚠️ WARNING: To turn the device off completely, unplug the appliance from the power socket.

⚠️ WARNING: In the event the electrical wiring of the product becomes damaged, summon a trained service technician. Do not under any circumstances repair the device yourself.

⚠️ WARNING: The cooling system contains flammable coolant R290 (propane)!



⚠️ WARNING: Emergency maintenance and repair of the cooling system must be done by trained, authorised technicians familiar with cooling and electrical systems. The technicians should have special training and qualification for handling flammable substances in order to perform service on coolers containing R290. Follow basic regulations and safety measures regarding service and repair!

⚠️ WARNING: Do not use open flame or potential sources of sparks in the vicinity of a cooler using **R290** coolant!

⚠️ WARNING: After unpacking, place the cooler so that heat created by the cooling unit can be vented sufficiently.

⚠️ WARNING: Do not place objects that could prevent air circulation on top of the cooler.

5. INSTALLATION AND PLACEMENT:

Place the cooler onto a stable, level surface (maximum permitted inclination: 2 degrees). The appliance requires unobstructed air circulation.

- Ensure sufficient free space for air circulation and heat dissipation.
- Ensure sufficient supply of fresh air.
- The device must not be placed in an enclosed space.
- The device must not be placed in the vicinity of heat sources or exposed to direct sunlight.

Minimum distance of vents from an obstacle that would limit air circulation must be 200 mm and from the capacitor 500mm. Minimum distance for sections with no air vents is 70 mm. Ideally, use the device in a cool and well-ventilated room. The device is designed for use at ambient temperature of at least 16 °C and at most 32 °C.

⚠️ WARNING: The device MUST NOT be used or stored at ambient temperature lower than 0 °C. The device is designed for use in a normal environment, always under a roof, protected from rain or sunlight. Climate class N.

⚠️ DANGER: Protect the cooler and electrical connection from rain and spraying water!

⚠️ WARNING: Do not under any circumstances lay the cooler on its side, not even during transport.

i NOTE: In order for the device to work correctly and at maximum output, it is important to not cover up any of the device's vents and ensure sufficient air circulation.

6. ELECTRICAL CONNECTION:

Connect the device to a power socket in accordance with specifications on the machine plate of the device. Electrical wiring is subject to local regulations. If the power leads (cables) are damaged, they must be replaced by the manufacturer, their service technician or a similarly qualified person to prevent risk of hazardous situations.

⚠ DANGER: Do not use or turn on the device if the power lead cable is damaged!

7. TESTING:

The product is delivered ready for immediate use.

8. WARRANTY:

The device comes with a warranty in accordance with general legal regulations of the Czech Republic or in accordance with the trade agreement. During the validity period of the warranty, we will remove any defects on the product free of charge, provided these defects were not caused by excess wear, improper handling, incorrect storage or by using the product in a way that is counter to the instruction manual or the product's design as defined

by the manufacturer. Materials replaced during the validity period of the warranty are our property. The legitimacy of the warranty claim is always decided by an authorised service centre. Warranty provided by a retailer outside of the territory of the Czech Republic is governed by the agreement between the retailer and the buyer in their mutual relationship; this agreement is not directly linked to the manufacturer. The agreement does not give the buyer the right to submit warranty claims to the manufacturer. Transport expenses or other costs are not covered by the warranty.

ATTENTION:

Electrical devices and appliances must be checked/inspected at a time stipulated by valid legislation of the country the device is operated in. Inspection of wiring may only be done by a person with valid authorisation for this activity. Service work, provision of spare parts and inspection is done by the manufacturer or an authorised service centre.

9. DESCRIPTION OF THE DEVICE (see Fig. 9.):

9.1 Model series CWP 100 Green Line new, CWP 200 Green Line new, CWP 300 Green Line new:

- | | |
|----------------------------------|----------------------|
| 1. Lever indicator | 7. Cooling coil |
| 2. Overflow | 8. Main switch |
| 3. Inlet of the beverage | 9. Thermostat |
| 4. Recirculation pump | 10. Fan |
| 5. Outlet of the cooled beverage | 11. Condenser |
| 6. Plastic tank | 12. Motor compressor |

9.2 Model series AS-40 Green Line new, AS-80 Green Line new, AS-110 Green Line new, AS-160 Green Line new, AS-200 Green Line new:

- | | |
|----------------------------------|-------------------------------|
| 1. Lever indicator | 7. Plastic tank |
| 2. Overflow | 8. Fan |
| 3. Inlet of the beverage | 9. Condenser |
| 4. Outlet of the cooled beverage | 10. Thermostat |
| 5. Recirculation pump | 11. Recirculation pump socket |
| 6. Cooling coil | 12. Main switch |

9.3 Model series AS-45 2xkohout Green Line new, AS-110 INOX Tropical Green Line new, AS-160 INOX Tropical Green Line new:

- | | |
|--------------------------|------------------------------|
| 1. Lever indicator | 5. Recirculation pump socket |
| 2. Overflow | 6. Main switch |
| 3. Inlet of the beverage | 7. Tap |
| 4. Thermostat | 8. Drip tray |

9.4 Model series CWP 200 Green Line mobilní new, CWP 300 Green Line mobilní new, CWP 300/Kprofi Green Line mobilní new:

- | | |
|--------------------|---------------------------|
| 1. Lever indicator | 6. Fan |
| 2. Overflow | 7. Condenser |
| 3. Dispense tower | 8. Plastic tank |
| 4. Main switch | 9. Motor compressor |
| 5. Thermostat | 10. Inlet of the beverage |
| | 11. CO2 inlet |

10. POURING FLUID INTO THE TANK (see Fig. 10.):

Fill the plastic tank with clean water without any chemical treatment right up the mark MAX.

⚠ WARNING: Before starting, fill the tank with clean water up to the mark MAX. Do not use any chemicals, as this could damage the cooling system. An ecological antifreeze mixture based on propylene glycol can be used for cooling to temperatures below freezing.

⚠ WARNING: Check the connection of the pump outlet, if it is not connected, water will spray from the pump outlet after switching on the device.

⚠ WARNING: After connecting the cooling coil the water level may drop in the plastic tank, so check again and add water if necessary.

11. BEVERAGE SUPPLY CONNECTION AND PRESSURISATION (see Fig. 11.):

11.1 Connection and Pressurisation AS-40 Green Line new, CO2/ N2

- | | |
|---|-----------------------------------|
| 1. Beverage inlet | 7. CO2 pressure reducing valve |
| 2. Beverage outlet | 8. Beverage |
| 3. Keg coupler (A-system, S-system, M-system) | 9. JG SS 9.5 x 8 mm speed fitting |
| 4. F 5/8 x 9.5 mm speed fitting | 10. JG 12.7 x 8 mm speed fitting |
| 5. F 5/8 x 8 mm speed fitting | 11. JG F7/16 x 8 mm speed fitting |
| 6. Y 8 x 8 x 8 mm speed fitting | |

11.2 Connection and Pressurisation AS-80 Green Line new, CO2/ N2

- | | |
|---|---|
| 1. Beverage inlet | 8. CO2 pressure reducing valve |
| 2. Beverage outlet | 9. Beverage |
| 3. Recirculation pump socket | 10. JG SS 9.5 x 8 mm (2x) speed fitting |
| 4. Keg coupler (A-system, S-system, M-system) | 11. JG 12.7 x 8 mm (2x) speed fitting |
| 5. F 5/8 x 9.5 mm speed fitting | 12. JG F7/16 x 8 mm speed fitting |
| 6. F 5/8 x 8 mm speed fitting | |
| 7. Y 8 x 8 x 8 mm speed fitting | |

RECOMMENDATION: Only use quick couplings to connect beverage hoses. For the connection of tubes for the beverage use only fittings and clips specified by the supplier. Use a calibrated hoses.

11.3 Connection and Pressurisation CWP 200 Green Line new, CO2/N2

1. Beverage inlet
2. Beverage outlet
3. Thermostat
4. Keg coupler (A-system, S-system, M-system)
5. F 5/8 x 9.5 mm speed fitting
6. F 5/8 x 8 mm speed fitting
7. Y 8 x 8 x 8 mm speed fitting
8. CO2 pressure reducing valve
9. Beverage
10. JG SS 9.5 x 8 mm speed fitting
11. JG 12.7 x 8 mm speed fitting
12. JG F7/16 x 8 mm speed fitting

 **WARNING:** Check that all joints are sufficiently leak-tight after connection.

ATTENTION: For AS models where a stirrer pump is installed, be sure to connect the pump cable to the socket on the cooler. The pump with stirrer ensures an even temperature in the entire water bath and cools the beverage up to the tap.

12. PUTTING INTO OPERATION:

1. Connect the air line and the beer line.
2. Connect the recirculation coil to the dispense tower.
3. Pour the liquid into the plastic tank.
4. Connect the cooler to the mains.
5. Switch to turn on the cooler.
6. Set the desired temperature on the thermostat - see point 14.
7. Tap the keg, see point 18, tapping the keg.
8. Cooling beverage is now underway. After being cooled, you can dispense the beverage.

 **WARNING:** If a leakage is found, untap the keg according to point 18 and turn off the device. Fix any leaks found on the tubing. If a leak is found inside the device or you are unsure how to proceed, contact a service centre.

 **Max. Inlet beverage temperature 30 °C.**

13. HOW TO WORK WITH SPEED FITTINGS (see Fig. 13.):

13.1 Speed Fitting Installation:

Grasp the speed fitting and insert the hose all the way inside the speed fitting body (ca. 20 mm). The end of the hose must be straight so that it plugs fully into the coupling. If the hose will not go in, moisten the end of the hose.

13.2 Speed Fitting Removal:

Hold the grey ring tight against the body of the speed fitting and pull out the hose.

 **WARNING:** If you do not hold the grey ring but pull at the hose, the speed fitting will cut even deeper into the hose.

 **WARNING:** Hoses must not be pressurised during removal.

14. TEMPERATURE AND ADJUSTMENT (see Fig. 14.):

The temperature of the cooled beverage is controlled by a mechanical thermostat in temperature range of 2 °C to 8 °C. The thermostat has a numerical scale of 1-7.

15. TAP INSTALLATION (see Fig. 15.):

1. Turn the compensator lever (1.), so that it points down (see figure). The compensator lever on the tap is used to adjust the flow rate.
2. Fit the tap perpendicularly onto the spline.
3. Secure with a flare nut and turn left. (loosen to the right).
4. Tighten with the enclosed wrench.

16. CLEANING THE CONDENSER (see Fig. 16.):

1. Remove the four screws holding the lid.
2. Remove the lid.
3. Remove the fan.
4. Clean the condenser with compressed air.

17. KEG COUPLER ASSEMBLY (see Fig. 17.):

17.1 Outlet for Keg Pressurisation:

Variant of connection with the use of a bushing; the hose is fitted onto the bushing and affixed with a clip.

 **WARNING:** Before you screw the speed fitting onto the 5/8" thread, make sure the keg coupler (air inlet for delivery medium) has a lip valve (check valve 17.A) fitted on it.

17.2 Outlet for Beverage:

Screw an F 5/8" x 3/8" (9,5 mm) speed fitting onto the keg coupler.

18. KEG TAPPING AND UNTAPPING (see Fig. 18.):

18.1 Keg Tapping

Procedure for tapping a keg using an S-system keg coupler.

18.2 Keg Untapping

Procedure for untapping a keg using an S-system keg coupler:

18.3 Keg Tapping

Procedure for tapping a keg using an A-system keg coupler:

18.4 Keg Untapping

Procedure for untapping a keg using an A-system keg coupler:

 **WARNING:** Make sure the adapter is clean before tapping the keg!

19. SPARE PARTS:

When ordering spare parts, always provide the following:

- product type
- production year
- product's serial number
- full name of the spare part and its number

Ordering Components

ALWAYS USE ORIGINAL COMPONENTS. The manufacturer or supplier bear no responsibility for non-original components or components not recommended by the manufacturer.

20. SANITATION BY WATER (see Fig. 20.):

(Sanitation Adapter)

Connect the sanitation adapter (not included) to water mains using a hose.

 **WARNING:** Maximum water temperature must not exceed 25 °C.

Sanitation Procedure

Once you have finished a keg, connect the keg coupler to the sanitation adapter the same way as if you were tapping a keg. Once connected, turn the bar tap lever to open position and keep it open until clean water flows out of the tap (all beverage residue and partial sediments flush out). For better sanitation of the cooling device, place cleaning balls into the hose beyond the keg coupler and use pressurised water to clean out the beverage tubing.

 **NOTE:** Sanitation adapter is not included. Can be purchased as an accessory for the cooler.

i NOTE: Remember to dismount the tap and remove the cleaning balls.

21. MAINTENANCE :

Flush the beverage tubing of the cooler after each use with pressurised water (see Sanitation by Water). To make flushing easier, use a sanitation adapter according to your type of keg coupler (sanitation adapter is not included). The cooler must be sanitised once every 14 days by a person with chemical

engineering qualifications. The condenser must be checked for cleanliness every month. Any dirt found must be cleaned with compressed air or wiped off. Otherwise, there is a risk of reduced cooling output or damaging of the cooler.

22. INSPECTION BEFORE EVERY USE:

1. Visual check.
2. Kontrola přívodu kabelu.
3. Zanešení kondenzátoru (v případě nadměrného zanešení čistíme častěji než 1x měsíčně).
4. Kontrola hladiny vody.

⚠ WARNING: Do not use the device if defects or malfunctions are found.

23. PERIODIC CHECKS:

✓ 1x day: check the water level in the tank.

✓ 1x a week: check that the lead-in cable is undamaged and that the plug is firmly in the socket.

✓ 1x a week: check that the device is not exposed to radiant heat.

✓ 1x a week: check that air circulation is not obstructed.

✓ 1x a month: check the cooling unit's condenser and clean it regularly.

✓ 1x a month: check water purity in the device (chiller tank), or change it if necessary.

✓ 1x a year: have an engineering inspector check the electrical safety of the device.

24. ENVIRONMENTAL PROTECTION:

Waste Sorting



This product must not be disposed of in communal waste. Electrical waste in the Czech Republic is disposed of within the Rema System (www.remasystem.cz).

In countries other than the Czech Republic, waste sorting is subject to local regulations.



Sorting waste allows recycling and reusing used products and packaging materials. Reuse of recycled material helps protect the environment from pollution and reduces resource consumption. Local regulations may regulate the method of disposing of household appliances at local collection points or at the point of sale.

25. TABLE OF MALFUNCTIONS:

<i>Malfunction</i>	<i>Cause</i>	<i>Removal</i>
beverage does not flow	keg tapped incorrectly	check that the keg coupler lever is pushed down
		device with built-in compressor - turn on the switch
	water from sanitation froze	turn off the device; then wait until the beverage starts flowing again (may take a few minutes, or hours!)
	compensator is closed	move the compensator lever on the tap
beverage cooled insufficiently	incorrect thermostat setting	turn the thermostat knob to the right towards number 7
	poor air circulation	check the cleanliness of condenser plates
	device overheats	place the device in a colder environment
tap jerks, drink sprays out	pressure too high	reduce delivery medium supply, reduce pressure in the keg
air compressor does not switch on		press the switch on the cooler
air compressor does not switch off	leakage	pull out and reinsert the air hose, tighten the nuts on the keg coupler
beer foams excessively		reduce beverage temperature - turn the thermostat knob to the right
		regulate flow rate by pushing the compensator lever up
speed fittings leaking	hose poorly inserted	pull out the hose, check that the end of the hose is flat (not at an angle), level off with a knife if needed
	scratches on the hose	pull out the hose and shorten by ca. 2 cm

i NOTE: If the defect persists even after the above steps are taken, contact a service centre.

Do not forget to specify the following:

- type of defect
- product type
- production year
- product's serial number (found on the machine plate)

PRODUCT MODEL	COOLING POWER OF THE COMPRESSOR (HP)	COOLING POWER OF THE COMPRESSOR (W)	MAXIMUM COOLING CAPACITY (L/HOUR) TO TK 45°C	CONTINUOUS COOLING PERFORMANCE-CE (L/HOUR)	THERMAL GRADIENT ΔT (°C)	NUMBER OF TAPS (PCS)	TYPE OF REFRIGERANT	VOLTAGE	POWER (W)	AMPERAGE (A)
CWP 100 Green Line new	1/3	860	90	70	10	0	R290	220-240V 50Hz~1	621	2,70
CWP 200 Green Line new	3/4	1550	140	120	10	0	R290	220-240V 50Hz~1	1035	4,50
CWP 300 Green Line new	1	2300	200	180	10	0	R290	220-240V 50Hz~1	960	4,20
CWP 200 Green Line mobilní new	3/4	1550	140	120	10	2	R290	220-240V 50Hz~1	1081	4,50
CWP 300 Green Line mobilní new	1	2300	200	180	10	2	R290	220-240V 50Hz~1	960	4,20
CWP 300/Kprofi Green Line mobilní new	1	2300	200	180	10	2	R290	220-240V 50Hz~1	1080	4,70
AS-40 Green Line new	1/8	310	45	25	10	0	R290	220-240V 50Hz~1	322	1,40
AS-40 Glycol Green Line new	1/8	310	40	25	10	0	R290	220-240V 50Hz~1	437	1,90
AS-80 Green Line new	1/4	630	80	45	10	0	R290	220-240V 50Hz~1	506	2,20
AS-110 Green Line new	1/3	860	110	60	10	0	R290	220-240V 50Hz~1	621	2,70
AS-110 INOX Tropical Green Line new	1/3	860	110	60	10	0	R290	220-240V 50Hz~1	621	2,70
AS-160 Green Line new	3/4	1550	160	110	10	0	R290	220-240V 50Hz~1	874	3,80
AS-200 Green Line new	3/4	2000	200	150	10	0	R290	220-240V 50Hz~1	782	3,40
AS-160 INOX Tropical Green Line new	3/4	1550	160	110	10	0	R290	220-240V 50Hz~1	874	3,80
AS-45 2xkohout Green Line new	1/8	310	45	25	10	2	R290	220-240V 50Hz~1	322	1,40

9.
9.1

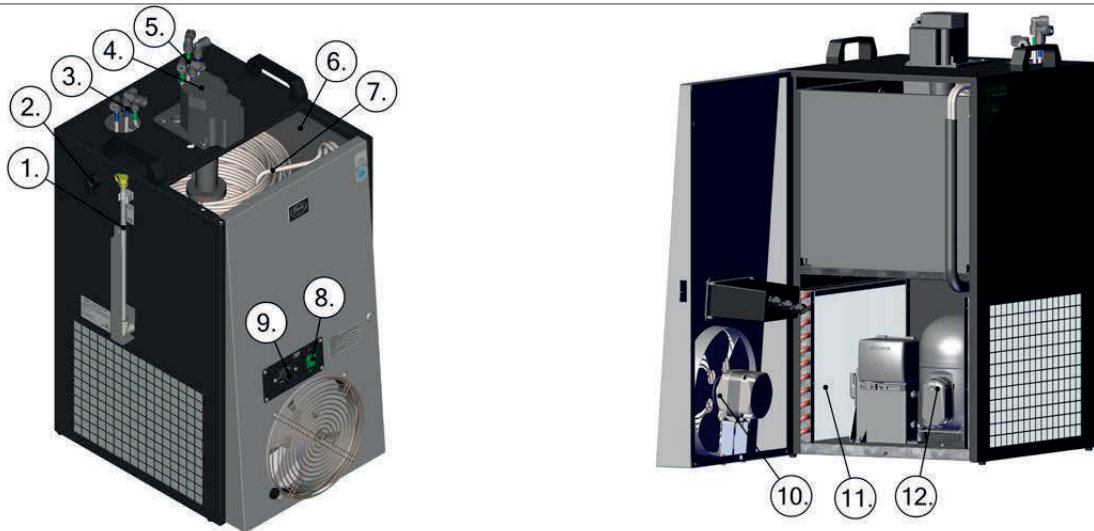

9.2

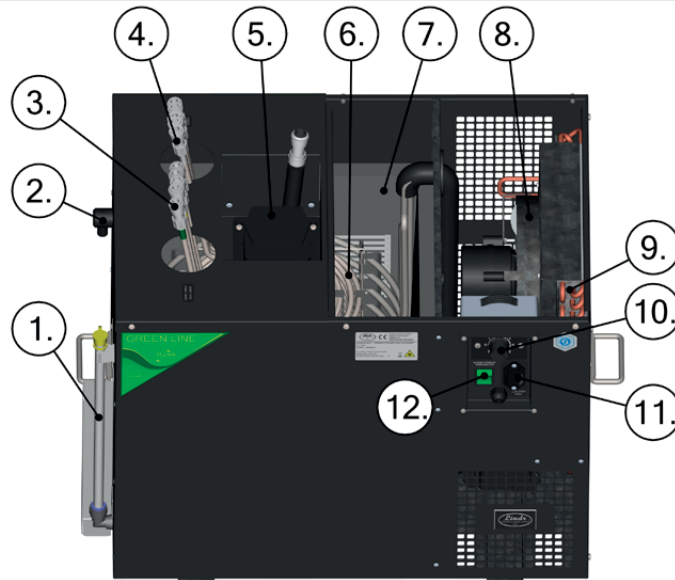

9.3

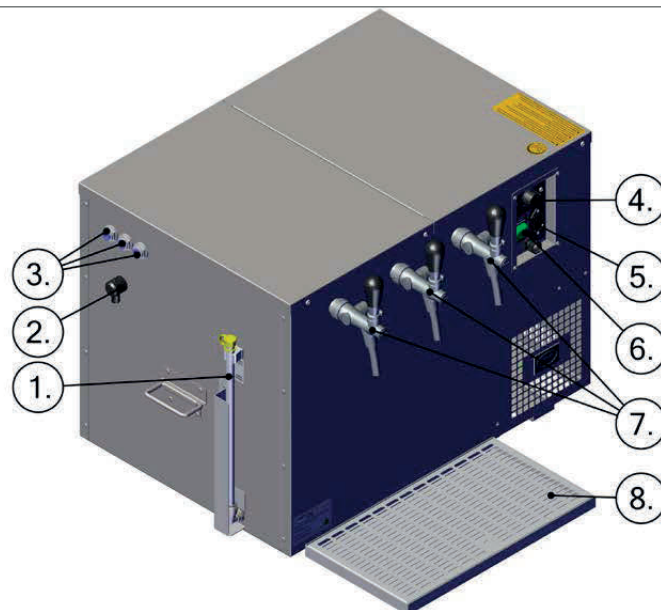

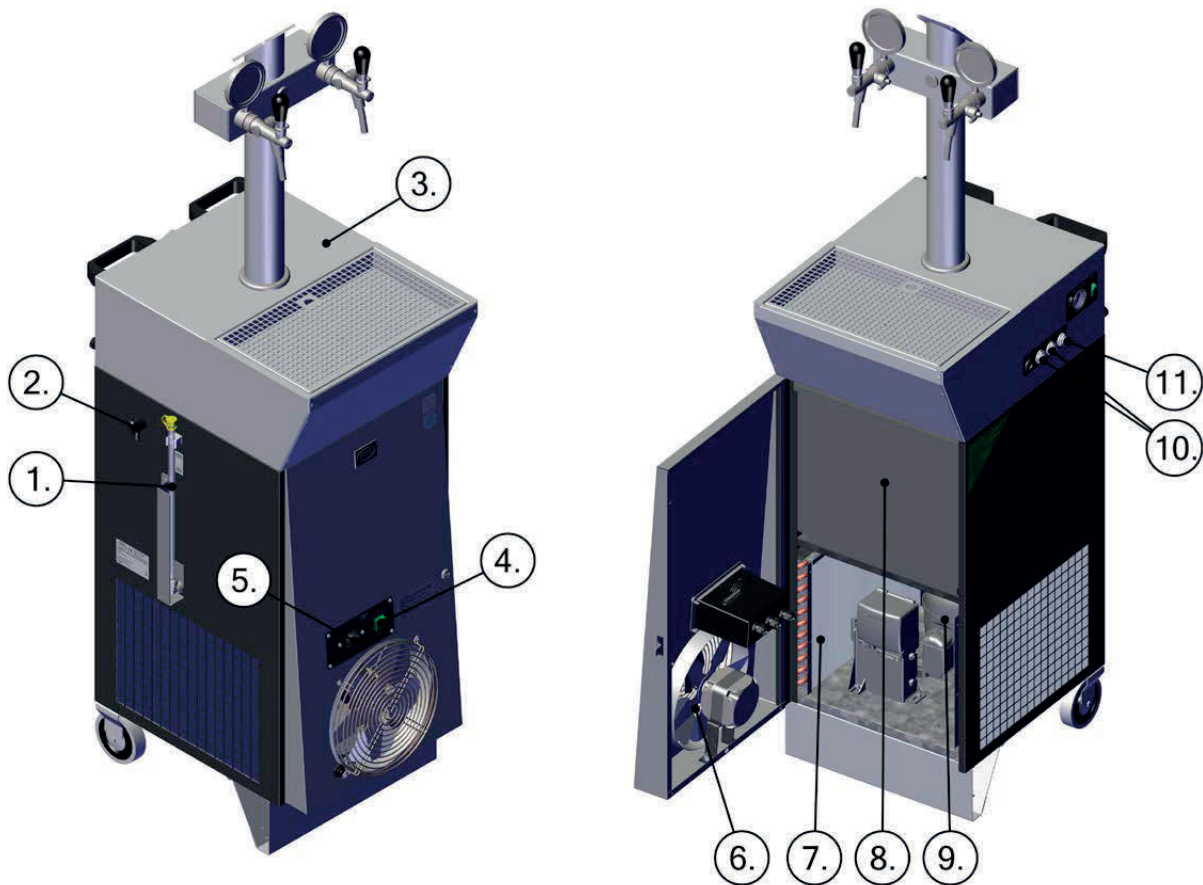

10.

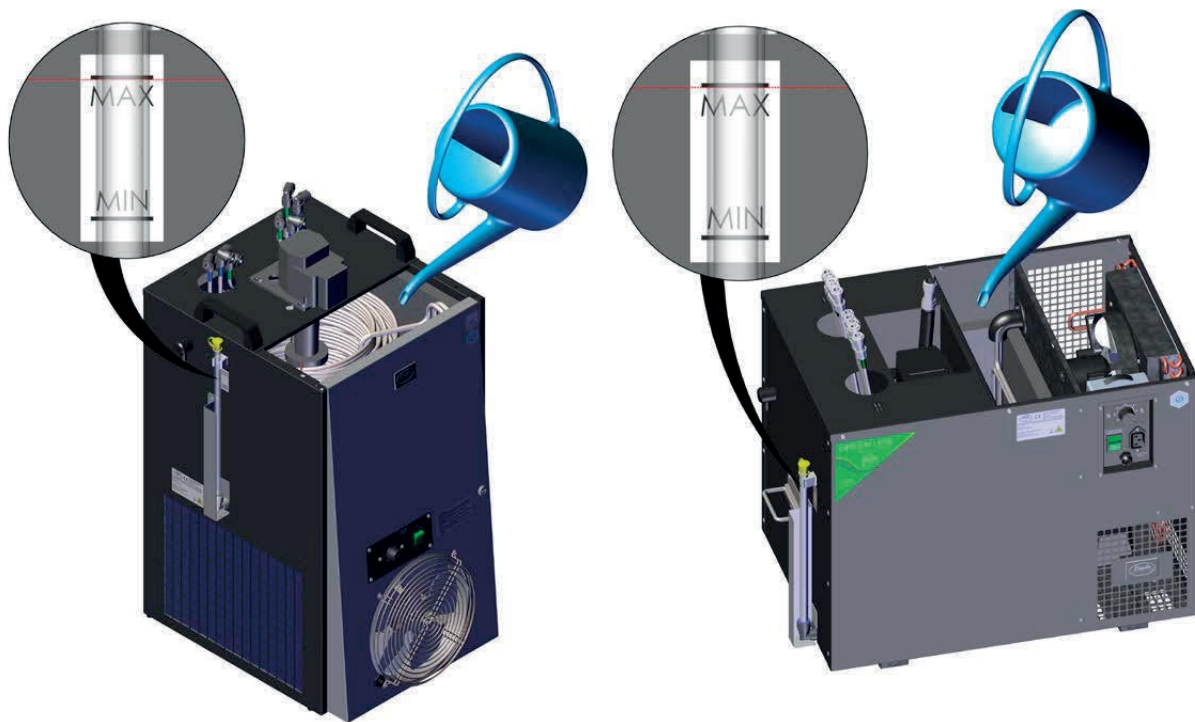

11.
11.1

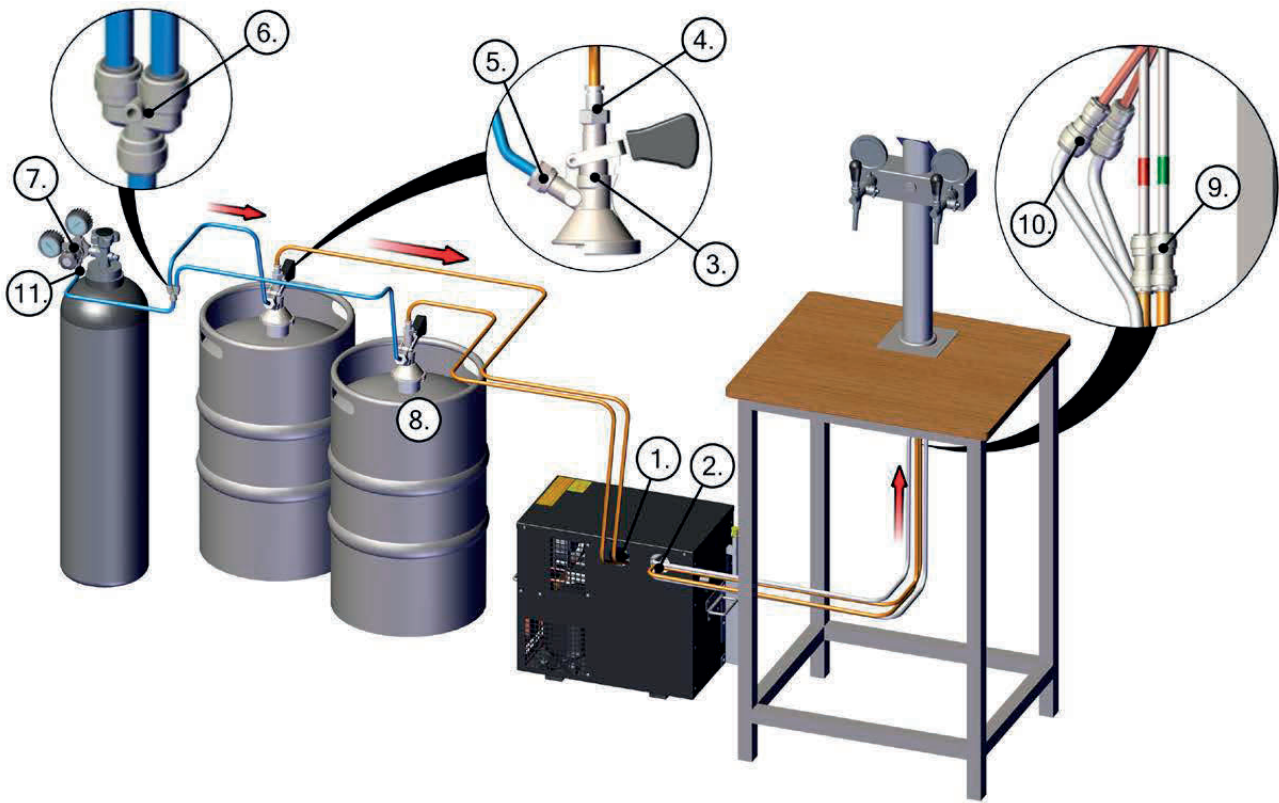

11.2

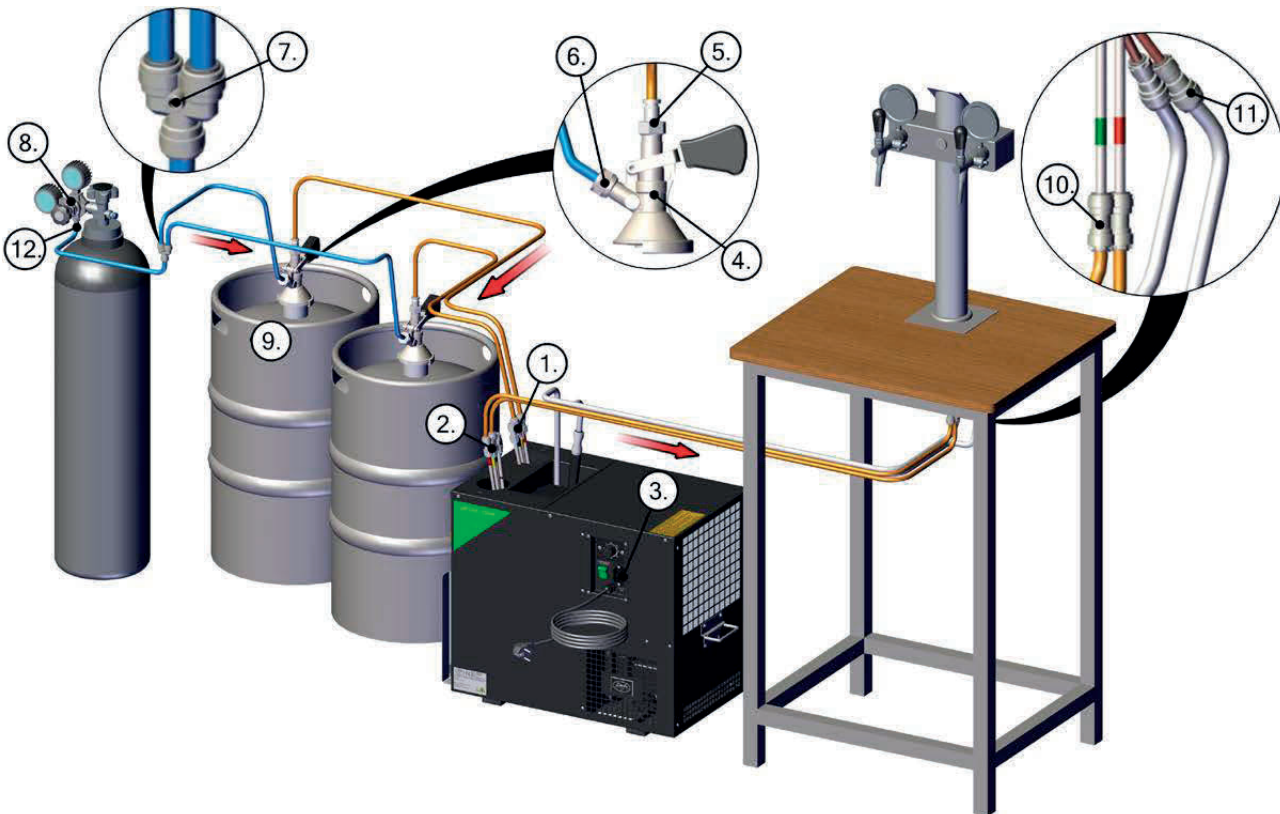

11.3



13.

13.1

13.2

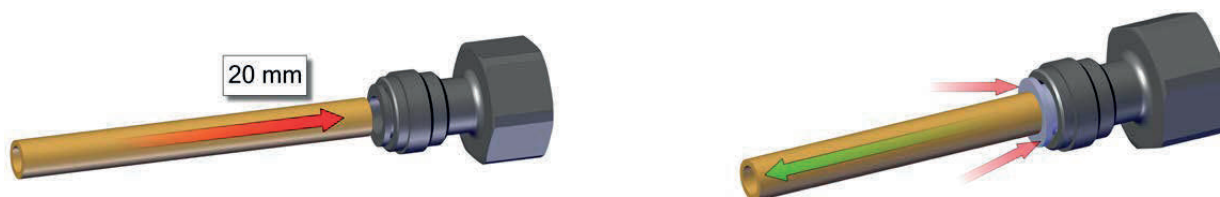

14.



0 = OFF



1 = MAX. 8°C

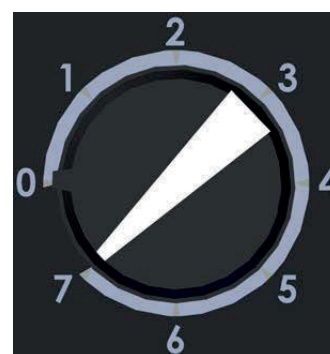

7 = MIN. 2°C

15.

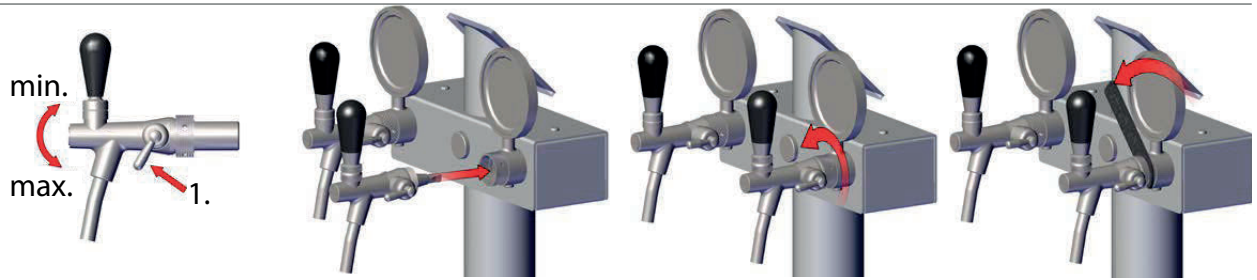

16.

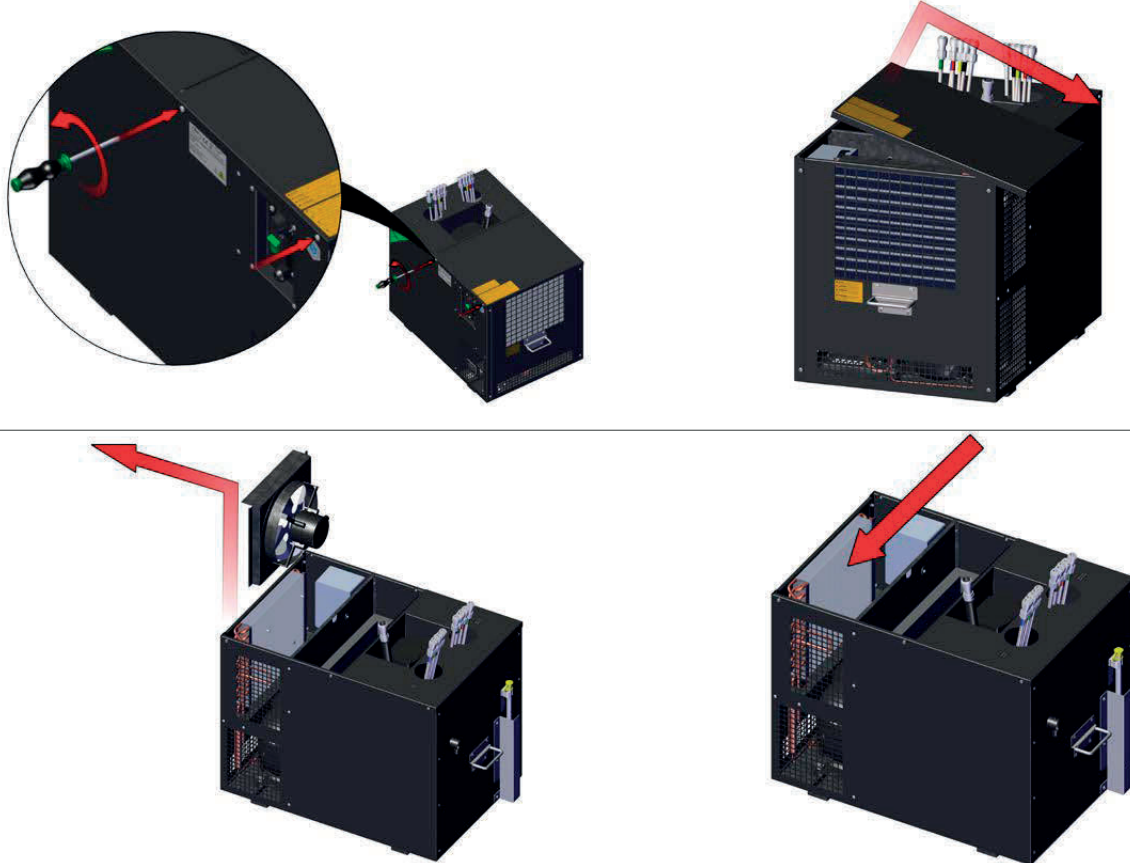

17.

17.1

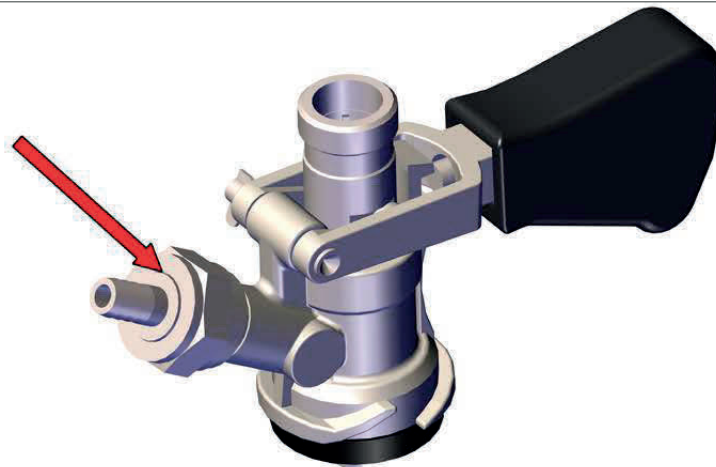

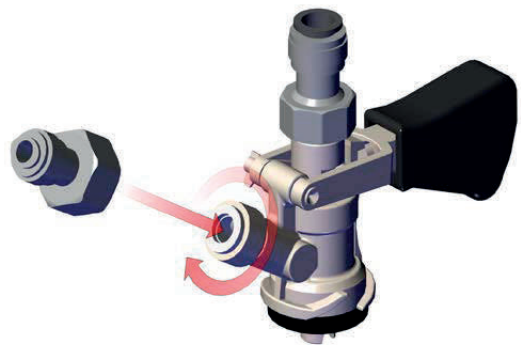
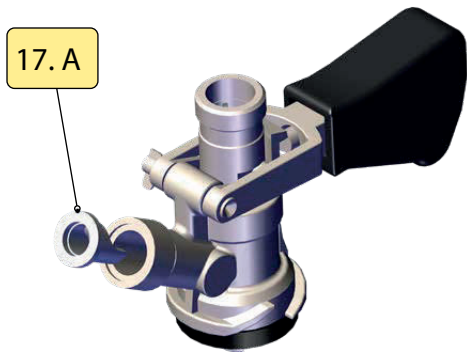
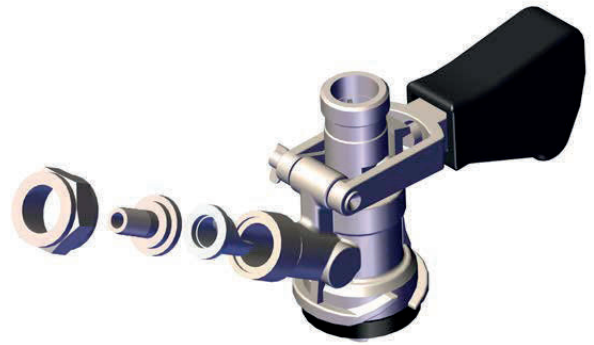
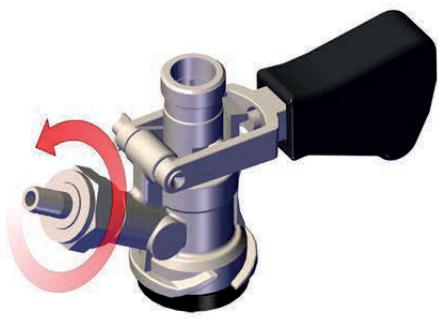

17.2

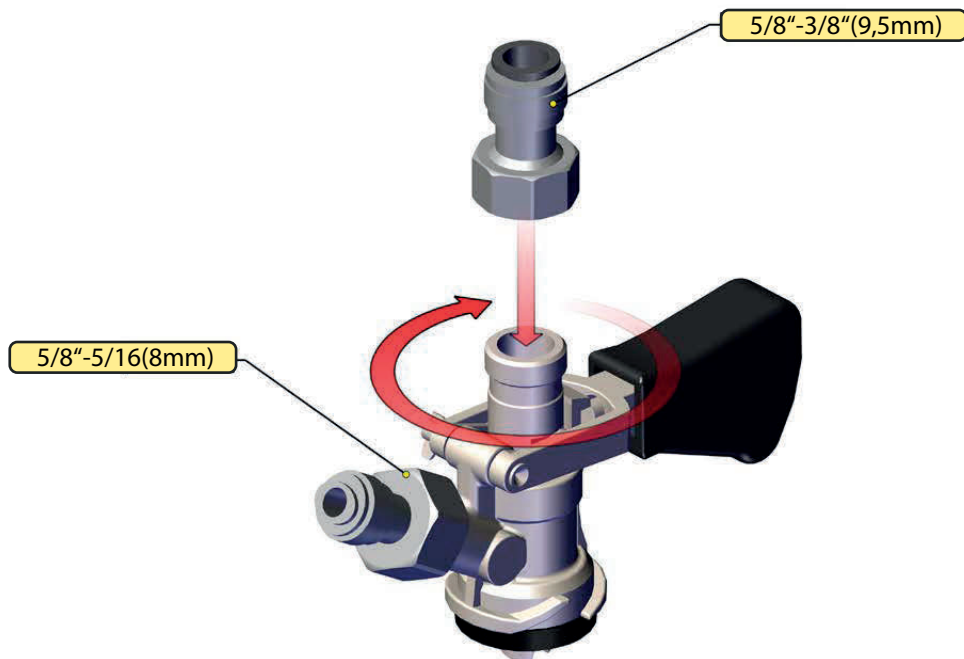

18.

18.1

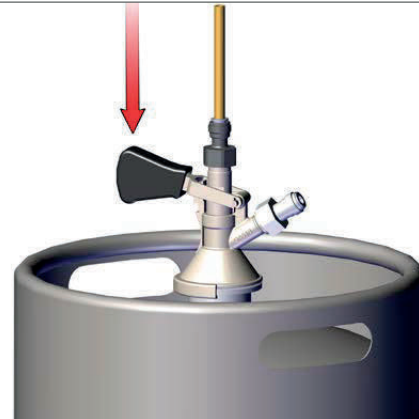
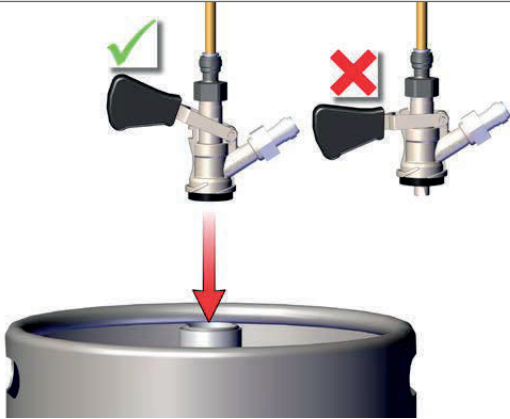
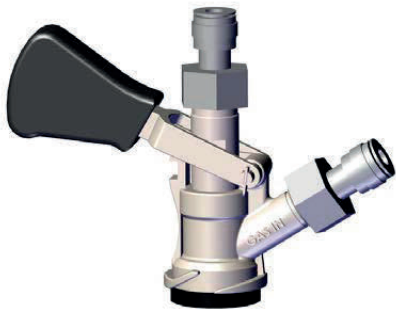

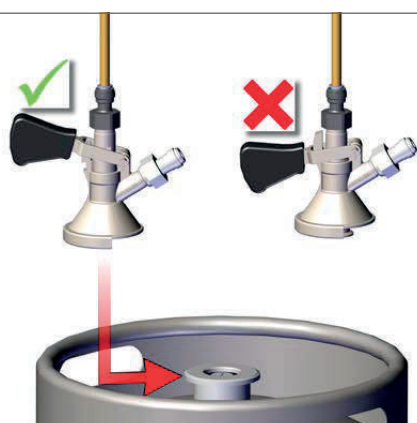
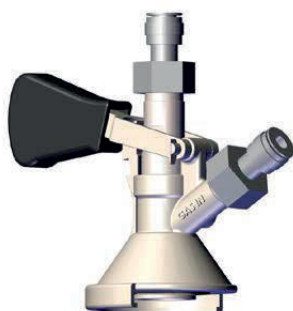
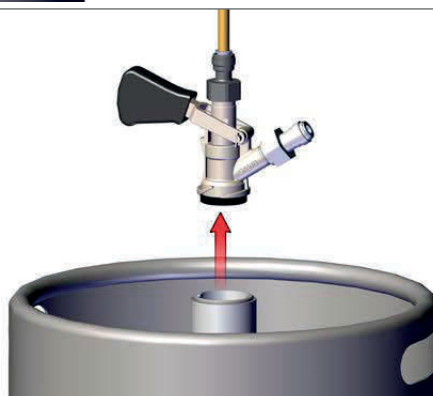

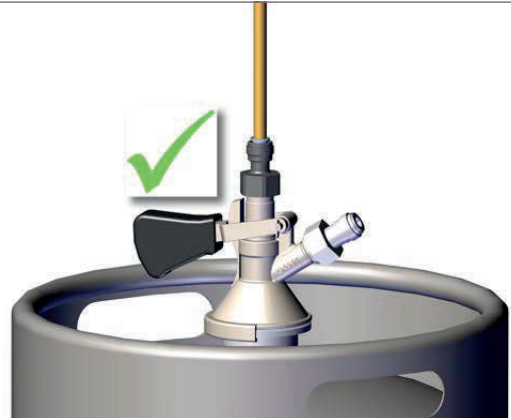
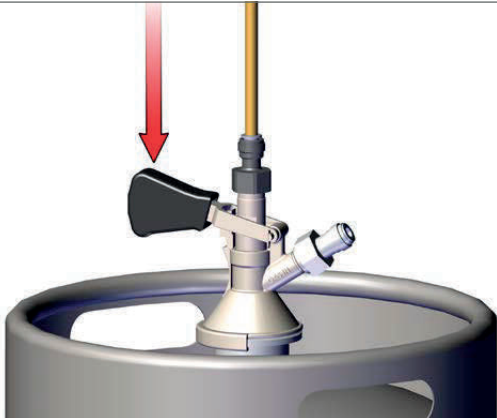

18.4

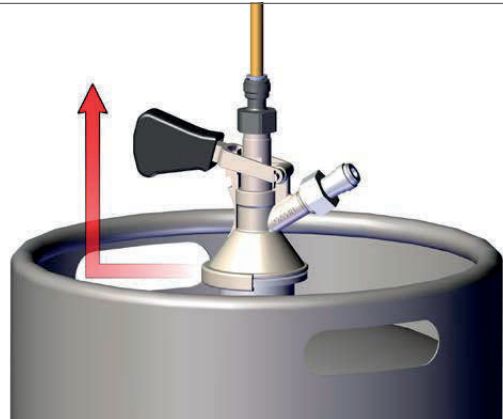
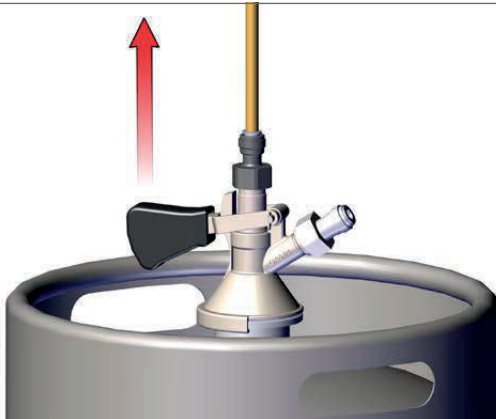

20.

